

Adventure to the world's WILD PLACES

Antarctica, Australia & New Zealand

SMALL SHIP EXPEDITIONS
2025-2026

A Look Inside

About AE Expeditions	02	Discovery Voyages	84
What Makes AE Expeditions Different?	04	Australia: Tasmania	86
Protecting the World's Wild Places	06	Extend Your Adventure	90
Purpose-Built Small Ships	08	Wildlife Encounters	96
Introducing Our Newest Small Ship - <i>Douglas Mawson</i>	10	The <i>Douglas Mawson</i>	98
Our Fleet	12	Deck Plan	98
Enrichment at Sea	14	Staterooms & Suites Layout	99
The Most Comprehensive Activity Program	16	The <i>Sylvia Earle</i>	100
Adventures Through the Lens	22	Deck Plan	100
Give Back and Get Involved in Citizen Science	24	Staterooms & Suites Layout	101
Your Expedition Team	26	The <i>Greg Mortimer</i>	102
Solo Travellers	27	Deck Plan	102
Great for Groups	27	Staterooms & Suites Layout	103
Choose Your Adventure	28	What's Included	104
Expedition Voyages	30	Price List	106
Ross Sea & East Antarctica	32	Terms & Conditions	112
Antarctic Peninsula	42		
South Georgia & Falklands~Malvinas	64		
Patagonia	76		

A photograph of a pod of orca swimming in the ocean. The orca's dark back and dorsal fin are visible above the water's surface. In the background, there are large, rugged mountains with patches of snow under a clear sky. The water is a deep blue color.

Protecting the World's Wild Places

We recognise that by taking passengers to some of the world's most fragile and untouched ecosystems, we have a responsibility to inspire, educate and advocate for the protection and preservation of the places we visit.

A pod of orca, Devil Island, Antarctica © A Włodarczyk

About AE Expeditions

AE Expeditions (part of Aurora Expeditions) was built on the idea that travel can be a powerful tool for positive change. In today's world, we are more focused than ever on making deliberate choices that safeguard our planet.

As a Certified B Corporation™, each step we take is carefully considered, with the preservation of our world at the forefront. This ranges from the support we provide to various Citizen Science, research and conservation projects; to our commitment to climate neutrality; to the thoughtful selection of locally sourced ingredients for every meal we serve. When you decide to join us on our journey, you become part of these initiatives, contributing to the preservation of our planet for generations to come.

We are the adventurous ones. For over three decades, we have been taking people on amazing adventures to the world's most incredible places. We have had the pleasure of sharing the excitement of discovering the world's wild secrets with adventurous travellers like you. Every time we set sail, we are reminded that our planet has so much to offer – new experiences, cool things to learn, but most importantly, we are reminded of why it is crucial to protect all the natural and cultural gems that are part of it.

Founded by legendary Australian adventurer Greg Mortimer and wife, Margaret Mortimer, both passionate and committed environmentalists, we have been pioneering discovery and exploration since 1991.



Our love for respectful exploration drives us to come up with new ways to help you explore. That is why we create ships with top-notch technology, plan immersive itineraries and put together awesome teams that make you feel inspired. We take you to off-the-beaten-path places to give you a real taste of what our world is all about. As you know, when you are exploring, it is not just about what you see, it is also about *how* you see it.

Each experience is accompanied by a team of dynamic Expedition Team leaders and experts, selected for their profound understanding of the destinations and their skill in recognising the opportunities presented by the wilderness that surrounds us.

Our seasoned Expedition Team plays a pivotal role in ensuring that your experience – both on land and on the ship – is extraordinary, infusing each moment with their captivating insights and expertise. And our innovative small ships are purposely designed to connect you with the wild surroundings of your destination, in a more meaningful way.

You might have noticed we do not call it a cruise, but experiential travel. We invite you to join us on a true experience of a lifetime – and travel with a positive impact.



What Makes AE Expeditions Different?

We are a Certified B Corporation™ with a 100% carbon offsets program. At the heart of each experience is a true spirit of adventure, of travelling responsibly to wild, remote and life-changing destinations. The small-ship experience is intimate and friendly. Since 1991, we have pioneered this style of experiential travel, with immersive activities, more time off-ship, thoughtful enrichment programs and an industry-leading Expedition Team-to-traveller ratio of one to seven.



Positive Impact
Travel



Small Purpose-Built
New Ships



More Time
Off-Ship





World-Leading
Activity Program



Education &
Enrichment



Expert Guide
to Traveller 1:7



King penguins at St. Andrews, South Georgia © P Eastway



Protecting the World's Wild Places

Care for Climate

- B Corp™ Certified
- 100% Carbon Neutral
- Emissions reduction strategy
- X-BOW® hull design in all ships
- Shore power connectivity

Leave a Lighter Footprint

- Reduced single-use plastics
- Efficient waste management system
- Water conservation initiatives
 - Virtual anchoring
 - Wildlife protection

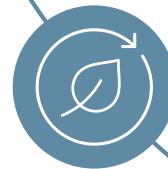

PLANET



Scan to read our inaugural Impact Report 2022-2023



Creating Ambassadors for the Planet

PEOPLE



Educate and Enrich

- 300+ expert explorers, scientists and guides
- Participative Citizen Science
- Women in Conservation program
- Climate change expeditions

Collaborate for Change

- Key Partnerships – AECO, IAATO protecting and preserving the Arctic and Antarctica
- UpSchool – free climate change education
- Ocean Geographic Society – climate change expeditions
- Global Clean Ups: Svalbard, Iceland, Take 3 for the Sea and more
- Mawson's Huts Foundation
- Sustainable food programs

Purpose-Built Small Ships

Our three expedition ships are new to the fleet and are designed for exploration. These state-of-the-art, purpose-built ships use the latest advances in design and technology, truly revolutionising the small-ship experience.

Our ships are ideal base camps for adventure and can explore the farthest reaches of the planet, where few can go. The Ulstein X-BOW® makes sailing smoother and faster, and is built to leave the marine environment undisturbed. Additionally, the design allows for unparalleled up-close encounters with nature.

The *Greg Mortimer* honours our founder, legendary explorer and mountaineer Greg Mortimer OAM. The *Sylvia Earle* is named after leading conservationist, marine biologist and oceanographer Dr Sylvia Earle, who was the first person selected as 'Hero for the planet' by *Time* magazine and is the one of the greatest advocates for protecting the world's oceans. The *Douglas Mawson* is named after Sir Douglas Mawson, a legendary Australian explorer and geologist who was a key expedition leader during the heroic age of Antarctic exploration.

Every stateroom or suite features an ocean view and nearly all include balconies. Our staterooms and suites range in size to suit a variety of priorities. As well as making enriching discoveries and new friends, you also have everything you need to maximise your onboard comfort and relaxation (including heated bathroom floors for travel in the polar regions).

Another impressive feature is each ship's limited capacity, with on average 132–154 passengers, emphasising our dedication to offering exceptional experiences to small groups. And while these brilliantly designed ships could be a destination in themselves, our primary focus remains on showing you the wonders of the outside world through expansive windows, and multiple observation decks and platforms, ensuring a continuous connection to nature, and an array of expedition equipment enabling you to venture out and explore. We want to get you off-ship and into the environment as much as possible.



Greg Mortimer OAM



Sylvia Earle © T Brown

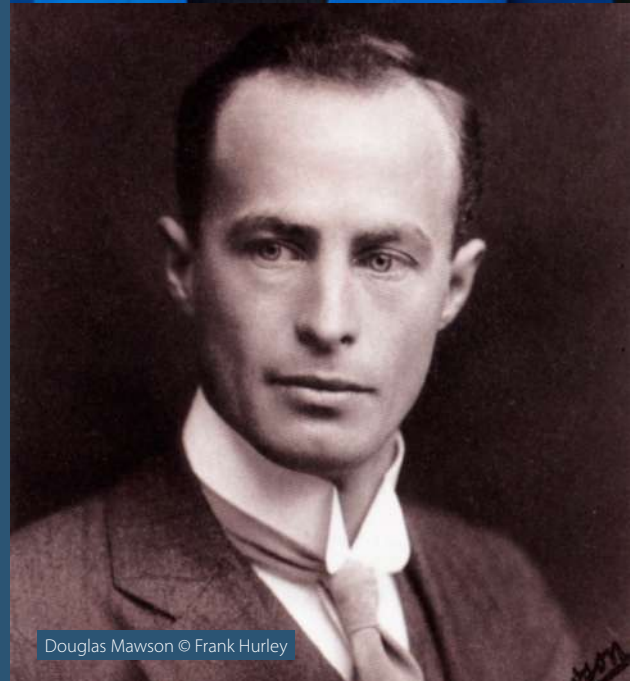

Douglas Mawson © Frank Hurley



The Greg Mortimer in Antarctica © T Mayr



The Sylvia Earle in Antarctica © S Portelli



The Douglas Mawson, artist's render



Swimming Pool, Jacuzzis, Sauna & Gym

Enjoy our heated open-air swimming pool and watch the world go by, or soothe your body at the end of a day of adventuring, in our sauna.



Lecture Theatre, Citizen Science Centre, Library & Lounge

Learn about the world we explore with our onboard naturalists and Expedition Team in our science centre, or enjoy superb views to the front of the ship.



Restaurants & Bars

Make new friends in our two public dining areas, featuring open seating, or have a pre-dinner drink in our three fully stocked bars.



Relaxed Staterooms & Suites

Relax between adventures in one of our comfortable staterooms or suites. With more cabin categories than ever before, including new single cabins, all feature an unrivalled interior design experience.



The Latest Ulstein X-BOW®

Experience the effect of cruising with this unique design that splits wave energy. The result? Faster, more comfortable travel, lower fuel consumption and reduced emissions.

*Pointers are for illustrative purposes only.

All images of the *Douglas Mawson* are artist's impressions only and final results may vary.

Activity Preparation Area

Whether you are diving, climbing, snowshoeing or paddling, our Deck 3, Expedition Team-designed prep area and sea kayak launch platform makes adventure activities even easier.



Changing Room/ Mudroom

Store your outdoor clothing and Muck Boots in your personal locker. Prepare for each landing with easy access to cleaning stations.

Zodiac Access Points

Four access points make loading and unloading our fleet of Zodiacs a breeze and are easily accessed from the mudroom and activity preparation areas on Deck 3.

Introducing Our Newest Small Ship - *Douglas Mawson*

Joining our family of pioneering small ships is our third purpose-built small expedition ship – *Douglas Mawson*.

Designed for global discovery and purpose-built for off-ship adventures, this cutting-edge ship is the latest in its Infinity Class, joining AE Expeditions' two sister ships, *Greg Mortimer* and *Sylvia Earle*, also named after pioneers in their fields.

Douglas Mawson can carry on average 154 passengers, and features the latest and greatest revolutionary Ulstein X-BOW®, designed for smoother and faster ocean crossings and world-leading fuel efficiency.

The stylish and comfortable staterooms and suites available across the ship's 11 cabin categories – with most including private balconies – include unrivalled interior design features, and for the first time, several single-berth cabins are available to solo travellers.

Public spaces include two restaurants, three bars, an outdoor heated swimming pool, two Jacuzzis, a gym and sauna, relaxation and wellness areas, a library lounge, a Citizen Science Centre and lecture theatre, and expansive observation decks offering panoramic views of wilderness and wildlife.

Douglas Mawson is designed to be an ultra-comfortable base camp for adventure, with Zodiac access points, a changing room and mudroom for passengers to prepare for off-ship and onshore activities. A dedicated science centre is the hub for a variety of participative and educational Citizen Science programs.



Douglas Mawson © Frank Hurley

Sir Douglas Mawson was a legendary Australian explorer and geologist whose name is synonymous with exploration and discovery. Mawson was a key expedition leader during the heroic age of Antarctic exploration.

We take great inspiration from the incredible legacy of Sir Douglas Mawson. Indeed, it was Mawson's *SY Aurora* vessel that inspired our founder, Greg Mortimer, to name our company AE Expeditions (part of Aurora Expeditions). Like its namesake, *Douglas Mawson* will be a ship on the forefront of global ocean discovery.

Our Fleet

A Comparison Guide



Greg Mortimer

Capacity:	On average 132 passengers
Features:	Ulstein X-BOW® hull, Safe Return to Port technology, dynamic positioning, and Zero Speed™ Stabilizers.
Expedition Team:	13 to 23^
Cabins:	79
Aurora Stateroom Single:	0
Aurora Stateroom Superior Single:	0
Aurora Stateroom Superior:	0
Aurora Stateroom Twin:	6
Aurora Stateroom Triple:	8
Balcony Stateroom:	55
Balcony Stateroom Superior:	5
Junior Suite:	4
Captain Suite:	1
Connecting Stateroom:	46
Decks:	8
State-of-the-Art-Lecture Theatre:	✓
Science Centre:	—
Library:	✓
Wellness Centre:	✓
Gym:	✓
Sauna:	✓
Jacuzzi:	2
Pool:	—
Starlink Wi-Fi – Free:	✓
Destinations:	Antarctica, Arctic & Global
Year Built:	2019
Chart Class:	A1 Ice Class
Length:	104.4 m
Breadth:	18.4 m
Draught:	5.1 m
Average Speed:	10–12 Knots
Full Speed:	"15.5 Knots – maximum speed only used in case of emergencies"
Tonnage:	GT 7400
Registry:	Portugal
Voltage:	220V 60Hz AC. universal plug



Sylvia Earle

On average 132 passengers

Ulstein X-BOW® hull, Safe Return to Port technology, dynamic positioning, and Zero Speed™ Stabilizers.

13 to 23^

70

0

0

3

0

2

55

5

4

1

38

8

✓

✓

✓

✓

✓

✓

2

✓

✓

Antarctica, Arctic & Global

2022

A1 Ice Class

104.4 m

18.4 m

5.1 m

10–12 Knots

"15.5 Knots – maximum speed only used in case of emergencies"

GT 7400

Nassau, BS

220V 60Hz AC. universal plug



Douglas Mawson

On average 154 passengers

Ulstein X-BOW® hull, Safe Return to Port technology, dynamic positioning, and Zero Speed™ Stabilizers.

13 to 23^

86

2

4

8

2

2

58

5

4

1

48

8

✓

✓

✓

—

✓

✓

2

✓

✓

Antarctica, Arctic & Global

2025

A1 Ice Class

104.4 m

18.4 m

5.1 m

10–12 Knots

"15.5 Knots – maximum speed only used in case of emergencies"

GT 8500

Portugal

220V 60Hz AC. universal plug



Sauna Greg Mortimer



Science Centre, Sylvia Earle © R l'Anson



Enjoying the Jacuzzi, Greg Mortimer © M Go





Enrichment at Sea

The spirit of AE Expeditions is about shared experiences, enrichment and making new friends.

We have an intimate and relaxed atmosphere on board. Each ship will provide you with the most comfortable base camp for making enriching discoveries both on- and off-ship.

Immersed within each ship's interiors is a carefully curated photographic gallery that narrates the stories of the destinations we visit. As you stroll through the corridors and shared spaces, you will discover an array of artworks showcasing the breathtaking locations captured by expeditioners and photography experts.

VIEW the incredible landscapes and wildlife through floor-to-ceiling windows that face every direction. Find a spot on the vast outside decks, or the dedicated observation areas, which include our unique viewing platforms that extend out either side of the ship, so you can get close to the real show outside.

FEEL AT HOME in the comfort of your spacious and well-appointed stateroom or suite. All have ocean views, most include balconies, and all include private bathrooms with heated floors, which are a stand-out for travel in the polar regions.

JOIN the early risers for pastries, coffee and tea in the lecture theatre.

DINE and swap stories with new friends in our informal restaurants, or have a coffee, tea, or drink at the bar.

ENJOY welcome drinks with the Captain and Expedition Team.

INDULGE IN WELLNESS spaces – Wellness Centre, gym, sauna, and Jacuzzis.

STAY HYDRATED with our complimentary reusable water bottles (on request) and water refilling stations throughout the ship.

ENJOY ACCESS to the knowledge and enriching presentations by our highly experienced Expedition Team of naturalists, photographers, cultural experts and more.

RELAX and unwind in the comfort of our well-stocked library.

GET READY for adventure in our mudroom and our unique activity prep area, with individual lockers for all your complimentary expedition gear and equipment.

STAY CONNECTED with Starlink Wi-Fi – complimentary access.



Dining Room, *Sylvia Earle* © R l'Anson

The Most Comprehensive Activity Program

Activities That Put You in the Action

The real adventure happens off-ship. Our expeditions are all about more opportunities for you to get off-ship to explore and connect with the remarkable destinations we go to.

We have the most comprehensive activity program, supported by the most experienced Expedition Team on hand, dedicated to making each experience action-packed and immersive in the natural environment.

Some activities are included in your expedition, while others are optional and cost extra. Some activities need to be booked in advance.

There are activity options for everyone, regardless of experience or skill level. And there is always the opportunity to try something new. How you experience the destination is entirely up to you.

**All our landings, adventures and activities are subject to weather conditions, and activity options do vary by itinerary.*



Scan the QR code to view the activities

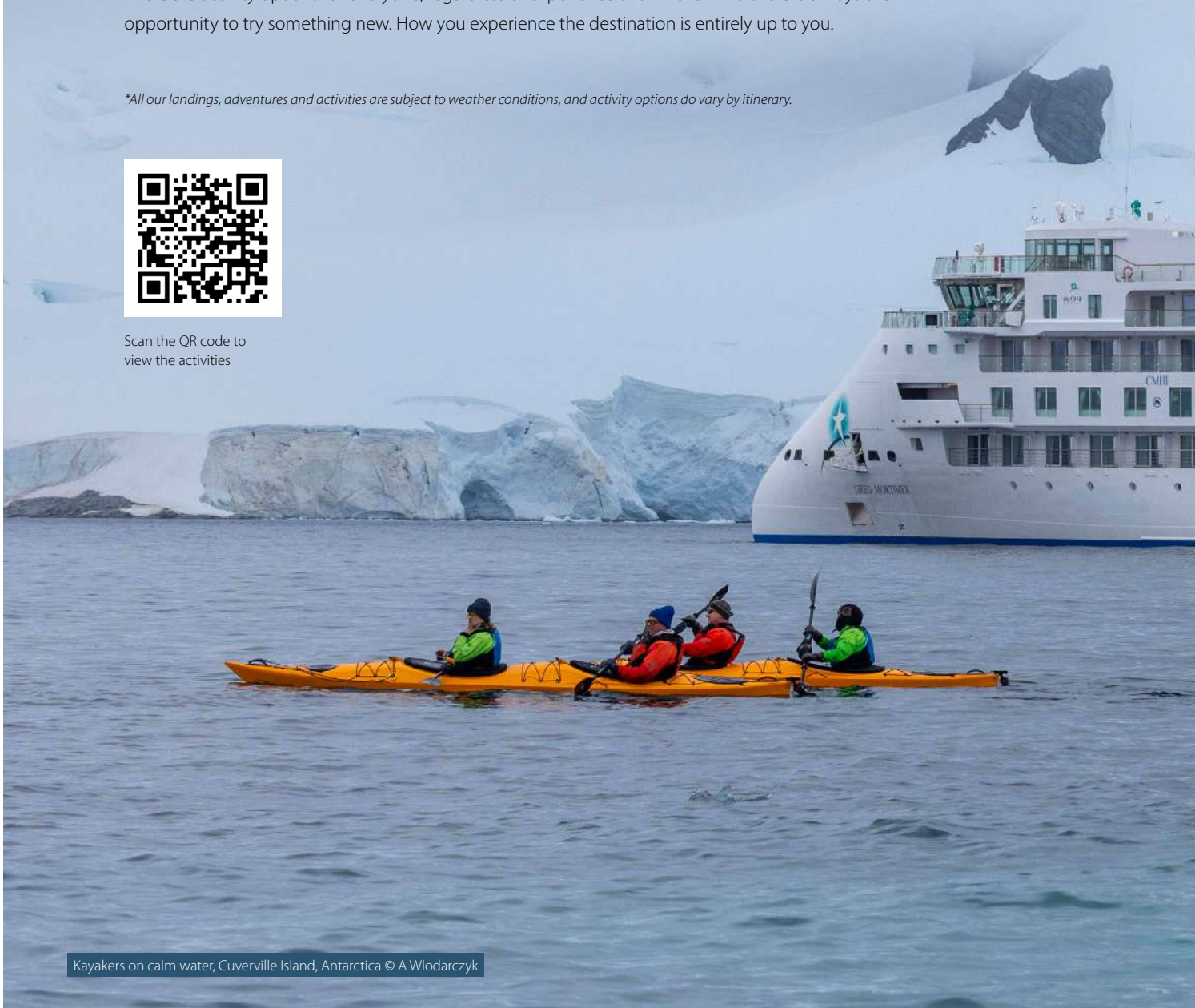

Kayakers on calm water, Cuverville Island, Antarctica © A Włodarczyk



Included Activities

Our expeditions are designed to put you in the action as much as possible. To maximise your time in the incredible destinations we visit, we offer a range of included activities as part of your voyage.



Zodiac Cruises



Guided Hikes



Photography



Polar Plunge



Optional Activities

Your expedition can be as active as you want. We have the most comprehensive activity program and offer an unrivalled array of activities so you can reach new limits and live out your wildest dreams.

Choose from a large selection of optional activities led by our professional and passionate Expedition Team.



Sea Kayaking



Scuba Diving



Paddling



Key:

-  Easy to moderate activity, some experience is beneficial
-  Moderate activity, some experience required
-  Challenging activity, extensive experience is necessary

**All activities are subject to appropriate weather and sea conditions.*



Snorkelling



Ski & Snowboard Touring



Alpine Trekking & Climbing



Shackleton's Crossing



Camping



Snowshoeing



**All activities are subject to appropriate weather and sea conditions.*



Get More Immersed in Antarctica

– with our Antarctica Active (All Inclusive Activities) Itinerary

Each day will bring new discoveries, with the flexibility for you to also enjoy all-inclusive paddling, camping, snowshoeing and snorkelling alongside our highly skilled Expedition Team, as part of your expedition experience. Visit pages 54-55 for more information.

Please note that for safety and operational reasons, participation in activities is dependent on participants meeting specific inclusion criteria, and the slots available for each activity. All activities are subject to weather, ice and other conditions.



Kayaking in Antarctica © T Mayr



Taking a photo from a cabin balcony, Jougla Point, Antarctica © D Stock, Divergent Travelers



Adventures Through the Lens

Bring your expedition stories to life with the best photos you will ever take.

We have award-winning professional photographers on board every voyage, to inspire, guide and assist you. Every passenger, from smartphone user to semi-professional shooter, can benefit from our experts' deep professional knowledge – picking up tips, learning new skills and taking some awe-inspiring photos.

Every minute of every destination we explore provides extraordinary photo opportunities, so there will be so many incredible moments to capture and so much you will want to shoot!

As our photographers love to share their skills with photo enthusiasts of all levels and also offer informative onboard presentations and supportive tips, you will be taking snaps of extraordinary moments in no time.

Happy shooting!

"The sense of adventure and exploration inspires me to capture the essence of some of the most amazing places on the planet. Every day is a new experience, a visual feast for all the senses. It allows me to explore my creativity and passion for photography and interpret the world in completely different ways."

— **Scott Portelli**, Australian multi-award-winning wildlife photographer and member of the Australian Institute of Professional Photography (AIPP)

"What I love about expedition photography is that it allows me to combine my pursuit of images with a fantastic travel experience to many of the most remote, beautiful and challenging environments on the planet. The continually changing land, sky and seascapes seen from the ship, and the close-up encounters with icebergs and wildlife afforded by Zodiac cruises and beach landings, present endless opportunities for capturing a diverse range of great images."

I also love that I don't have to pack my bags to move on to the next destination; the ship takes care of that."

— **Richard l'Anson**, award-winning Canon Master, World Nomads Mentor, and Australian Himalayan Foundation Ambassador

"What I love most about travelling with AE Expeditions is that the group isn't too big and you get to meet everyone – it's like a big family and everyone is buzzing because of where they are. For a photographer, a ship is the best shooting platform ever. You go to sleep and wake up in a new location, and you can shoot from the ship, from a Zodiac or from shore. There's so much variety and it's always changing."

— **Peter Eastway**, editor of *Better Photography* for over 40 years and twice winner of the Australian Professional Photographer of the Year

Give Back and Get Involved in Citizen Science

"Our goal is literally to inspire a network of hope – one place, one community, one vision at a time – but together around the world."

— **Dr Sylvia Earle**, oceanographer, marine biologist and explorer.

You can make a difference because your participation enables us to provide invaluable data to the scientific community. You too can become an ambassador for the protection of our majestic but fragile blue planet, by sharing what you have learned when you return home.

Travel is always the best educator and we offer you the chance to enrich your curiosity and expand your knowledge and understanding of the places we travel to. There is no better learning opportunity than being in the field with subject-matter experts.

Our Citizen Science Program will allow you to deepen your connection to the natural world in a relaxed, informal and fun environment – on board our ships, on our fascinating shore expeditions and in our Zodiacs.

Our eight diverse Citizen Science projects have been hand-picked for their groundbreaking work and global achievements:

- Happywhale
- Seabird surveys
- Microplastic survey
- NASA Globe – Cloud Observations
- Secchi disk
- Fjord Phyto
- iNaturalist
- Eyesea

From the biggest mammals to the smallest marine creatures, the important part you play in our Citizen Science projects will help protect and preserve the planet for generations to come.

**Citizen Science projects are location and weather dependent and not all projects are able to be operated on every voyage.*





Citizen Science Secchi Disk program, Antarctica @ J Lafferty



Searching for microplastics, Antarctica © M Bassano



Surveying birds, Antarctica © M Bassano

Your Expedition Team

Out Here, Experience Matters

Embark on the adventure of a lifetime with AE Expeditions, where you will travel alongside the most dedicated, experienced, passionate and skilled Expedition Team in the industry.

With over 100 years of combined experience, our team's knowledge of the destinations we visit is unparalleled, as they encourage you to push your boundaries and explore some of the most breathtaking locations on the planet.

Learn from some of the greatest minds and most passionate specialists – naturalists, marine biologists, geologists, historians, ecologists, glaciologists, ornithologists, climatologists and many more...

With our small-group approach to big adventures, we offer an industry-leading ratio of Expedition Team to passengers (one to seven), and safety is always our top priority. Let us help you make unforgettable memories and get the most out of your expedition with us.



Scan the QR code to meet the team



The Expedition Team © A Włodarczyk



Solo traveller watching the sunset, Antarctica © T Mayr

Solo Travellers

Expedition cruising is such a fantastic choice for solo travellers, giving them the chance to experience the world's most remote and incredible destinations with like-minded travellers and our expert guides, while on board our small, social and welcoming ships.

Our landings and activities are all conducted in small groups. You will be able to explore at your own pace, pushing your limits with adventure. You will be surrounded by fellow expeditioners with a shared spirit of adventure, having an amazing experience, making new friends – and the memories are yours to keep.

AE Expeditions has some great options for solo travellers. If you would like to share accommodation with another expeditioner of the same gender, we will be happy to try to make it happen for you.



Kayaking at Cuverville Island, Antarctica © A Włodarczyk

Great for Groups

Expeditions are made for great adventures for groups. Our ships play host to many groups of varying sizes and include photographers, birders and wildlife enthusiasts.

Our unique style of expeditions and our highly experienced onboard teams make for great group adventures.

Whether you are a travel agent seeking to take a group directly, or a professional photographer or special interest expert promoting a group to your own network of contacts, we have the itineraries and activities to suit.

Choose Your Adventure

Whether you are in pursuit of otherworldly beauty, wildlife rich waters, breathtaking icy panoramas or cultural immersion, we provide a range of experiences tailored to offer a unique perspective in the most captivating parts of the world. There is always more to discover and our intimately scaled purpose-built ships with cutting-edge technology and all the comforts you need, are the best way to explore.

Experiences

Expedition

Embarking on an expedition is the epitome of pure adventure. At AE Expeditions, we prioritise the experience over the itinerary. Our purpose-built small ships, as well as Zodiacs and immersive activities, guide you to the uncharted territories that only few have had the privilege to explore.

Discovery

Embarking on a discovery voyage brings you closer to the heart of nature, with an abundance of diverse excursions, hikes tailored to different levels and a range of activities that encapsulate the authentic spirit of adventure, history, and cultural immersion. At times, we venture off the beaten path, while on other occasions, we strike a balance between less and more populated areas, ensuring a well-rounded experience.

Trekking

Embarking on one of our treks guarantees an elevated adventure experience. Combine an expedition or discovery voyage with a trek, enhancing your immersion in the destination's nature and culture while providing even more opportunities to enjoy the local sights, sounds and delights.





Zodiac-cruising and kayaking at Neko Harbour, Antarctica © A Włodarczyk

Expedition Voyages

Embarking on an expedition is the epitome of pure adventure. At AE Expeditions, we prioritise the experience over the itinerary. Our purpose-built small ships, as well as Zodiacs and immersive activities, guide you to uncharted territories that only few have had the privilege to explore.





Ross Sea & East Antarctica

From Australia & New Zealand

Explore the region that boasts the world's largest floating body of ice (the spectacular Ross Ice Shelf) and the largest Adélie penguin colony. Follow in the wake of legendary adventurers, to discover historical huts and hear extraordinary tales of endurance as you relive the heroic age of exploration.



A small group of emperor penguins near a crack in the sea ice, Ross Sea, Antarctica



A close-up shot of the Ross Ice Shelf, Antarctica



Emperor penguins diving off an ice floe



Mawson's Huts, Antarctica © Mawson's Huts Foundation

This map is a guide only and is subject to change due to permitting and regulatory approvals; and weather, sea state and other conditions beyond our control.

Mawson's Antarctica

Antarctica & Subantarctic Islands | 24 Days

Retrace the historic voyage of Sir Douglas Mawson's Australasian Antarctic Expedition (AAE) and experience the grandeur of remote East Antarctica. Cross the Antarctic Circle towards Commonwealth Bay and the fabled Cape Denison. Conditions permitting, make landfall to explore what remains of Mawson's main base, and find yourself transported back to the heroic age of Antarctic exploration. Keep watch for porpoising Adélie and emperor penguins, orcas patrolling for prey, and snow petrels soaring against the backdrop of the vast ice sheet.

HIGHLIGHTS

- Navigate through gleaming pack ice alive with Weddell and leopard seals and Adélie and emperor penguins
- Discover historic Commonwealth Bay as we attempt to make a rare and much-coveted landing at Cape Denison, the site of Mawson's Huts (ice and weather permitting)
- Skirt rowdy beaches crowded with harems of New Zealand Hooker's sea lions to reach gnarled rātā forests, where rare yellow-eyed penguins can be found

DATES

Start/Finish	Duration	Dates	Voyage Code	Type of Voyage
Hobart/Dunedin 	24 Days	11 Dec '25–03 Jan '26	MAW009D	Sail

Voyage Codes: G = Greg Mortimer | S = Sylvia Earle | D = Douglas Mawson

[You can view the full itinerary on our website.](#) In the genuine spirit of expedition travel, this itinerary is only a guide and is subject to change due to additional permitting, weather, sea and other conditions beyond our control.

DAY OVERVIEW

1	Arrive in Hobart and transfer to your hotel.
2	Embark in Hobart.
3–5	At sea.
6–7	Macquarie Island is a remote subantarctic wonder teeming with unique wildlife and rugged landscapes. It is renowned as one of the most important seabird breeding sites in the world, with vast colonies of penguins, albatrosses, petrels, and other species congregating on its rocky shores. (Visit subject to permits.)
8–10	At sea.
11–13	When Captain John King Davis skilfully steered the <i>Aurora</i> through heavy pack ice in 1912, the Australasian Antarctic Expedition became the first to chart this stretch of coastline. As you sail into these waters over a century later, you are entering one of the most inaccessible and seldom-visited parts of Antarctica.
14–15	For many expeditioners, approaching Commonwealth Bay, where Mawson and his men established their main base, evokes a profound sense of awe and humility.
16–19	At sea.
20–22	As we explore the New Zealand subantarctic islands, you will be witness to an ecosystem populated by unique endemic species such as the yellow-eyed penguin and Campbell mollymawk.
23	At sea.
24	Disembark in Dunedin.

ACTIVITIES



Zodiac Cruises



Walks & Hikes



Photography



Expert Lectures



Polar Plunge



Birdwatching



Historical Sites



Citizen Science



Sea Kayaking

*Optional activities available on select voyages, at additional cost. ^Only available on the Antarctic portion of the itinerary, as time and conditions allow.



The Ross Ice Shelf



This map is a guide only and is subject to change due to permitting and regulatory approvals; and weather, sea state and other conditions beyond our control.

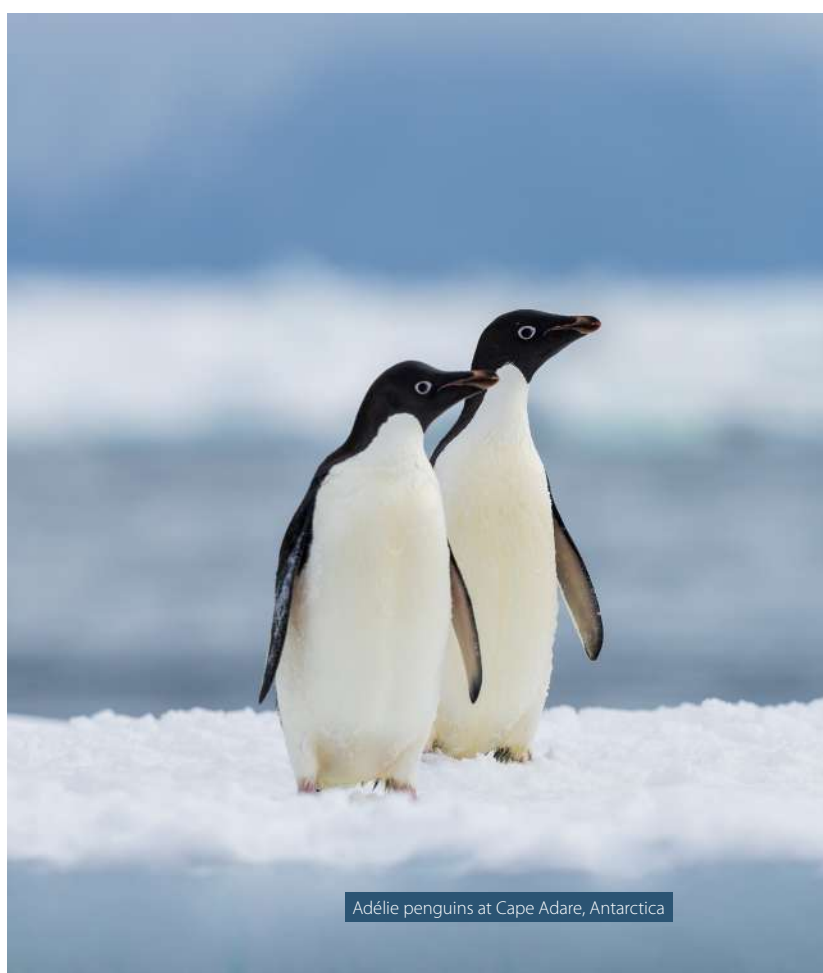

Adélie penguins at Cape Adare, Antarctica

Ross Sea Odyssey

Antarctica & Subantarctic Islands | 25 Days

Step back into the heroic age of Antarctic exploration to discover a wildlife wonderland. As you journey south, spot yellow-eyed penguins and royal albatross on New Zealand's Auckland and Campbell Islands. Crossing the Antarctic Convergence, enter pack ice alive with orcas, seals and emperor penguins. Our expedition days within the Ross Sea offer icy drama, rich wildlife experiences and extraordinary stories of human exploration and survival.

HIGHLIGHTS

- Explore the world's largest body of floating ice, the Ross Ice Shelf, rising 30 metres from freezing waters patrolled by pods of orca
- Witness Campbell Island's southern royal albatross ballet
- Stand quietly in huts little-changed since Scott, Shackleton, Mawson and the heroic age of Antarctic exploration (ice and weather permitting)

DATES

Start/Finish	Duration	Dates	Voyage Code	Type of Voyage
Dunedin/Dunedin	25 Days	16 Jan '26–09 Feb '26	ROS001D	Sail

Voyage Codes: G = Greg Mortimer | S = Sylvia Earle | D = Douglas Mawson

[You can view the full itinerary on our website.](#) In the genuine spirit of expedition travel, this itinerary is only a guide and is subject to change due to additional permitting, weather, sea and other conditions beyond our control.

DAY OVERVIEW

1	Arrive in Dunedin and transfer to your hotel.
2	Embark in Dunedin.
3	At sea.
4–6	As we explore the New Zealand subantarctic islands, you will witness an ecosystem populated by unique endemic species such as the yellow-eyed penguin and Campbell mollymawk.
7–10	At sea.
11–17	Thrill to the grandeur of the transantarctic mountains as we attempt to push deep into the Ross Sea on a pilgrimage to historical sites of the heroic age of exploration, and marvel at the perfectly cleaved Ross Ice Shelf. This area is home to Antarctica's largest Adélie penguin colony and is the site of the first recorded landing in Antarctica. Watch for ethereal snow petrels as they play on air currents sweeping down from the polar ice cap.
18–20	At sea.
21–22	Macquarie Island is a remote subantarctic wonder teeming with unique wildlife and rugged landscapes. Despite its remote location and harsh climate, Macquarie Island supports a remarkable abundance of wildlife. (Visit subject to permits.)
23–24	At sea.
25	Disembark in Dunedin.

ACTIVITIES



Zodiac Cruises



Walks & Hikes



Photography



Expert Lectures



Polar Plunge



Birdwatching



Historical Sites



Citizen Science



Sea Kayaking

*Optional activities available on select voyages, at additional cost. ^Only available on the Antarctic portion of the itinerary, as time and conditions allow.



Fiordland, New Zealand



This map is a guide only and is subject to change due to permitting and regulatory approvals; and weather, sea state and other conditions beyond our control.



Southern royal albatross, Campbell Island

NEW

Subantarctic Discovery

Australian & New Zealand (Aotearoa) Subantarctic Islands | 15 Days

Perched on the Antarctic Convergence, Australia and New Zealand's subantarctic islands are home to some of the most abundant and unique wildlife on earth. New Zealand's Auckland and Campbell Islands are home to yellow-eyed penguins, sea lion harems and courting southern royal albatross. Immerse yourself in magnificent Fiordland.

HIGHLIGHTS

- Delight in seeing sea lion harems and yellow-eyed penguins
- Listen as southern royal albatross court amid megaherb meadows
- Take in a waterfall wonderland while cruising magnificent Fiordland

DATES

Start/Finish	Duration	Dates	Voyage Code	Type of Voyage
Dunedin/Dunedin	15 Days	02 Jan '26–16 Jan '26	SUB001D	Sail

Voyage Codes: G = Greg Mortimer | S = Sylvia Earle | D = Douglas Mawson

You can view the full itinerary on our website. In the genuine spirit of expedition travel, this itinerary is only a guide and is subject to change due to additional permitting, weather, sea and other conditions beyond our control.

DAY OVERVIEW

1	Arrive in Dunedin and transfer to your hotel.
2	Embark in Dunedin.
3	Sail overnight to reach Stewart Island, New Zealand's third largest island.
4	In the western third of Southland, is Fiordland, a spectacular region where the Southern Alps reach the sea in a series of steep-sided, glacier-carved and now flooded valleys called 'sounds'.
5	The Snares Islands is the only group in the Southern Ocean that has no introduced mammals, making the islands an extraordinary and strongly protected haven for wildlife, especially seabirds.
6–7	At sea.
8–9	Macquarie Island is a remote subantarctic wonder teeming with unique wildlife and rugged landscapes. (Visit subject to permits.)
10	At sea.
11–13	As we explore the New Zealand subantarctic islands, you will witness an ecosystem populated by unique endemic species such as the yellow-eyed penguin and Campbell mollymawk.
14	At sea.
15	Disembark in Dunedin.

ACTIVITIES



Zodiac Cruises



Walks & Hikes



Photography



Expert Lectures



Birdwatching



Historical Sites



Citizen Science



One of the largest Adélie penguin colonies, Cape Adare, Antarctica

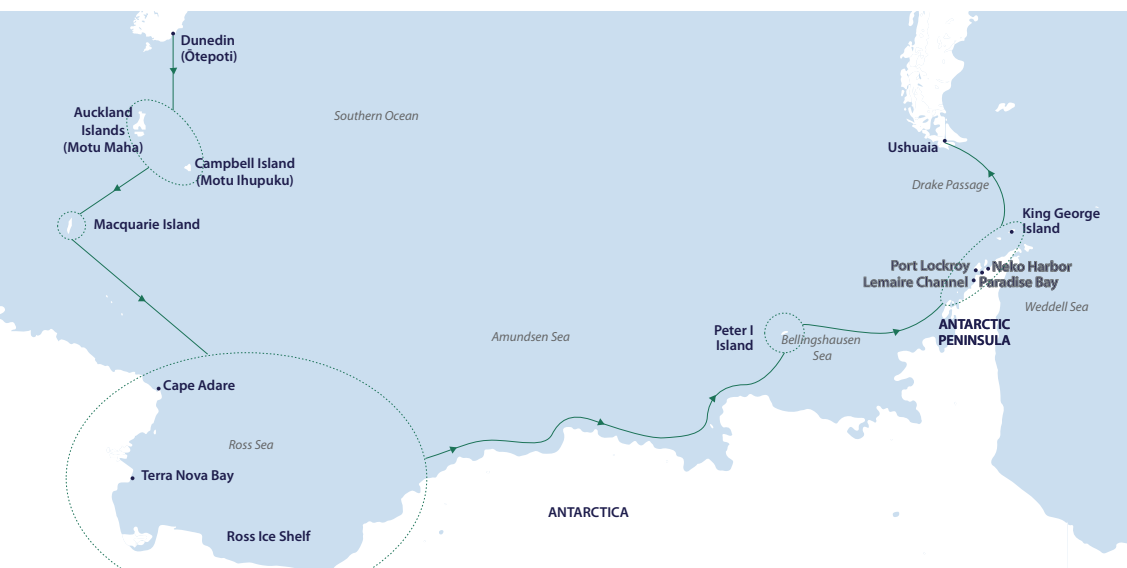

This map is a guide only and is subject to change due to permitting and regulatory approvals; and weather, sea state and other conditions beyond our control.



Humpback whale, Antarctica © T Mayr

NEW

Epic Antarctica: Crossing the 7th Continent

NZ Subantarctic Islands, Ross Sea, Antarctic Peninsula, Antarctic Circle | 34 Days

Calling all pioneers, history buffs and adventure lovers for an epic adventure across the southern seas. Follow in the footsteps of explorers such as Scott, Ross, Amundsen and Shackleton and embark on a journey very few people on this planet have made. Sail beyond the Antarctic Circle, uncover wonders of the Ross Sea, explore the Antarctic Peninsula and the incredible sights in between! This is a once-in-a-lifetime opportunity to witness the beauty and majesty of this remote and pristine environment.

HIGHLIGHTS

- Learn more about the impressive Ross Ice Shelf, the largest ice shelf in the world (roughly the size of France)
- Follow the trails of pioneers and traverse the Antarctic coastline from the Ross Sea to the Antarctic Peninsula
- Bear witness to a vast array of wildlife, including numerous penguin species, all on one trip

DATES

Start/Finish	Duration	Dates	Voyage Code	Type of Voyage
Dunedin/Ushuaia	34 Days	08 Feb '26–12 Mar '26	ASC001D	Sail

Voyage Codes: G = Greg Mortimer | S = Sylvia Earle | D = Douglas Mawson

[You can view the full itinerary on our website.](#) *In the genuine spirit of expedition travel, this itinerary is only a guide and is subject to change due to additional permitting, weather, sea and other conditions beyond our control.*

DAY OVERVIEW

1	Arrive in Dunedin and transfer to your hotel.
2	Embark in Dunedin.
3	At sea.
4–6	As we explore the New Zealand subantarctic islands, you will witness an ecosystem populated by unique endemic species such as the yellow-eyed penguin and Campbell mollymawk.
7	At sea.
8–9	Macquarie Island is a remote subantarctic wonder teeming with unique wildlife and rugged landscapes. (Visit subject to permits.)
10–12	At sea.
13–18	Thrill to the grandeur of the transantarctic mountains as we attempt to push deep into the Ross Sea on a pilgrimage to historical sites of the heroic age of exploration, and marvel at the perfectly cleaved Ross Ice Shelf. This area is also home to Antarctica's largest Adélie penguin colony.
19–26	As we journey east along the coastline, we learn about the trailblazing explorers who travelled this 'path' many years ago. Conditions permitting, we hope to stop along the way, including at Peter I Island, a volcanic island in the Bellingshausen Sea.
27–31	Experience Antarctica at its liveliest, with whales feeding, seals on the ice, and penguin chicks feeding and growing rapidly. Zodiac-cruise amid iridescent grounded bergs, watching for whales.
32–33	Return sailing across the Drake Passage to Ushuaia.
34	Disembark in Ushuaia.

ACTIVITIES



Zodiac Cruises



Walks & Hikes



Photography



Expert Lectures



Polar Plunge



Birdwatching



Historical Sites



Citizen Science



Sea Kayaking

*Optional activities available on select voyages, at additional cost. ^Only available on the Antarctic portion of the itinerary, as time and conditions allow.

Antarctic Peninsula

Jagged peaks and mountain ranges offer breathtaking backdrops as you embark on an adventure among iconic Antarctic wildlife, surrounded by numerous species of seals, penguins and whales. Set foot on the epic seventh continent, cruise past tabular icebergs and visit historical sites – including the most southerly post office in the world.

"My wife and I both agreed we had the greatest holiday of our lives in Antarctica. Whether it was whale watching from the Zodiacs, visiting penguin colonies or marvelling at the shapes of floating icebergs... it was only made better by the comforts on board, the service of the staff and the camaraderie of the passengers and crew. What an unforgettable experience!"

— P Houghton





Amazing rock formations and crystal-clear water, Port Charcot, Antarctica © P Eastway

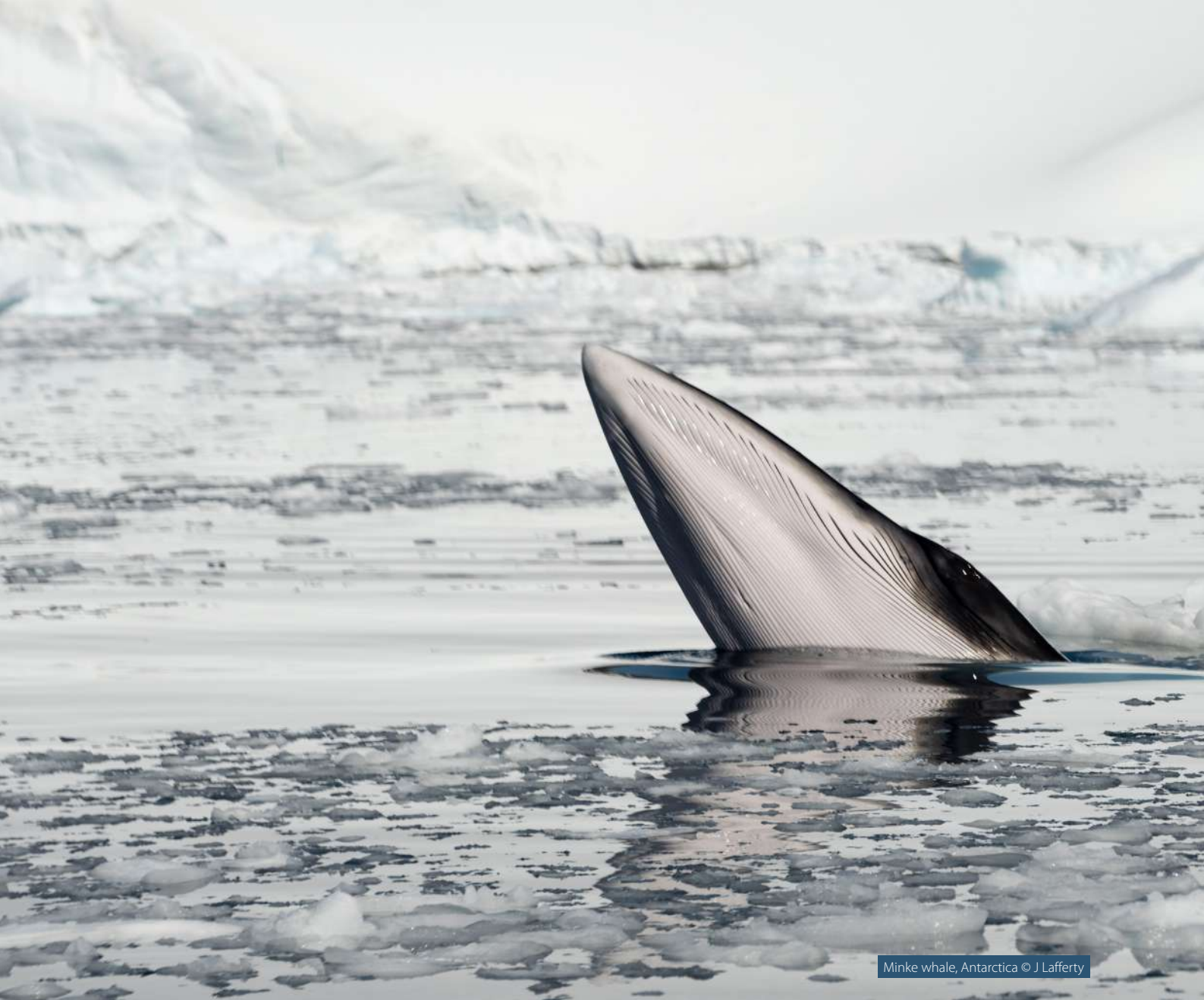

Minke whale, Antarctica © J Lafferty



This map is a guide only and is subject to change due to weather, sea state and other conditions beyond our control.



Zodiac-cruising in Orne Harbour, Antarctica © P Harboure

Spirit of Antarctica

Antarctic Peninsula | 12 Days

Embrace the spirit of polar exploration on this classic expedition to the white continent. Sail across the famed Drake Passage in both directions, admiring spectacular seabirds and approaching Antarctica as the explorers of old did – by sea. Search for wildlife on a Zodiac cruise, aim to set foot on the continent, participate in your selected adventure activity and perhaps camp under pastel polar skies. This is the quintessential Antarctic voyage for adventure lovers.

HIGHLIGHTS

- Hone your ice and wildlife photography skills
- Search for orca and minke whales in the icy bays
- Observe busy penguin colonies building their nests and perhaps catch a glimpse of penguin chicks as they hatch
- Join the exclusive polar plunge club and jump into the beautiful Antarctic waters

DATES

Start Finish	Duration	Dates	Voyage Code	Type of Voyage
Ushuaia/Ushuaia	12 Days	27 Oct '24–07 Nov '24	ANP168G	Sail
Ushuaia/Ushuaia	12 Days	12 Nov '24–23 Nov '24	ANP169S	Sail
Ushuaia/Ushuaia	12 Days	22 Nov '24–03 Dec '24	ANP170S	Sail
Ushuaia/Ushuaia	12 Days	08 Dec '24–19 Dec '24	ANP171G	Sail
Ushuaia/Ushuaia	12 Days	06 Jan '25–17 Jan '25	ANP172G	Sail
Ushuaia/Ushuaia	12 Days	10 Nov '25–21 Nov '25	ANP174G	Sail
Ushuaia/Ushuaia	12 Days	19 Nov '25–30 Nov '25	ANP175S	Sail
Ushuaia/Ushuaia	12 Days	10 Dec '25–21 Dec '25	ANP176S	Sail

Voyage Codes: G = Greg Mortimer | S = Sylvia Earle | D = Douglas Mawson

DAY OVERVIEW

- 1 Arrive in Ushuaia and transfer to your hotel.
- 2 Embark in Ushuaia.
- 3–4 Cross the Drake Passage to the Antarctic Peninsula.
- 5–9 Immerse yourself in the unforgettable landscapes of Antarctica. In this great wilderness, nature sets the pace for our adventures. With constantly changing weather and sea ice conditions, each day's activities offer an element of spontaneity and surprise. Our highly experienced Expedition Team will design each day's adventures based on what nature throws at them. Pack a flexible attitude and enjoy the thrill of what each day brings. Sail past spectacular ice cliffs, hear the orchestra of the ice as it cracks, hisses and pops, visit bustling penguin rookeries, and observe seals on the ice and whales in their southern feeding grounds. Discover historical sites and other intriguing relics scattered across the Antarctic Peninsula.
- 10–11 Return sailing across the Drake Passage to Ushuaia.
- 12 Disembark in Ushuaia.

[You can view the full itinerary on our website.](#) In the genuine spirit of expedition travel, this itinerary is only a guide and is subject to change due to weather, sea and other conditions beyond our control.

ACTIVITIES



*Optional activities available on select voyages, at additional cost.



Zodiac cruising at Prospect Point, Antarctica © T Mayr



This map is a guide only and is subject to change due to weather, sea state and other conditions beyond our control.

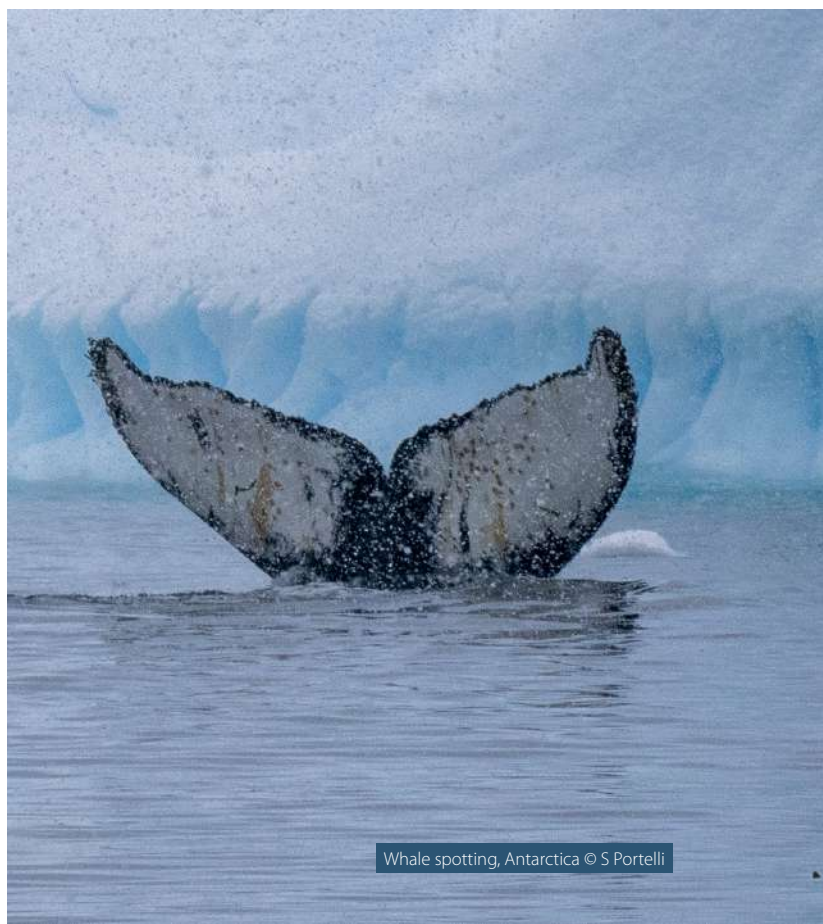

Whale spotting, Antarctica © S Portelli

BEST SELLER

Antarctic Explorer

Antarctic Peninsula | From 12 Days

Early Antarctic explorers returned from their voyages to the deep south with tales of a magnificent, ice-covered land teeming with life. Experience the awe-inspiring immensity of Antarctica and immerse yourself in the unimaginable beauty of the Antarctic Peninsula, where vast glaciers tumble into the sea, penguins are dwarfed by soaring peaks, and humpback and minke whales feast on abundant krill. Reduce your time on the high seas by flying one way across the Drake Passage.

HIGHLIGHTS

- See and hear the bustling activity of a penguin city
- Chance to spot leopard seals on ice floes from our Zodiacs
- Zodiac-cruise in search of feeding and breaching whales
- Fly over the Drake Passage in one direction

DATES

Start/Finish	Duration	Dates	Voyage Code	Type of Voyage
Punta Arenas/ Ushuaia	13 Days	19 Jan '25–31 Jan '25	AEP046S	Fly/Sail
Punta Arenas/ Ushuaia	13 Days	26 Jan '25–07 Feb '25	AEP047G	Fly/Sail
Punta Arenas/ Ushuaia	13 Days	12 Feb '25–24 Feb '25	AEP048G	Fly/Sail
Ushuaia/ Punta Arenas	12 Days	20 Feb '25–03 Mar '25	AEP049S	Sail/Fly
Punta Arenas/ Ushuaia	12 Days	01 Feb '26–12 Feb '26	AEP051G	Fly/Sail
Punta Arenas/ Ushuaia	12 Days	17 Mar '26–28 Mar '26	AEP052S	Fly/Sail

Voyage Codes: G = Greg Mortimer | S = Sylvia Earle | D = Douglas Mawson



DAY OVERVIEW

1 Arrive in Punta Arenas and transfer to your hotel.

2 Fly* to King George Island for embarkation.

3–9 Immerse yourself in the unforgettable landscapes of the white continent. In this great wilderness, nature sets our pace. Changing weather and ice conditions make every trip truly unique. Cruise by spectacular ice cliffs and observe seals on ice, whales in their southern feeding grounds and visit bustling penguin rookeries. Discover historical sites and other intriguing relics scattered across the Antarctic Peninsula.

10–11 Drake Passage crossing. Will you endure the notorious 'Drake Shake' or experience the 'Drake Lake?'

12 Arrive in Ushuaia and transfer to the airport.

[You can view the full itinerary on our website.](#) The itinerary overview is based on a Fly/Sail voyage. This voyage also operates as a Sail/Fly route. Please check the itinerary of your chosen departure for details.

In the genuine spirit of expedition travel, this itinerary is only a guide and is subject to change due to weather, sea and other conditions beyond our control.

**Please note that we are flying to one of the most remote places on earth. Safety is our utmost priority and we apologise in advance if any delays occur. Please refer to our terms and conditions for more details.*

Add Sea Kayaking

As a small group of kayakers joined by experienced guides, paddle past humpback whales and curious crabeater seals, and marvel at iridescent icebergs from your own kayak.

ACTIVITIES



Zodiac Cruises



Walks & Hikes



Photography



Expert Lectures



Polar Plunge



Birdwatching



Historical Sites



Citizen Science



Sea Kayaking



Snorkelling



Paddling



Scuba Diving

*Optional activities available on select voyages, at additional cost.



Boarding the charter plane to Antarctica © J Henderson



This map is a guide only and is subject to change due to weather, sea state and other conditions beyond our control.

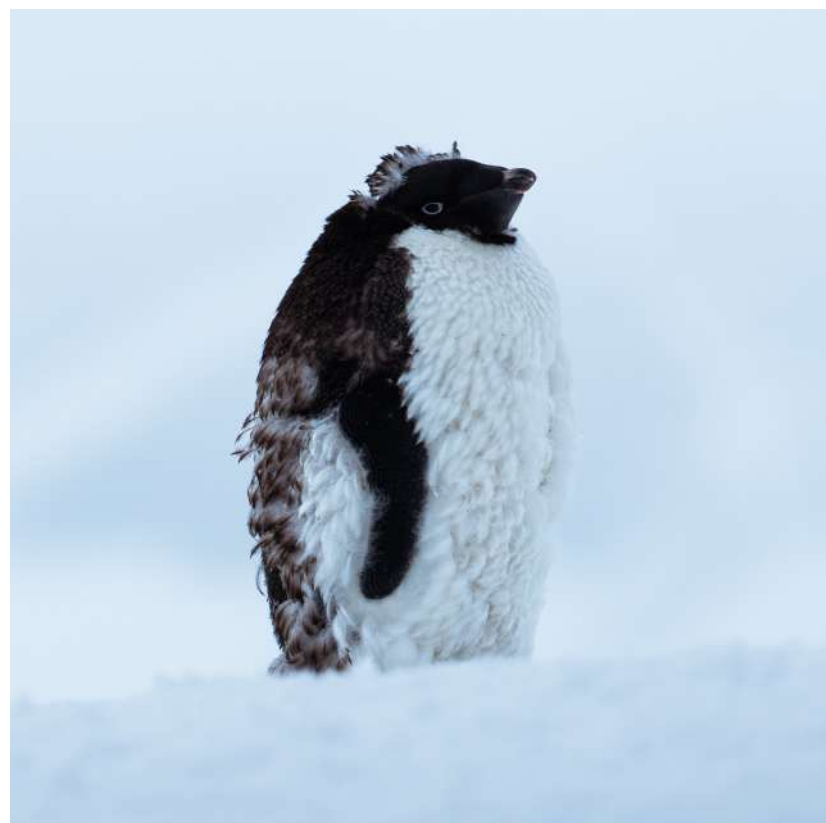

Moulting Adélie penguin, Antarctica © T Mayr

Antarctic Peninsula: Fly the Drake

Antarctic Peninsula | 12 Days

Separating South America from the Antarctic Peninsula, the Drake Passage tests the skills of the most experienced navigators. On this voyage, avoid sailing the notoriously choppy passage by flying over it in both directions – a great way to reach the white continent if you are prone to sea sickness. In the safe hands of experienced pilots, your pulse will quicken as you glimpse your first icebergs in the Southern Ocean, where your vessel awaits, ready to take you on an exhilarating adventure.

HIGHLIGHTS

- Soar over the Drake Passage in both directions, soaking in the splendour of the icy scenery below
- Enjoy lengthy daylight hours as the sun barely dips below the horizon, giving you more time to explore
- See fluffy juvenile penguins preparing for independence

DATES

Start/Finish	Duration	Dates	Voyage Code	Type of Voyage
Punta Arenas/Punta Arenas	12 days	23 Jan '26–03 Feb '26	APF010G	Fly/Fly
Punta Arenas/Punta Arenas	12 days	08 Feb '26– 19 Feb '26	APF011S	Fly/Fly

Voyage Codes: G = Greg Mortimer | S = Sylvia Earle | D = Douglas Mawson

DAY OVERVIEW

- 1 Arrive in Punta Arenas and transfer to your hotel.
- 2 Fly* to King George Island for embarkation.
- 3–10 Immerse yourself in the unforgettable landscapes of the white continent. In this great wilderness, nature sets our pace. Changing weather and ice conditions make every trip truly unique. Cruise by spectacular ice cliffs and observe seals on the ice, whales in their southern feeding grounds and visit bustling penguin rookeries. Discover historical sites and other intriguing relics scattered across the Antarctic Peninsula.
- 11 At King George Island, board your charter flight* to Punta Arenas, enjoying a final night in town.
- 12 Transfer to the airport for your onward journey.

[You can view the full itinerary on our website.](#) In the genuine spirit of expedition travel, this itinerary is only a guide and is subject to change due to weather, sea and other conditions beyond our control.

*Please note that we are flying to and from one of the most remote places on earth. Safety is our utmost priority and we apologise in advance if any delays occur. Please refer to our terms and conditions for more details.



Add Patagonia EcoCamp

Uniquely Patagonian, Cascada EcoCamp offers an environmentally friendly way to experience nature in comfort. Explore Torres del Paine National Park your way with various short walks and longer hikes on offer, showcasing views of Nordenskjöld Lake and Lake Pehoe.

ACTIVITIES



*Optional activities available on select voyages, at additional cost.



Exploring Lautaro Island, Antarctica © P Harboure



Humpback whale, Antarctica © L Stock at Divergent Travelers

This map is a guide only and is subject to change due to weather, sea state and other conditions beyond our control.

Antarctic Explorer Express

Antarctic Peninsula | 9 Days

The younger sibling to our Antarctic Explorer voyage, the nine-day Antarctic Explorer Express offers a similar itinerary to its mature sibling but with a shorter duration. Travellers who are strapped for time will find this quick trip to the Antarctic Peninsula the perfect fit. A flight over the Drake Passage in one direction combined with an action-packed time in the Antarctic Peninsula, our Antarctic Explorer Express voyages are tailored for travellers seeking a brief adventure to the frozen continent. Your days will be filled with penguin and seal encounters, Zodiac excursions to explore rugged coastlines and majestic icebergs, and possible visits by curious whales.

HIGHLIGHTS

- The large number of whales present in late summer can provide unforgettable moments with these magnificent giants
- See penguins begin to moult and gentoo penguin parents feeding their chicks

DATES

Start/Finish	Duration	Dates	Voyage Code	Type of Voyage
Ushuaia/Punta Arenas	9 days	17 Jan '26–25 Jan '26	ANE003G	Sail/Fly

Voyage Codes: G = Greg Mortimer | S = Sylvia Earle | D = Douglas Mawson

DAY OVERVIEW

- 1 Arrive in Ushuaia and transfer to your hotel.
- 2 Embark in Ushuaia.
- 3–4 Drake Passage crossing. Will you endure the notorious 'Drake Shake' or experience the 'Drake Lake?'
- 5–7 Pinch yourself. You are in Antarctica! Over the next few days, our experienced Expedition Team will tailor your day-by-day experiences, based on the changing weather and ice conditions. On an expedition, we make no promises apart from offering you a genuine voyage that is filled with adventure, fun, spontaneous moments, encounters with unique wildlife, mind-blowing icy landscapes and an appreciation for nature. Each day promises new experiences and a chance to form closer bonds with nature and fellow like-minded expeditioners.
- 8 Board a charter flight* to Punta Arenas for an overnight stay.
- 9 Transfer to Punta Arenas airport to continue your journey.

You can view the full itinerary on our website. In the genuine spirit of expedition travel, this itinerary is only a guide and is subject to change due to weather, sea and other conditions beyond our control.

** Please note that we are flying to and from one of the most remote places on earth. Safety is our utmost priority and we apologise in advance if any delays occur. Please refer to our terms and conditions for more details.*

ACTIVITIES

										
Zodiac Cruises	Walks & Hikes	Photography	Expert Lectures	Polar Plunge	Birdwatching	Historical Sites	Citizen Science	Sea Kayaking	Snorkelling	Paddling

*Optional activities available on select voyages, at additional cost.



Snowy landscape in Antarctica © G Thomas



This map is a guide only and is subject to change due to weather, sea state and other conditions beyond our control.



Adélie penguins, Antarctica © M Seigal

Antarctic Peninsula in Depth

Antarctic Peninsula | 15 Days

The ultimate expedition to the Antarctic Peninsula that seeks to include visits to some well-known locations and opportunities for surprise discoveries. Enjoy discovering the wonders of the Antarctic Peninsula with more time for exploration, by Zodiac, walks/hikes on land, or through one of our optional activities (additional cost). The near-pristine conditions in early summer allow for postcard-perfect photographs.

HIGHLIGHTS

- Enjoy an in-depth exploration of the Antarctic Peninsula where we aim to showcase some of our most popular sites and hope to discover future favourites
- The Antarctic Peninsula is a hive of activity with penguins arriving and nesting
- Witness the sublime beauty of the Antarctic Peninsula in its near-pristine conditions
- Enjoy early season sightings of whales

DATES

Start/Finish	Duration	Dates	Voyage Code	Type of Voyage
Ushuaia/Ushuaia	15 Days	06 Nov '24–20 Nov '24	APD003G	Sail

Voyage Codes: G = Greg Mortimer | S = Sylvia Earle | D = Douglas Mawson

DAY OVERVIEW

1 Arrive in Ushuaia and transfer to your hotel.

2 Embark in Ushuaia.

3–4 Drake Passage crossing.

It is almost impossible to describe the feeling of arriving in Antarctica. Spotting your first iceberg and taking a deep breath of some of the freshest, crispest air on earth is an experience that will stay with you forever. Over the next eight days, you will settle into the natural rhythm of life on the Antarctic Peninsula. Your experienced Expedition Team, who have made countless journeys to this area, will use their expertise to design your voyage from day to day, choosing the best options based on the prevailing weather and wildlife opportunities. Enjoy Zodiac cruises along spectacular ice cliffs or among grounded icebergs, keeping watch for whales, seals and porpoising penguins. While ashore, you can stroll along the beach and photograph the wildlife and the magnificent scenery, visit penguin rookeries and discover historic huts. With extra time for exploration, we plan to show you our favourite spots across the peninsula and possibly discover new future favourites along the way.

5–12

13–14 Drake Passage crossing.

15 Disembark in Ushuaia.

You can view the full itinerary on our website. In the genuine spirit of expedition travel, this itinerary is only a guide and is subject to change due to weather, sea and other conditions beyond our control.

ACTIVITIES



Zodiac Cruises



Walks & Hikes



Photography



Expert Lectures



Polar Plunge



Birdwatching



Historical Sites



Citizen Science



Sea Kayaking



Camping



Snowshoeing



Ski & Snowboard Touring

*Optional activities available on select voyages, at additional cost.



Snorkelling at Portal Point, Antarctica © S Portelli



This map is a guide only and is subject to change due to weather, sea state and other conditions beyond our control.

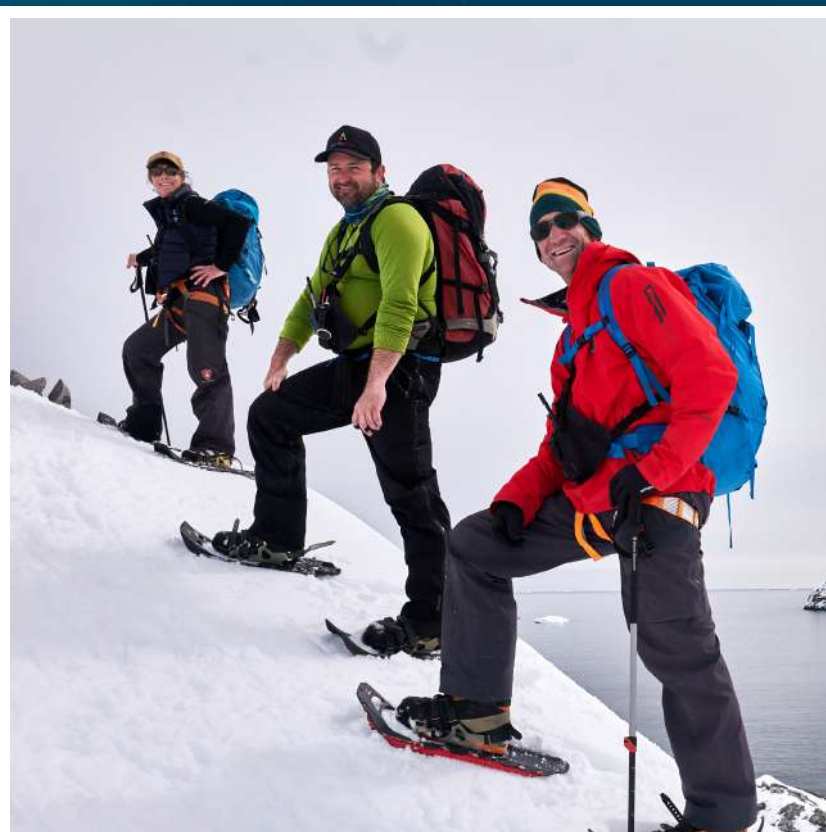

Snowshoeing in Antarctica © D Phillips

Antarctica Active: All Inclusive Activities

Antarctic Peninsula | 15 Days

On these activity-packed sailings, you will experience the wonders of Antarctica on a deeper level. Not only will you enjoy Zodiac excursions and guided walks offered on all our voyages, you will also paddle among icebergs in protected bays and perhaps glimpse wildlife close up. Step into your own snowshoes for a gentle hike, where breathtaking views await. For the ultimate overnight adventure in Antarctica, pack a sleeping bag for a sleepover on the ice.

HIGHLIGHTS

- An activity-filled voyage for adventurous expeditioners who want to sample a suite of our renowned activities
- Experience unspoiled Antarctic wildlife up close
- Witness the sublime beauty of the Antarctic Peninsula in its near-pristine conditions in the early part of the season
- Watch busy penguins scurrying about building nests and forming colonies

DATES

Start/Finish	Duration	Dates	Voyage Code	Type of Voyage
Ushuaia/Ushuaia	15 Days	20 Nov '25–04 Dec '25	APD004G	Sail
Ushuaia/Ushuaia	15 Days	03 Dec '25–17 Dec '25	APD005G	Sail

Voyage Codes: G = Greg Mortimer | S = Sylvia Earle | D = Douglas Mawson

ALL NEW INCLUDED ACTIVITIES



Due to strong demand, we are pleased to introduce this new voyage featuring our ever-popular activities included in the voyage cost, allowing our passengers to choose their own adventure.*

DAY OVERVIEW

1 Arrive in Ushuaia and transfer to your hotel.

2 Embark in Ushuaia.

3–4 Drake Passage crossing.

5–12

It is almost impossible to describe the feeling of arriving in Antarctica. Spotting your first iceberg and taking a deep breath of some of the freshest, crispest air on earth is an experience that will stay with you forever. Over the next eight days, you will settle into the natural rhythm of life on the Antarctic Peninsula. Your experienced Expedition Team, who have made countless journeys to this area, will use their expertise to design your voyage from day to day, choosing the best options based on the prevailing weather and wildlife opportunities. Enjoy Zodiac cruises along spectacular ice cliffs, keeping watch for whales, seals and porpoising penguins, and paddle in quiet coves among stranded icebergs. While ashore, you can stroll along the beach or stand quietly to observe the passing wildlife. Strap on your snowshoes and hike to lookouts to photograph the magnificent scenery. With extra time for exploration, we plan to show you our favourite spots across the peninsula and possibly discover new future favourites along the way.

13–14 Drake Passage crossing.

15 Disembark in Ushuaia.

*You can view the full itinerary on our website. In the genuine spirit of expedition travel, this itinerary is only a guide and is subject to change due to weather, sea and other conditions beyond our control. *Activity requirements apply*

ACTIVITIES



Zodiac Cruises



Walks & Hikes



Photography



Expert Lectures



Polar Plunge



Birdwatching



Historical Sites



Citizen Science



Paddling



Camping



Snowshoeing



Snorkelling

*Please note that for safety and operational reasons, participation in activities is dependent on participants meeting specific inclusion criteria, and the number of available slots within limited group sizes for each activity. All activities are subject to weather, ice, and other conditions.



Hiking up snowy slopes, Antarctica © G Thomas



This map is a guide only and is subject to change due to weather, sea state and other conditions beyond our control.



A toast to crossing the Antarctic Circle, Antarctica © J Lafferty

Across the Antarctic Circle



Antarctic Peninsula, Antarctic Circle | From 13 Days

Venturing below the Antarctic Circle is about more than just earning bragging rights. It is the chance to enter a different world that is rarely seen, and with its great swathes of pack ice and dreamlike icebergs, it feels more isolated and colder than farther north. Thread through narrow channels where scenes of ice-clad mountains, whales feeding and lively penguin colonies, become lasting memories.

HIGHLIGHTS

- Experience a toast at the Antarctic Circle, 66° 33' south (conditions permitting)
- Enjoy a splendour of wildlife activity as birds, seals and whales race to fatten up for winter
- Visit fascinating historical sites
- Zodiac-cruise with the hope of spotting leopard and crabeater seals

DATES

Start/Finish	Duration	Dates	Voyage Code	Type of Voyage
Ushuaia/Ushuaia 	14 Days	21 Dec '24–03 Jan '25	ANC010S	Sail
Ushuaia/Punta Arenas	13 Days	16 Jan '25–28 Jan '25	ANC011G	Sail/Fly
Ushuaia/Ushuaia	13 Days	23 Feb '25–07 Mar '25	ANC012G	Sail
Ushuaia/Ushuaia	13 Days	29 Nov '25–11 Dec '25	ANC013S	Sail
Ushuaia/Ushuaia 	13 Days	16 Dec '25–28 Dec '25	ANC014G	Sail
Ushuaia/Punta Arenas	13 Days	29 Jan '26–10 Feb '26	ANC015S	Sail/Fly
Ushuaia/Ushuaia	13 Days	21 Feb '26–05 Mar '26	ANC016G	Sail

Voyage Codes: G = Greg Mortimer | S = Sylvia Earle | D = Douglas Mawson

DAY OVERVIEW

- | DAY | OVERVIEW |
|-----|---|
| 1 | Arrive in Ushuaia and transfer to your hotel. |
| 2 | Embark in Ushuaia. |
| 3–4 | Drake Passage crossing. |

The western side of the Antarctic Peninsula is ours to explore and our flexible itinerary allows us to make the most of local conditions to Zodiac-cruise or kayak among the ice, hoping to see whales and other marine wildlife. Set foot on the white continent and its offshore islands to visit penguin rookeries, seal haulouts, historical sites and spectacular viewpoints. As you weave through pack ice and narrow channels, scenes of ice-clad mountains and abundant wildlife in its natural habitat will be etched into your memory for years to come. Raise a toast to mark the occasion as you join a lucky group of adventurers to cross 66° 33' south (approximately), below the Antarctic Circle.

12–13 Drake Passage crossing.

14 Disembark in Ushuaia.

[You can view the full itinerary on our website.](#) This voyage also operates as a Sail/Fly voyage. In the genuine spirit of expedition travel, this itinerary is only a guide and is subject to change due to weather, sea and other conditions beyond our control.

ACTIVITIES



Zodiac Cruises



Walks & Hikes



Photography



Expert Lectures



Polar Plunge



Birdwatching



Historical Sites



Citizen Science



Sea Kayaking



Snorkelling



Paddling



Snowshoeing



Scuba Diving

*Optional activities available on select voyages, at additional cost.



Zodiac-cruising at Crystal Sound, Antarctica © J Lafferty



This map is a guide only and is subject to change due to weather, sea state and other conditions beyond our control.



Aerial view of Antarctica © T Mayr

Wild Antarctica *featuring* the Weddell Sea

Antarctic Peninsula & Weddell Sea | From 12 Days

Famed for its tremendous tabular icebergs, year-round sea ice, fascinating fossils and the pivotal role it played in Shackleton's *Endurance* expedition, the Weddell Sea offers unsurpassed opportunities for exploration. Embark on a true Antarctic expedition as we not only explore the western side of the Antarctic Peninsula but also attempt to venture east towards the icy perimeter of the Weddell Sea, which is often guarded by impenetrable pack ice and home to awe-inspiring tabular icebergs.

HIGHLIGHTS

- Be awed by the array of wildlife that play and hunt in the Antarctic Sound
- Marvel at gigantic tabular icebergs in the Weddell Sea
- Learn about the incredible fossil-rich volcanic islands from our onboard paleontologist

DATES

Start/Finish	Duration	Dates	Voyage Code	Type of Voyage
Ushuaia/Ushuaia	12 Days	06 Mar '25–17 Mar '25	ANW008G	Sail
Ushuaia/Ushuaia	12 Days	24 Mar '25–04 Apr '25	ANW009S	Sail
Punta Arenas/ Ushuaia	13 Days	17 Feb '26–01 Mar '26	ANW010S	Fly/Sail

Voyage Codes: G = Greg Mortimer | S = Sylvia Earle | D = Douglas Mawson

DAY OVERVIEW

- 1 Arrive in Punta Arenas and transfer to your hotel.
- 2 Fly* to King George Island for embarkation.

In the days ahead, immerse yourself in the unforgettable landscapes of the white continent. Sail across the Bransfield Strait into the other-worldly landscape of the Antarctic Sound. If sea ice conditions allow, venture east into the Weddell Sea, known for its impressive sea ice and large icebergs. Feel your pulse quicken as vast tabular icebergs pass close by. We aim to land on fossil-rich islands for exploration and to hear from our expert paleontologist. Roam the shoreline near where Adélie, gentoo and chinstrap penguins waddle, and delight in their charismatic antics. Zodiac-cruise in search of seals, whales and their calves. We aim to land on the Antarctic continent and the many islands surrounding the peninsula, to visit historical sites and to experience the unforgettable landscape up close.

11–12 Sail the Drake Passage.

13 Disembark in Ushuaia.

[You can view the full itinerary on our website.](#) The itinerary overview is based on ANW010S (Fly/Sail voyage). Voyage also operates as a Sail/Sail route. Please check the itinerary of your chosen voyage for details.

In the genuine spirit of expedition travel, this itinerary is only a guide and is subject to change due to weather, sea and other conditions beyond our control.

**Please note that we are flying to one of the most remote places on earth. Safety is our utmost priority and we apologise in advance if any delays occur. Please refer to our terms and conditions for more details.*

ACTIVITIES



Zodiac Cruises



Walks & Hikes



Photography



Expert Lectures



Polar Plunge



Birdwatching



Historical Sites



Citizen Science



Sea Kayaking



Snorkelling



Paddling



Scuba Diving

*Optional activities available on select voyages, at additional cost.



Weddell seal, Antarctica © J Lafferty



This map is a guide only and is subject to change due to weather, sea state and other conditions beyond our control.

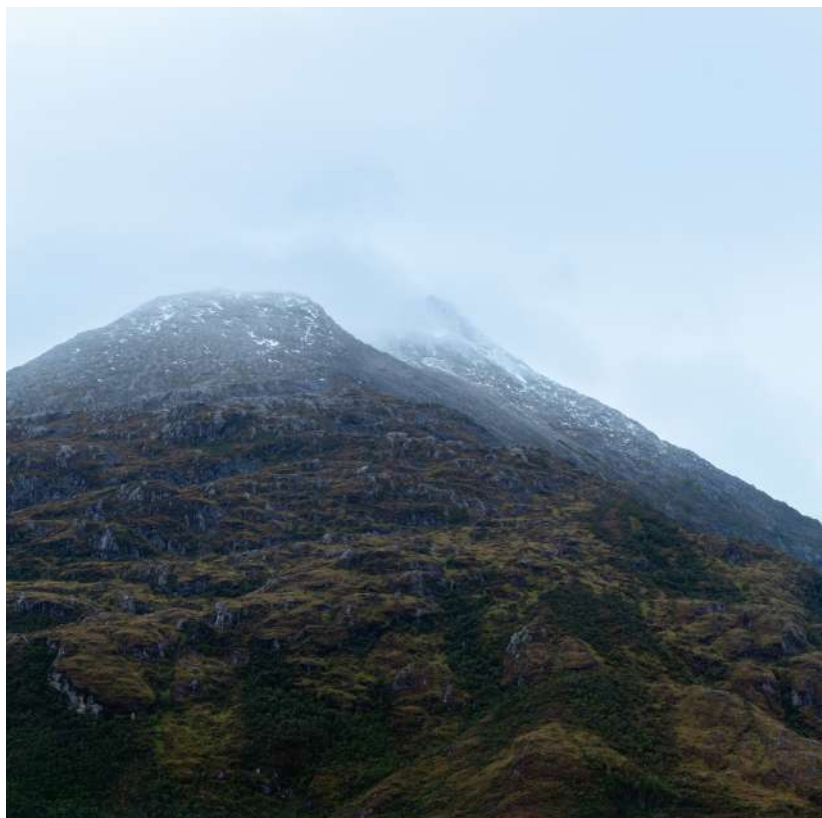

Chilean Fjords © T Mayr

Spirit of Antarctica *featuring* the Chilean Fjords

Antarctic Peninsula & Chilean Fjords | 13 Days

As Antarctica laps up the last of the summer sun and the landscape is bathed in dappled light, its inhabitants show no signs of slowing down. Sail across the famed Drake Passage to and from Antarctica, admiring spectacular seabirds and approaching the ice as the explorers of old did – by sea. With one eye on the sky, watching for skuas, terns or cormorants, you will also need one eye on the water’s surface. This time of year is when humpback whales are peaking in numbers and when you may see penguin chicks heading out for their first swim.

HIGHLIGHTS

- Sail the Chilean Fjords, keeping watch for seabirds and marine wildlife, including dolphins, sea lions and whales
- In Zodiacs, explore quiet bays and coves while searching for wildlife and marvelling at dazzling icebergs
- Observe extraordinary wildlife, including fast-growing penguin chicks leaving their nests and learning to swim

DATES

Start/Finish	Duration	Dates	Voyage Code	Type of Voyage
Punta Arenas/ Ushuaia	13 Days	13 Mar '25–25 Mar '25	ANP173S	Sail

Voyage Codes: G = Greg Mortimer | S = Sylvia Earle | D = Douglas Mawson



Add Buenos Aires & Iguazu Falls

Combine time in fascinating Buenos Aires with the extraordinary natural wonder of Iguazu Falls, in a seamless add-on to your Antarctic voyage.

DAY OVERVIEW

1 Arrive in Punta Arenas and transfer to your hotel.

2 Embark in Punta Arenas.

3 Sail through Chilean fjords and channels flanked by majestic mountains discovered by European explorers over 500 years ago. Keep a look out for seabirds and marine wildlife, including dolphins, sea lions and migrating whales.

4–5 Sail the Drake Passage.

6–10 Immerse yourself in the unforgettable landscapes of Antarctica. In this great wilderness, nature sets the pace for our adventures. With constantly changing weather and sea ice conditions, each day’s activities offer an element of spontaneity and surprise. Our highly experienced Expedition Team will design each day’s adventures based on what nature throws at them. Sail past spectacular ice cliffs, hear the orchestra of the ice as it cracks, hisses and pops, visit penguin rookeries, and observe seals on the ice and whales in their southern feeding grounds. Discover historical sites and other intriguing relics scattered across the Antarctic Peninsula.

11–12 Drake Passage.

13 Disembark in Ushuaia.

You can view the full itinerary on our website. In the genuine spirit of expedition travel, this itinerary is only a guide and is subject to change due to weather, sea and other conditions beyond our control.

ACTIVITIES



Zodiac Cruises



Walks & Hikes



Photography



Expert Lectures



Polar Plunge



Birdwatching



Historical Sites



Citizen Science



Sea Kayaking



Snorkelling



Paddling



Scuba Diving

*Optional activities available on select voyages, at additional cost. ^Only available on the Antarctic portion of the itinerary.



Chinstrap penguins and a gento penguin, Antarctica © P Harboure



This map is a guide only and is subject to change due to weather, sea state and other conditions beyond our control.



Romanche glacier, Chilean fjords © T Mayr

Antarctic Explorer *featuring* the Chilean Fjords

Antarctic Peninsula & Chilean Fjords | 14 Days

By late summer many adult penguins have returned to the sea, leaving their inquisitive fledglings to fend for themselves. Watch spellbound as they take their first tentative steps into the sea. On land, the summer melt reveals splashes of brilliantly coloured snow algae. Whales congregate in increasing numbers before migrating north for winter while skuas, terns and a suite of petrels wheel against a backdrop of spectacular sunsets, as the days shorten and winter gradually approaches.

HIGHLIGHTS

- Observe extraordinary wildlife, including fledgling penguin chicks and massive humpback whales
- Spot leopard seals on ice floes from our Zodiacs
- Zodiac-cruise in search of feeding and breaching whales
- Soar high over the Drake Passage from Punta Arenas

DATES

Start/Finish	Duration	Dates	Voyage Code	Type of Voyage
Punta Arenas/Punta Arenas	14 Days	01 Mar '25–14 Mar '25	AEP050S	Fly/Sail

Voyage Codes: G = Greg Mortimer | S = Sylvia Earle | D = Douglas Mawson

DAY OVERVIEW

1 Arrive in Punta Arenas and transfer to your hotel.

2 Fly* to King George Island for embarkation.

3–10 Immerse yourself in the unforgettable landscapes of the white continent. In this great wilderness, nature sets our pace. Changing weather and ice conditions make every trip truly unique. Cruise by spectacular ice cliffs and observe seals on the ice, whales in their southern feeding grounds, and visit penguin rookeries. Discover historical sites and other intriguing relics scattered across the Antarctic Peninsula.

11–12 Cross the Drake Passage.

13 Sail through the Chilean Fjords and channels flanked by majestic mountains discovered by European explorers over 500 years ago. Keep a look out for seabirds and marine wildlife, including dolphins, sea lions and whales.

14 Disembark in Punta Arenas.

You can view the full itinerary on our website. In the genuine spirit of expedition travel, this itinerary is only a guide and is subject to change due to weather, sea and other conditions beyond our control.

**Please note that we are flying to one of the most remote places on earth. Safety is our utmost priority and we apologise in advance if any delays occur. Please refer to our terms and conditions for more details.*



Add Polar Snorkelling

Snorkelling in Antarctica offers an insight into the continent's secret underwater world. With this unique experience, discover the fascinating marine life that call these waters home. There are limited places on this activity and an additional cost applies.

ACTIVITIES

Zodiac Cruises	Walks & Hikes	Photography	Expert Lectures	Polar Plunge	Birdwatching	Historical Sites	Citizen Science	Sea Kayaking	Snorkelling	Paddling	Scuba Diving

*Optional activities available on select voyages, at additional cost. ^Only available on the Antarctic portion of the itinerary.

South Georgia & Falklands~ Malvinas

Experience the greatest wildlife show on the planet on your expedition to South Georgia, with thousands of king penguins, seals and seabirds on display throughout the sandy beaches, rugged coves and surrounding snow-capped mountains. Stretch your legs on the windswept coastlines of the Falklands~Malvinas, rich in dramatic military history and home to the world's largest black-browed albatross colony.

"The destinations were positively EPIC... Thank you for an exceptional, life-changing experience that took me out of my comfort zone... I brought home memories and more: a craving to return (and I will), a desire to explore more of the polar regions, and a yearning to see every single penguin in the world. I absolutely loved the trip and am forever grateful for the unique experience – and am thankful to the places and the people that made the experience possible."

— C Wichems







Fur seals, Godthul, South Georgia © G Thomas



This map is a guide only and is subject to change due to weather, sea state and other conditions beyond our control.



Zodiac-cruising at Cierva Cove, Antarctica © L Stock at Divergent Travelers

South Georgia, Falklands & Antarctic Odyssey

Antarctic Peninsula, South Georgia & Falklands~Malvinas | From 20 Days

This voyage encompasses the best of the Antarctic Peninsula and the enchanting wildlife haven of South Georgia. Discover the historical Falklands~Malvinas and stand in awe before the world's largest king penguin colonies in South Georgia. In Antarctica, experience the serenity and grandeur of the most remote place on earth, where penguins nest, whales feed and captivating seals frolic in ice-speckled seas.

HIGHLIGHTS

- Photograph curious seals as you Zodiac-cruise through glassy waters, dazzled by the iridescent blues of icebergs
- Marvel at enormous king penguin colonies in South Georgia
- Witness beaches lined with elephant seals and Antarctic fur seals

DATES

Start/Finish	Duration	Dates	Voyage Code	Type of Voyage
Ushuaia/Ushuaia	21 Days	19 Nov '24–09 Dec '24	ASG092G	Sail
Ushuaia/Ushuaia	21 Days	02 Dec '24–22 Dec '24	ASG093S	Sail
Ushuaia/Punta Arenas	20 Days	02 Jan '25–21 Jan '25	ASG094S	Sail/Fly
Ushuaia/Ushuaia	21 Days	22 Oct '25–11 Nov '25	ASG095G	Sail
Ushuaia/Ushuaia	21 Days	10 Jan '26–30 Jan '26	ASG096S	Sail
Ushuaia/Punta Arenas	20 Days	28 Feb '26–19 Mar '26	ASG097S	Sail/Fly

Voyage Codes: G = Greg Mortimer | S = Sylvia Earle | D = Douglas Mawson

[You can view the full itinerary on our website.](#) This voyage operates in both a clockwise and anti-clockwise direction from Ushuaia, as well as a Sail/Fly variation. Please check the itinerary of your chosen voyage for details.

In the genuine spirit of expedition travel, this itinerary is only a guide and is subject to change due to weather, sea and other conditions beyond our control.

DAY OVERVIEW

1	Arrive in Ushuaia and transfer to your hotel.
2	Embark in Ushuaia.
3	At sea.
4	Discover the windswept coastlines and charismatic wildlife of the Falklands~Malvinas, home to Magellanic and rockhopper penguins, and curious sea lions.
5–6	At sea.
7	At sea/South Georgia.
8–11	In South Georgia, marvel at some of the world's largest king penguin colonies. Walk along beaches brimming with fur seals, elephant seals and curious penguins. Photograph jaw-dropping landscapes, embark on exhilarating hikes and learn about Shackleton's epic tale of leadership and survival.
12–13	At sea.
14	At sea/Antarctic Peninsula.
15–18	In Antarctica, Zodiac-cruise amid iridescent grounded bergs, watching for humpbacks, minke and orca. Walk by plucky chinstrap and gentoo penguins in their bustling colonies. Kayakers, prepare yourselves for an unforgettable experience.
19–20	Drake Passage crossing.
21	Disembark in Ushuaia.

ACTIVITIES



*Optional activities available on select voyages, at additional cost. ^Only available on the Antarctic portion of the itinerary.



Macaroni penguins, South Georgia © J Lafferty



This map is a guide only and is subject to change due to weather, sea state and other conditions beyond our control.



Icebergs, Antarctica © J Lafferty

Antarctica Complete

Antarctic Peninsula, Antarctic Circle, South Georgia, Falklands~Malvinas | 23 Days

Experience unparalleled adventure and discovery on your ultimate Antarctic voyage. If you want to see it all, this is the trip for you. Be transported to enthralling subantarctic islands, rich with human history and unique wildlife. Then venture into the deep south of the Antarctic Peninsula, crossing the coveted Antarctic Circle. Zodiac-cruise in vast ice-covered landscapes, visit lively penguin colonies, watch for whales and hear tales of past explorers in this fascinating region.

HIGHLIGHTS

- Step ashore on the Antarctic continent to unforgettable vistas, majestic whales, swooping skuas and curious seals
- Raise a glass as you join an exclusive club of people to cross the Antarctic Circle (conditions permitting)
- Marvel at the world's largest king penguin colonies
- Hike along pebble beaches and climb tussock steps, with unexpected wildlife encounters at every turn

DATES

Start/Finish	Duration	Dates	Voyage Code	Type of Voyage
Ushuaia/Ushuaia	23 Days	30 Jan '25–21 Feb '25	ACO005S	Sail
Ushuaia/Ushuaia 	23 Days	20 Dec '25–11 Jan '26	ACO006S	Sail

Voyage Codes: G = Greg Mortimer | S = Sylvia Earle | D = Douglas Mawson

[You can view the full itinerary on our website.](#) In the genuine spirit of expedition travel, this itinerary is only a guide and is subject to change due to weather, sea and other conditions beyond our control.

DAY OVERVIEW

1	Arrive in Ushuaia and transfer to your hotel.
2	Embark in Ushuaia.
3–4	Cross the Drake Passage.
5–10	As you thread through pack ice and narrow channels, ice-clad mountains and abundant wildlife in its natural habitat will be etched into your memory. See penguins moulting and juveniles contemplating their first venture into the ocean. Zodiac-cruise amid grounded bergs, watching for whale blows. Raise a toast to mark the occasion as you join the group of adventurers to cross 66° 33' south, below the Antarctic Circle.
11–12	At sea.
13	At sea/South Georgia.
14–17	You will be captivated by South Georgia's breathtaking scenes: jaw-dropping mountain landscapes and vast king penguin colonies. Zodiac-cruise through bays filled with fur seal pups, and land on beaches to meet elephant seals. Learn of Shackleton's epic voyage of survival, which ended with a traverse of South Georgia.
18–19	At sea.
20	At sea/Falklands~Malvinas.
21	The barren and windswept islands of the Falklands~Malvinas are true wildlife havens, sheltering an impressive diversity of birdlife.
22	At sea.
23	Disembark in Ushuaia.

ACTIVITIES



Zodiac Cruises



Walks & Hikes



Photography



Expert Lectures



Polar Plunge



Birdwatching



Historical Sites



Citizen Science



Sea Kayaking



Paddling



Snorkelling



Snowshoeing

*Optional activities available on select voyages, at additional cost. ^Only available on the Antarctic portion of the itinerary.



Montagu Island, the largest of the South Sandwich Islands © P Eastway

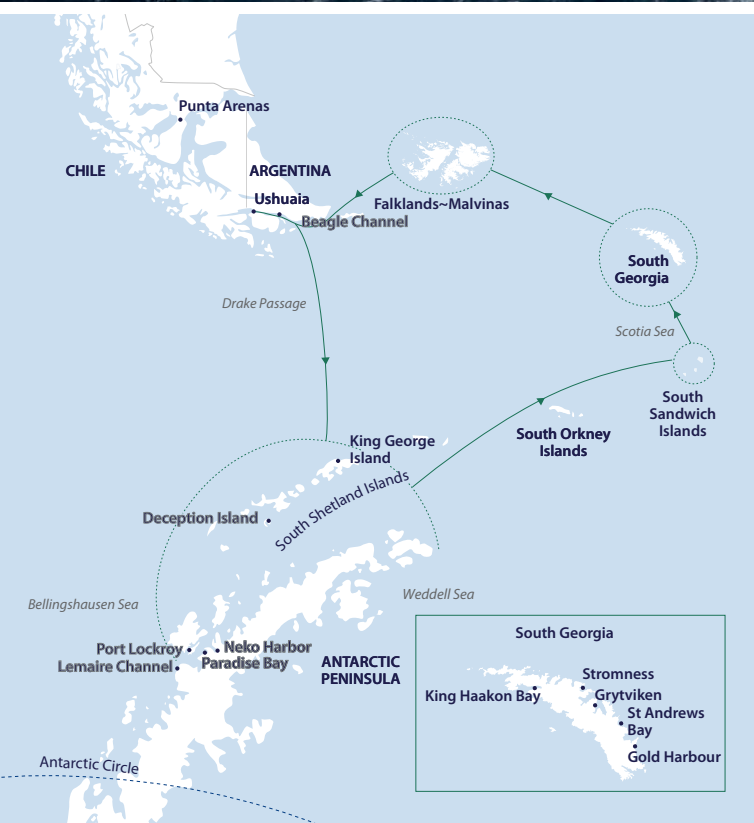

This map is a guide only and is subject to change due to weather, sea state and other conditions beyond our control.



Gentoo penguins on the ice, Godthul, South Georgia © P Eastway

South Georgia & Antarctic Odyssey *featuring the South Sandwich Islands*

Falklands~Malvinas, South Georgia, South Sandwich Islands | 24 Days

On this epic voyage, not only will you explore the famed white continent, enjoy two days discovering the Falklands~Malvinas and encounter the wildlife haven in South Georgia, you will also sail to the South Sandwich Islands, a chain of seldom-visited volcanic islands located 740 kilometres south-east of South Georgia. Simply reaching these wild, far-flung islands is an adventure in itself.

HIGHLIGHTS

- Experience the magnificent wildlife and hear tales of the fascinating history of South Georgia
- Become one of the very few to reach the South Sandwich Islands – a corner of the world rarely visited by travellers
- Enjoy Zodiac excursions in secluded bays and quiet coves filled with brash ice, and photograph enormous glaciers and spectacularly shaped icebergs in their various shades of blue

DATES

Start/Finish	Duration	Dates	Voyage Code	Type of Voyage
Ushuaia/Ushuaia	24 Days	04 Mar '26–27 Mar '26	SSI003G	Sail

Voyage Codes: G = Greg Mortimer | S = Sylvia Earle | D = Douglas Mawson

[You can view the full itinerary on our website.](#) *In the genuine spirit of expedition travel, this itinerary is only a guide and is subject to change due to weather, sea and other conditions beyond our control.*

DAY OVERVIEW

1–2	Overnight in Ushuaia before setting sail on Day 2.
3–4	Drake Passage crossing.
5–8	Over the next few days you will be mesmerised by Antarctica. Zodiac-cruise amid iridescent grounded bergs, watching for whale blows from humpbacks, minkes and orca. Walk by chinstrap and gentle gentoo penguins happily sharing this haven.
9–11	At sea.
12–13	Discover the wild and remote volcanic South Sandwich Islands by ship cruise (no landing permitted). Simply reaching these islands is an adventure in itself.
14	At sea.
15–18	Marvel at truly incredible scenes of enormous king penguin colonies, beach-bound fur seals jostling for space, and jaw-dropping mountain landscapes in South Georgia.
19–20	At sea.
21	At sea/Falklands~Malvinas.
22	Discover the windswept coastlines and charismatic wildlife of the Falklands~Malvinas, home to Magellanic and rockhopper penguins, sea lions and fascinating history.
23	At sea.
24	Disembark in Ushuaia.

ACTIVITIES

											
Zodiac Cruises	Walks & Hikes	Photography	Expert Lectures	Polar Plunge	Birdwatching	Historical Sites	Citizen Science	Sea Kayaking	Paddling	Snorkelling	Scuba Diving

*Optional activities available on select voyages, at additional cost. ^Only available on the Antarctic portion of the itinerary.



Southern rockhopper penguins, Saunders Island, Falklands–Malvinas © A Włodarczyk



This map is a guide only and is subject to change due to weather, sea state and other conditions beyond our control.



Zodiac-cruising at Enterprise Island, Antarctica © M Seigal

Falklands, South Georgia & Antarctic Peninsula

Antarctic Peninsula, South Georgia, Falklands~Malvinas | From 21 Days

This epic voyage takes you on a journey beyond comparison, visiting enigmatic subantarctic islands and the Antarctic Peninsula. Similar to the South Georgia and Antarctic Odyssey, this trip features additional time in the Falklands~Malvinas to discover the fascinating history of the islands and encounter the spectacular birdlife found there. Delight in the presence of South Georgia's king penguin colonies, some of the largest on earth. Immerse yourself in the serene grandeur of the Antarctic Peninsula as you embrace the true spirit of exploration and adventure.

HIGHLIGHTS

- Photograph nesting black-browed albatross and spot rockhopper penguins in the Falklands~Malvinas
- Witness elephant seals in their natural habitat, including freshly weaned pups
- Soak up the rich history of the region with extra time in the Falklands~Malvinas
- Learn about wildlife, geology, glaciology, and the history of Antarctic exploration from our enthusiastic Expedition Team

DATES

Start/Finish	Duration	Dates	Voyage Code	Type of Voyage
Ushuaia/Ushuaia	21 Days	24 Oct '24–13 Nov '24	FSP005S	Sail
Ushuaia/Ushuaia 	21 Days	18 Dec '24–07 Jan '25	FSP006G	Sail
Ushuaia/Ushuaia	23 Days	27 Dec '25–18 Jan '26	FSP007G	Sail
Ushuaia/Ushuaia	22 Days	11 Mar '26–01 Apr '26	FSP008D	Sail

Voyage Codes: G = Greg Mortimer | S = Sylvia Earle | D = Douglas Mawson

This voyage operates in both a clockwise and anti-clockwise direction from Ushuaia. In the genuine spirit of expedition travel, this itinerary is only a guide and is subject to change due to weather, sea and other conditions beyond our control.

DAY OVERVIEW

1	Arrive in Ushuaia and transfer to your hotel.
2	Embark in Ushuaia.
3–4	Drake Passage crossing.
5–8	Over the next few days, you will be mesmerised by Antarctica. Zodiac-cruise amid iridescent grounded bergs, watching for whale blows from humpbacks, minkes and orca. Walk by plucky chinstrap and gentle gentoo penguins near bustling penguin colonies.
9–10	At sea.
11	At sea/South Georgia.
12–15	In South Georgia, take a moment to contemplate the world's largest king penguin colonies. Take care as you walk along bustling beaches, sharing the sand with fur seals, elephant seals and penguins. Photograph jaw-dropping landscapes and learn of Shackleton's epic tale of survival.
16–17	At sea.
18	At sea/Falklands~Malvinas.
19–20	Explore the windswept coastlines of the Falklands~Malvinas. This fascinating archipelago is home to Magellanic and rockhopper penguins, sea lions and the world's largest black-browed albatross colonies.
21	At sea.
22	Disembark in Ushuaia.

ACTIVITIES



Zodiac Cruises



Walks & Hikes



Photography



Expert Lectures



Polar Plunge



Birdwatching



Historical Sites



Citizen Science



Sea Kayaking



Snorkelling



Snowshoeing



Camping



Shackleton's Crossing



Paddling

*Optional activities available on select voyages, at additional cost. ^Only available on the Antarctic portion of the itinerary.



King penguins gathering beside a glacial stream, Salisbury Plain, South Georgia © R VAnson



This map is a guide only and is subject to change due to weather, sea state and other conditions beyond our control.



Hiking in Antarctica © M Seigal

In Shackleton's Footsteps

Antarctic Peninsula, Weddell Sea & South Georgia | 20 Days

Follow in the footsteps of 'The Boss' on this quintessential polar voyage, from the serene ice of the deep south to the subantarctic wildlife paradise of South Georgia. Experience the Antarctic Peninsula and set foot on the continent before making your way north to the spectacular Antarctic Sound, gateway to the Weddell Sea. Embrace the adventure as you voyage farther east, navigating as far as possible into the Weddell Sea, where Shackleton's *Endurance* met its fate. From here set a course to Elephant Island, the desolate outpost where Shackleton and his men finally made landfall after 497 days at sea. On the final leg of your voyage, follow the course of the *James Caird* across the Scotia Sea to South Georgia, where Shackleton's voyage reached its remarkable conclusion.

HIGHLIGHTS

- Learn about the fascinating history of Shackleton's *Endurance* expedition, including the 2022 discovery of the shipwreck
- Marvel at enormous tabular icebergs that escape the Weddell Sea into the Antarctic Sound, also known as 'Iceberg Alley'
- Hike from Fortuna Bay to Stromness, repeating the final leg of Shackleton's remarkable traverse of South Georgia (conditions permitting)

DATES

Start/Finish	Duration	Dates	Voyage Code	Type of Voyage
Ushuaia/Ushuaia	20 Days	16 Mar '25–04 Apr '25	ASH001G	Sail
Ushuaia/Ushuaia	20 Days	01 Nov '25–20 Nov '25	ASH002S	Sail

Voyage Codes: G = Greg Mortimer | S = Sylvia Earle | D = Douglas Mawson

[You can view the full itinerary on our website.](#) In the genuine spirit of expedition travel, this itinerary is only a guide and is subject to change due to weather, sea and other conditions beyond our control.

DAY	OVERVIEW
1	Arrive in Ushuaia and transfer to your hotel.
2	Embark in Ushuaia.
3–4	Cross the Drake Passage to the Antarctic Peninsula.
5–7	In Antarctica, Zodiac-cruise along spectacular ice cliffs amid iridescent grounded icebergs, keeping watch for whales, seals and porpoising penguins. While ashore, wander along pebbly beaches or perhaps up snow-covered ridgelines.
8	Embrace the expedition spirit as you forge your way as far as possible into the Weddell Sea. The Weddell Sea is renowned for its breathtaking tabular icebergs and expansive sea ice, which attracts an abundance of wildlife, including crabeater seals, Weddell seals, and seabirds.
9	Today we set a course for Elephant Island, the lonely outpost where 22 of Shackleton's men survived several winter months, sheltering under two upturned boats.
10–11	At sea.
12	At sea/South Georgia.
13–16	In South Georgia, marvel at some of the world's largest king penguin colonies. Walk along beaches brimming with fur seals, elephant seals and curious penguins. Photograph jaw-dropping landscapes, embark on exhilarating hikes and learn about Shackleton's epic tale of leadership and survival.
17–19	At sea.
20	Disembark in Ushuaia.

ACTIVITIES



Zodiac Cruises



Walks & Hikes



Photography



Expert Lectures



Polar Plunge



Birdwatching



Historical Sites



Citizen Science



Sea Kayaking



Paddling



Snorkelling



Shackleton's Crossing

*Optional activities available on select voyages, at additional cost. ^Only available on the Antarctic portion of the itinerary.

Patagonia

Embark on a voyage to one of the planet's greatest frontiers – Patagonia. Immerse yourself in visually spectacular and diverse landscapes, from glacial fronts to temperate rainforests, and search for fascinating Patagonian wildlife, including graceful guanacos, majestic pumas and dazzling Darwin's rheas.







Guanacos grazing, Patagonia © L. Cataldi



This map is a guide only and is subject to change due to weather, sea state and other conditions beyond our control.

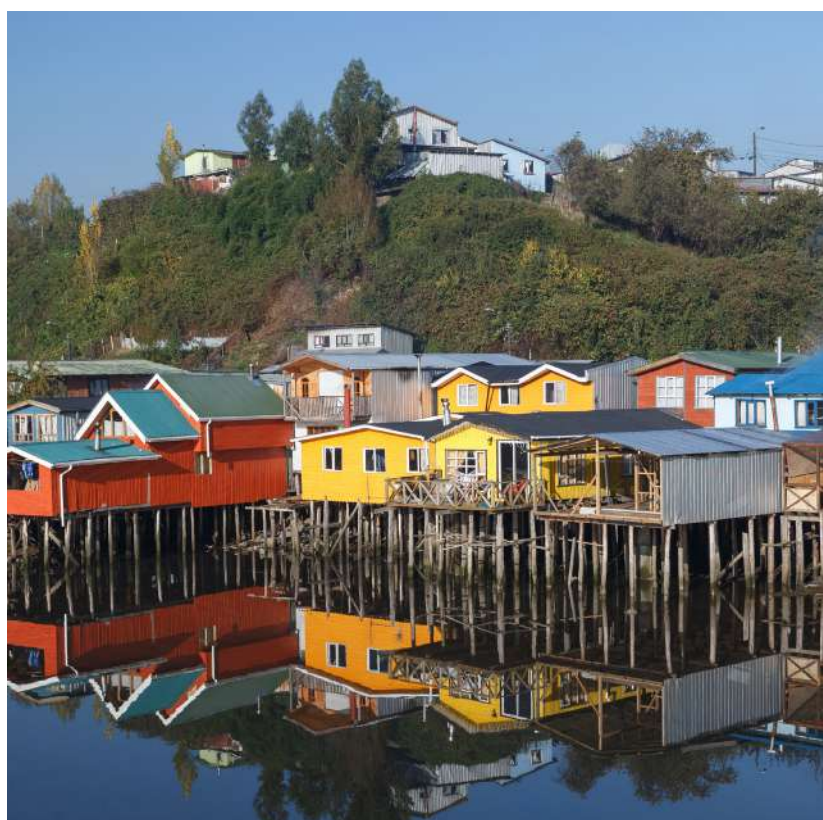

Houses on stilts in Castro, Patagonia

Patagonia & Chilean Fjords

Patagonia & Southern Chile | 15 Days

Sail the legendary Beagle Channel and marvel at the snow-covered peaks of rugged Patagonia. Zodiac-cruise through fjords flanked by glaciers and watch as the captain skilfully navigates narrow channels while you keep watch for acrobatic dolphins, penguins and seals. Spend two days hiking and exploring in Torres del Paine National Park, renowned for its majestic granite towers and jaw-dropping landscapes.

HIGHLIGHTS

- Search for marine wildlife in and around the waters of Francisco Coloane Marine Park, declared in 2003 as Chile's first marine conservation park
- Marvel in the dramatic landscape along a dazzling stretch of the famous Beagle Channel, called Glacier Alley
- Enjoy two days exploring the dramatic and rugged scenery of Torres del Paine National Park, famous for its granite towers

DATES

Start/Finish	Duration	Dates	Voyage Code	Type of Voyage
Ushuaia/ Puerto Montt	15 Days	27 Mar '26–10 Apr '26	PCF003S	Sail

Voyage Codes: G = Greg Mortimer | S = Sylvia Earle | D = Douglas Mawson

[You can view the full itinerary on our website.](#) In the genuine spirit of expedition travel, this itinerary is only a guide and is subject to change due to weather, sea and other conditions beyond our control.

DAY OVERVIEW

- 1–2** Overnight in Ushuaia before setting sail on Day 2.
- 3** Sail to Cape Horn, and perhaps enjoy a landing.
- 4–5** Cruise the Beagle Channel, soaking in breathtaking scenery along Glacier Alley and in hidden fjords.
- 6** Zodiac-cruise the wildlife-rich waters of Francisco Coloane Marine Park, enjoying the scenery while keeping watch for seabirds and dolphins.
- 7** Be out on deck to watch the captain skilfully navigate White Narrows to reach Puerto Natales.
- 8–9** Spend two days hiking in Torres del Paine National Park, renowned for its majestic granite towers, jaw-dropping landscape and unique wildlife. Enjoy an overnight hotel stay by the Serrano River.
- 10–11** We sail to a number of glaciers, including Pío XI, one of the only glaciers in Patagonia that is advancing rather than receding. We call into tiny coastal hamlets to meet locals who live an isolated existence from the rest of Chile.
- 12** Enjoy the spectacular scenery as we sail through the fjords and channels of northern Patagonia.
- 13** Spend time exploring the coastline of Tic Toc Bay, an area renowned for blue whales, marine mammals and seabirds.
- 14** Discover the charms of Castro, the capital of Chiloé Province, before visiting the World Heritage churches of the region.
- 15** Disembark in Puerto Montt.

ACTIVITIES



Zodiac Cruises



Walks & Hikes



Photography



Expert Lectures



Birdwatching



Historical Sites



Citizen Science



Sea Kayaking

*Optional activities available on select voyages, at additional cost.



Humpback whales, Yalour Islands, Antarctica © L Stock at Divergent Travelers



Torres del Paine National Park, Patagonia

ACTIVITIES

- | | | | | | | | | | | | |
|----------------|---------------|-------------|-----------------|--------------|--------------|------------------|-----------------|--------------|----------|-------------|--------------|
| | | | | | | | | | | | |
| Zodiac Cruises | Walks & Hikes | Photography | Expert Lectures | Polar Plunge | Birdwatching | Historical Sites | Citizen Science | Sea Kayaking | Paddling | Snorkelling | Scuba Diving |

*Optional activities available on select voyages, at additional cost. ^Only available on the Antarctic portion of the itinerary.

Antarctica & Patagonia Explorer

Combines ‘Antarctic Explorer’ + ‘Patagonia & Chilean Fjords’ | 25 Days

This new voyage combines the icy spectacle of Antarctica with the calm beauty of the Chilean Fjords. Start your journey with a flight to the South Shetland Islands and explore what wonders are on offer in the late summer season. You will certainly delight in the plentiful numbers of whales gathering in the icy sounds, not to mention the moulting penguins and inquisitive fledglings taking their first tentative steps into the sea. Skuas, terns and a suite of petrels wheel against a backdrop of spectacular sunsets as the days shorten and winter makes its gradual approach. Your adventure continues northwards through the stunning Chilean Fjords. As you pass craggy peaks, snow-covered mountains and waterfalls, spot the vast array of mammals and birdlife that call this region home.

HIGHLIGHTS

- Late season is the perfect time to bear witness to the sheer number of whales congregating in the region before beginning their migration north for the winter
- Combine the grandeur of Antarctica with the calm beauty of the Chilean Fjords, both offering unique wildlife and spectacular sights
- Spend a night in Torres del Paine National Park and maximise your hiking time over two action-packed days

DATES

Start/Finish	Duration	Dates	Voyage Code	Type of Voyage
Punta Arenas/Puerto Montt	25 Days	17 Mar '26–10 Apr '26	APC001S	Fly/Sail

Voyage Codes: G = Greg Mortimer | S = Sylvia Earle | D = Douglas Mawson

[You can view the full itinerary on our website.](#) In the genuine spirit of expedition travel, this itinerary is only a guide and is subject to change due to weather, sea and other conditions beyond our control.

* Please note that we are flying to and from one of the most remote places on earth. Safety is our utmost priority and we apologise in advance if any delays occur. Please refer to our terms and conditions for more details.

DAY	OVERVIEW
1	Arrive in Punta Arenas and transfer to your hotel.
2	Fly* to King George Island for embarkation.
3–9	Immerse yourself in the unforgettable landscapes of the white continent. In this great wilderness, nature sets our pace. Cruise by spectacular ice cliffs and observe seals on the ice, moulting penguins, and whales in large numbers in their southern feeding grounds. Discover historical sites and other intriguing relics scattered across the Peninsula.
10–11	Drake Passage crossing.
12	Explore Ushuaia with a short tour today.
13	Sail to Cape Horn, and perhaps enjoy a landing.
14–15	Cruise the Beagle Channel, soaking in breathtaking scenery along Glacier Alley and in hidden fjords.
16	Zodiac-cruise the wildlife-rich waters of Francisco Coloane Marine Park.
17	Be out on deck to watch the captain skilfully navigate White Narrows to reach Puerto Natales.
18–19	Spend two days hiking in Torres del Paine National Park, renowned for its majestic granite towers, jaw-dropping landscape and unique wildlife. Enjoy an overnight hotel stay by the Serrano River.
20–21	We sail to a number of glaciers, including Pío XI, one of the only glaciers in Patagonia that is advancing rather than receding. We call into tiny coastal hamlets to meet locals who live an isolated existence from the rest of Chile.
22	Enjoy the spectacular scenery as we sail through the fjords and channels of northern Patagonia.
23	Spend time exploring the coastline of Tic Toc Bay, an area renowned for blue whales, marine mammals and seabirds.
24	Discover the charms of Castro, the capital of Chiloé Province.
25	Disembark in Puerto Montt.



Zodiac-cruising around the Peltier Channel, Antarctica © P Harbour



This map is a guide only and is subject to change due to weather, sea state and other conditions beyond our control.



Hiking in Torres del Paine National Park, Patagonia © J Lafferty

ACTIVITIES



Zodiac Cruises



Walks & Hikes



Photography



Expert Lectures



Polar Plunge



Birdwatching



Historical Sites



Citizen Science



Paddling



Camping



Snowshoeing



Snorkelling

*Please note that for safety and operational reasons, participation in activities is dependent on participants meeting specific inclusion criteria, and the number of available slots within limited group sizes for each activity. All activities are subject to weather, ice, and other conditions.

^Only available on the Antarctic portion of the itinerary.

Trails of Antarctica & Patagonia

Combines an Antarctic expedition + 'Patagonia Discovery Trek' | From 23 Days

Adventure lovers can aim to tick two boxes off their bucket list with this unique expedition combining an Antarctic voyage with a trek through Chile and Argentina's Patagonian region. During your Antarctic portion, witness spectacular, towering cliffs and glittering icebergs, see playful penguins and seals, such as the leopard and crabeater, resting on ice floes. Then shake off your sea legs with a small-group trek, focusing on the natural wonder and stunning sights of Los Glaciares National Park and Torres del Paine National Park. With any luck, the curious local wildlife will welcome you to their adventure playground!

HIGHLIGHTS

- Marvel at some of the most dazzling icy landscapes on the peninsula
- Spot seals lounging on the sea ice
- Sit mesmerised by Nordenskjöld Lake, just one of the many azure lakes and milky tarns visited during the trek portion
- Enjoy fresh king crab in Puerto Natales, gateway to Torres del Paine National Park
- Enjoy close encounters with friendly guanacos

DATES

Start/Finish	Duration	Dates	Voyage Code	Type of Voyage
Ushuaia/Punta Arenas	25 days	20 Nov '25–14 Dec '25	VTC094G	Sail/Trek
Punta Arenas/Punta Arenas	23 days	17 Feb '26–11 Mar '26	VTC095S	Sail/Trek

Voyage Codes: G = Greg Mortimer | S = Sylvia Earle | D = Douglas Mawson

[You can view the full itinerary on our website.](#) This voyage also operates as Punta Arenas return beginning with a flight. Please check the itinerary of your chosen voyage for details.

In the genuine spirit of expedition travel, this itinerary is only a guide and is subject to change due to weather, sea and other conditions beyond our control.

DAY	OVERVIEW
1	Arrive in Ushuaia and transfer to your hotel.
2	Embark in Ushuaia.
3–4	Drake Passage crossing.
5–12	It is almost impossible to describe the feeling of arriving in Antarctica. Spotting your first iceberg and taking a deep breath of some of the freshest, crispest air on earth is an experience that will stay with you forever. Your experienced Expedition Team, who have made countless journeys to this area, will use their expertise to design your voyage from day to day, choosing the best options based on the prevailing weather and wildlife opportunities.
13–14	Drake Passage crossing.
15	Disembark in Ushuaia. Fly to El Calafate.
16	Gather with your fellow trekkers for a dinner tonight.
17	Visit Perito Moreno Glacier and drive to El Chalten.
18–19	Hike around the dramatic granite spires of Fitz Roy and Cerro Torre in Los Glaciares National Park.
20	Drive across the Pampas to Puerto Natales.
21	Travel by boat and Zodiac up the Serrano River towards Torres del Paine National Park.
22–23	Hike awe-inspiring trails in the wildlife-rich, world-renowned alpine region of Torres del Paine National Park.
24	Take in grand views of the Andes en route to Punta Arenas.
25	Depart Punta Arenas.

Discovery Voyages

Embarking on a discovery voyage brings you closer to the heart of nature, with an abundance of diverse excursions, hikes tailored to different levels, and a range of activities that encapsulate the authentic spirit of adventure, history and cultural immersion. At times, we venture off the beaten path, while on other occasions, we strike a balance between less and more populated areas, ensuring a well-rounded experience.



Australia: Tasmania

Explore the untamed beauty of Tasmania as you meander through tall eucalypt forests, marvel at ‘painted’ cliffs, and seek out the wildlife that calls it home – from wombats and Bennett’s wallabies to potoroos, pademelons and penguins. Discover historical bays and spectacular scenery as you forge lasting memories of this wild, remarkable land.







White sandy beach, Tasmania, Australia © Lone Wombat Media



This itinerary is a guide only and is subject to change due to permitting and regulatory approvals; and weather, sea state and other conditions beyond our control.

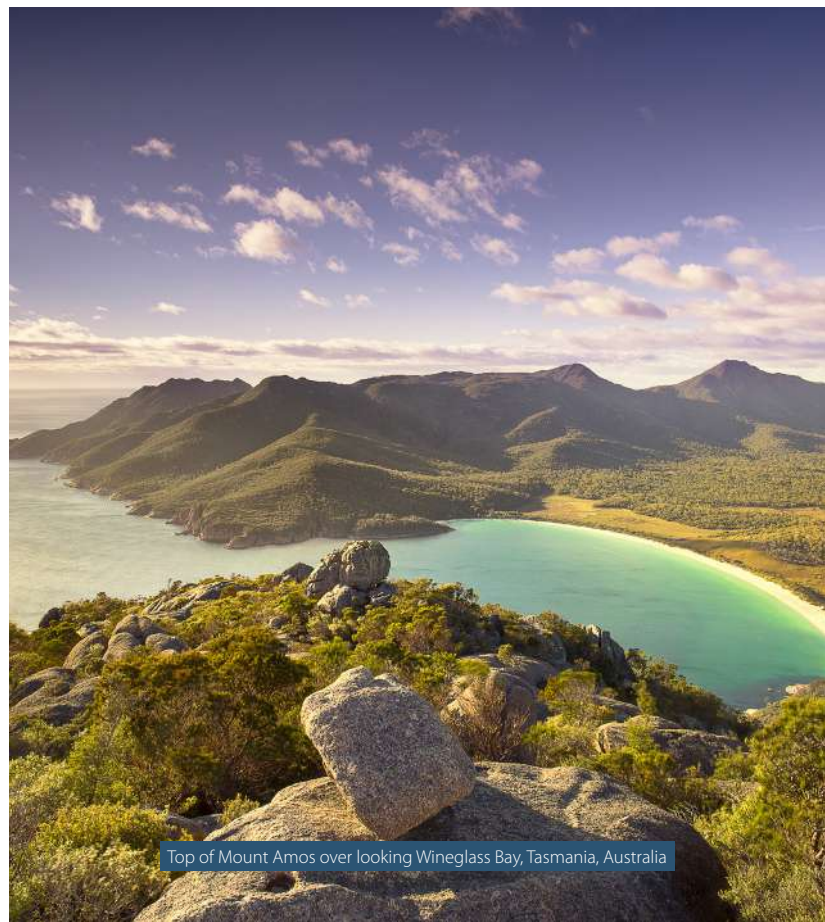

Top of Mount Amos over looking Wineglass Bay, Tasmania, Australia

NEW

Coastal Tasmania: Untamed Wilderness

Tasmania | 11 Days

Tread some of Tasmania's greatest trekking treasures by day and rejuvenate on your floating base camp each night. Explore wild coastlines and far-flung islands, land on secluded beaches, trek through pristine wilderness, and celebrate stunning vistas from towering peaks.

HIGHLIGHTS

- Explore some of Tasmania's best wilderness areas and wild offshore islands
- Marvel at the dramatic pink granite peaks, secluded bays and white sandy beaches in Freycinet
- Experience Maria Island's stunning landscapes and wildlife
- Explore Tasmania's most famous convict settlement at Port Arthur, combining an idyllic coastal setting with a brutal history

DATES

Start/Finish	Duration	Dates	Voyage Code	Type of Voyage
Hobart/Hobart	11 Days	1 Dec '25–11 Dec '25	TAS001D	Sail

Voyage Codes: G = Greg Mortimer | S = Sylvia Earle | D = Douglas Mawson

You can view the full itinerary on our website. This itinerary is a guide only and is subject to change due to **permitting and regulatory approvals**; and weather, sea state and other conditions beyond our control.



Flinders Island, Tasmania, Australia

DAY OVERVIEW

DAY	OVERVIEW
1	Arrive in Hobart and transfer to your hotel.
2	After embarkation, cruise past the impressive cliff scenery of Cape Pillar and Tasman Island's dramatic dolerite columns.
3	Make your first forays to the picturesque bays of Bruny Island and idyllic Recherche Bay near South East Cape.
4	Spy Australia's southernmost lighthouse on Maatsuyker Island before setting sail up Tasmania's wild west coast.
5	Explore the rich natural and human history of the Hunter Island Group and look to the skies to spot Australasian gannets.
6	Marvel at the mystique of the far-flung Kent Islands and discover its treasures – from seals to shipwrecks.
7	The striking shorelines, coastal bushland and rocky peaks of Flinders Island will entice beach strollers and energetic hikers alike.
8	Discover the pink granite peaks, dazzling white sands and azure waters of the Freycinet Peninsula.
9	On Maria Island, explore quiet bays and enjoy abundant wildlife.
10	Explore the World Heritage-listed Port Arthur Historic Site, the best-preserved convict site in Australia, and among the most significant convict era sites worldwide.
11	Toast your adventures at final night celebrations before disembarking in Hobart.

ACTIVITIES



Zodiac Cruises



Walks & Hikes



Photography



Expert Lectures



Birdwatching



Historical Sites



Citizen Science

Extend Your Adventure

Our diverse range of extension packages and treks allow you to really immerse yourself in the culture of your destination and provide more time to explore the local sights and sounds. Visit historical ruins, dine on irresistible local delicacies, stroll cobblestone streets, and take in the magnificent vistas and picturesque landscapes around you. They are the perfect opportunity to extend your adventure.





Guanacos in Torres del Paine National Park, Patagonia

Patagonia Discovery Trek

Los Glaciares & Torres del Paine | 10 Days

Discover the vast Patagonian wilderness on this unique guided walking trip, taking in two of Patagonia's most iconic national parks and the famed Perito Moreno Glacier. Hike rugged trails overlooking iridescent blue glacial lakes, as Andean condors soar overhead among the towering ice-capped peaks.

DAY OVERVIEW

1	Arrive in El Calafate.
2	Visit Perito Moreno Glacier and drive to El Chalten.
3-4	Hike around the dramatic granite spires of Fitz Roy and Cerro Torre in Los Glaciares National Park.
5	Drive across the Pampas to Puerto Natales.
6	Travel by boat and Zodiac up the Serrano River towards Torres del Paine National Park.
7-8	Hike awe-inspiring trails in the wildlife-rich, world-renowned alpine region of Torres del Paine National Park.
9	Take in the grand views of the Andes, en route to Punta Arenas.
10	Depart Punta Arenas.

You can view the full itinerary on our website. This trek operates in a reverse direction and also El Calafate roundtrip. Please refer to trek Trip Notes for details.

HIGHLIGHTS

- Take a stunning Zodiac cruise along Chile's Serrano River
- Be mesmerised by azure lakes and vibrant alpine tarns
- Enjoy close encounters with resident guanacos
- Trek to ice-capped Cerro Torre and Fitz Roy



DATES

Our treks operate on selected dates October–March

Please see price list for full details.



Taking photos, Torres del Paine National Park, Patagonia

Torres del Paine Explorer

Torres del Paine | 10 Days

Immerse yourself in the treasures of Chilean Patagonia. Discover the dramatic alpine scenery and fascinating wildlife of the Torres del Paine National Park with four full days of hiking with your local guide. Ascend through the Ascencio Valley along the renowned W Trek and take in the stunning views on the lesser known Lazo-Weber trail. Keep your eyes peeled for Andean condors, rheas, flamingos and guanacos.

DAY	OVERVIEW
1	Arrive in Punta Arenas.
2	Drive across the Pampas to Puerto Natales.
3	Travel by boat and Zodiac up the Serrano River towards Torres del Paine National Park.
4	Trek the spectacular Lazo-Weber trail.
5-8	Hike the famous W Trek to the base of the impressive Torres del Paine. Search for some of the local wildlife, include guanacos, flamingos and the elusive puma!
9	Take in grand views of the Andes, en route to Punta Arenas.
10	Depart Punta Arenas.

You can view the full itinerary on our website. In the genuine spirit of expedition travel, this itinerary is only a guide and is subject to change due to weather, sea and other conditions beyond our control.

HIGHLIGHTS

- Experience the exquisite Ascencio Valley on the W Trek, up to the soaring granite Towers of Paine
- Trek beautiful trails in the French Valley and Villa Serrano
- Be mesmerised by azure lakes and vibrant alpine tarns



DATES

Our treks operate on selected dates January–March

Please see price list for full details.



Extend Your Adventure in Latin America

From the vibrant cities of Santiago and Buenos Aires to the spectacular natural wonders of Iguazu Falls and Patagonia, Latin America offers something for everyone. Dazzling natural beauty, diverse cultures, rich traditions, fascinating colonial history and tantalising cuisine are just a few of the many experiences you will encounter in this region. Visit the website for the pricing details.



Scan the QR to see our full list of our extension tours



Patagonia EcoCamp

+ 5 Days, 4 Nights

Uniquely Patagonian, the Cascada EcoCamp offers an environmentally friendly way to experience nature in comfort. Spend your days exploring Torres del Paine National Park through various short walks or a drive through the park, showcasing views of Nordenskjöld Lake and Lake Pehoe, and take a delightful evening cruise across glacial Grey Lake.

Atacama Desert Adventure

+ 4 Days, 3 Nights

The Atacama Desert is the driest desert in the world. Customise your itinerary from a selection of activities that best suit your needs. From Valle de la Luna (Moon Valley) to salt flats where flamingos roam, or a geothermal field of steaming geysers, the choice is yours.



Buenos Aires & Iguazu Falls Explorer

+ 6 Days, 5 Nights

Combining metropolitan culture with dazzling nature, this is an ideal stopover before or after your Antarctic voyage. Argentina's capital is synonymous with tango, football fever, world-class cuisine, and political passion. Iguazu Falls is an extraordinary natural wonder that you must experience.



Santiago & Valparaiso Explorer

+ 6 Days, 5 Nights

In a valley surrounded by the Andes, Santiago is an easy stopover that offers superb scenery and local cuisine. In Valparaiso, a UNESCO World Heritage Site, explore the vineyards and behold the creative energy of vibrant street art, and panoramic views of the Pacific Ocean.



Taste of Santiago

+ 4 Days, 3 Nights

A major gateway to South America and popular stopover city, Chile's capital offers spectacular views of the high Andean peaks to the east. Visit the main attractions and important cultural, cosmopolitan and artistic sights on a full-day guided cultural tour. Sample some of the culinary delights and specialties the region has to offer.



Taste of Buenos Aires

+ 4 Days, 3 Nights

Located on the banks of the Rio de la Plata, Buenos Aires is one of the largest cosmopolitan cities in Latin America, a major world port and Argentina's commercial and social centre. Buenos Aires is graced with elegant European architecture and a renowned cultural scene, including world-class street art, iconic tango, and superb wine and cuisine.

Antarctic Wildlife Encounters

Bird Species	Drake Passage	Antarctic Peninsula	Antarctica (Below the Circle)	South Georgia & South Sandwich Islands/South Orkneys	Falklands ~Malvinas	East Antarctica
King Penguin				•••	•	
Gentoo Penguin		•••		••	••	
Adélie Penguin		••	•••			••
Chinstrap Penguin		••	•	•		
Macaroni/Royal Penguin		•		••		
Rockhopper Penguin				•	••	
Magellanic Penguin					••	
Emperor Penguin						•
Wandering Albatross	••			•••	••	
Royal Albatross	••				•	
Black-browed Albatross	•••	•		•••	•••	
Grey-headed Albatross	••			••	••	
Light-mantled Albatross	•			••		
Southern Giant Petrel	•••	••	•	•••	••	•
Northern Giant Petrel	•••	•		••	••	
White-chinned Petrel	•			••	••	
Southern Fulmar	••	••	•	•		•
Cape Petrel	•••	•••	•	•	•	•
Antarctic Petrel	•	•	•	•		•
Snow Petrel		••	••			••
South Georgia Diving Petrel				•••		
Blue Petrel	••			•	•	•
Diving Petrel	••			•	•	
Wilson's Storm Petrel	•••	•••	•••	••	••	••
Black-bellied Storm Petrel	••					
Antarctic Prion	•••			••		
Sooty Shearwater	•					
Sheathbill		•••		•••	•	
Subantarctic Skua		•••		•••		
South Polar Skua		••	••			••
Kelp Gull		••		•••	••	
Antarctic Tern	•	•••	••	•••		



Leopard seal, Pleneau Island, Antarctica © A Włodarczyk

Bird Species (cont.)	Drake Passage	Antarctic Peninsula	Antarctica (Below the Circle)	South Georgia & South Sandwich Islands/South Orkneys	Falklands ~Malvinas	East Antarctica
Arctic Tern	●	●●	●	●●		
South American Tern	●				●●	
Imperial Cormorant	●				●●●	
Antarctic Cormorant		●●●				
South Georgia Cormorant				●●		
Rock Cormorant					●	
Kelp Goose					●	
South Georgia Pintail				●●		
Falkland Steamer Duck					●●	
Turkey Vulture					●	
South Georgia Pipit				●●●		
Mammal Species	Drake Passage	Antarctic Peninsula	Antarctica (Below the Circle)	South Georgia & South Sandwich Islands/South Orkneys	Falklands ~Malvinas	East Antarctica
Humpback Whale	●	●●●	●●	●	●	●●
Antarctic Minke Whale	●	●●	●●			●●
Sei Whale	●	●		●		
Fin Whale	●	●	●	●		●
Blue Whale	●					
Killer Whale (Orca)		●	●	●	●	●
Hourglass Dolphin	●				●	
Commerson's Dolphin					●	
Peale's Dolphin	●				●	
Leopard Seal		●●	●●	●		●
Weddell Seal		●●	●●			●●
Crabeater Seal		●●●	●●●			●●
Southern Elephant Seal		●		●●●	●●	
Antarctic Fur Seal		●●	●●	●●●		
South American Sea Lion					●●	

Key:

● Occasionally seen

●● Might see

●●● Likely to see

Douglas Mawson

Deck Plan

Ship Features

- ① Change room/mudroom
- ② Zodiac access points
- ③ Activity launching platform
- ④ Lecture room & lounge
- ⑤ Assembly station
- ⑥ Reception
- ⑦ Ship shop
- ⑧ Dining room
- ⑨ Library
- ⑩ Gym
- ⑪ Sauna
- ⑫ Seating area
- ⑬ Observation lounge
- ⑭ Top-deck restaurant
- ⑮ Bar
- ⑯ Upper glass atrium lounge
- ⑰ Lower glass atrium lounge
- ⑱ Observation decks
- ⑲ Swimming pool* and sun deck
- ⑳ Jacuzzis
- ㉑ Medical clinic
- ㉒ Bridge
- ㉓ Elevator
- ㉔ Main entrance
- ㉕ Expedition desk
- ㉖ Citizen Science centre
- ♿ Disability accessible staterooms

↔ Connecting staterooms and suites

*Swimming pool not operational when sailing in open waters. Hours of operation subject to weather conditions.

Deck plan is subject to change.

Stateroom Category

- Aurora Stateroom Single
- Balcony Stateroom – B
- Aurora Stateroom Superior Single
- Balcony Stateroom – A
- Aurora Stateroom Twin
- Balcony Stateroom Superior
- Aurora Stateroom Triple
- Junior Suite
- Aurora Stateroom Superior
- Captain's Suite
- Balcony Stateroom – C

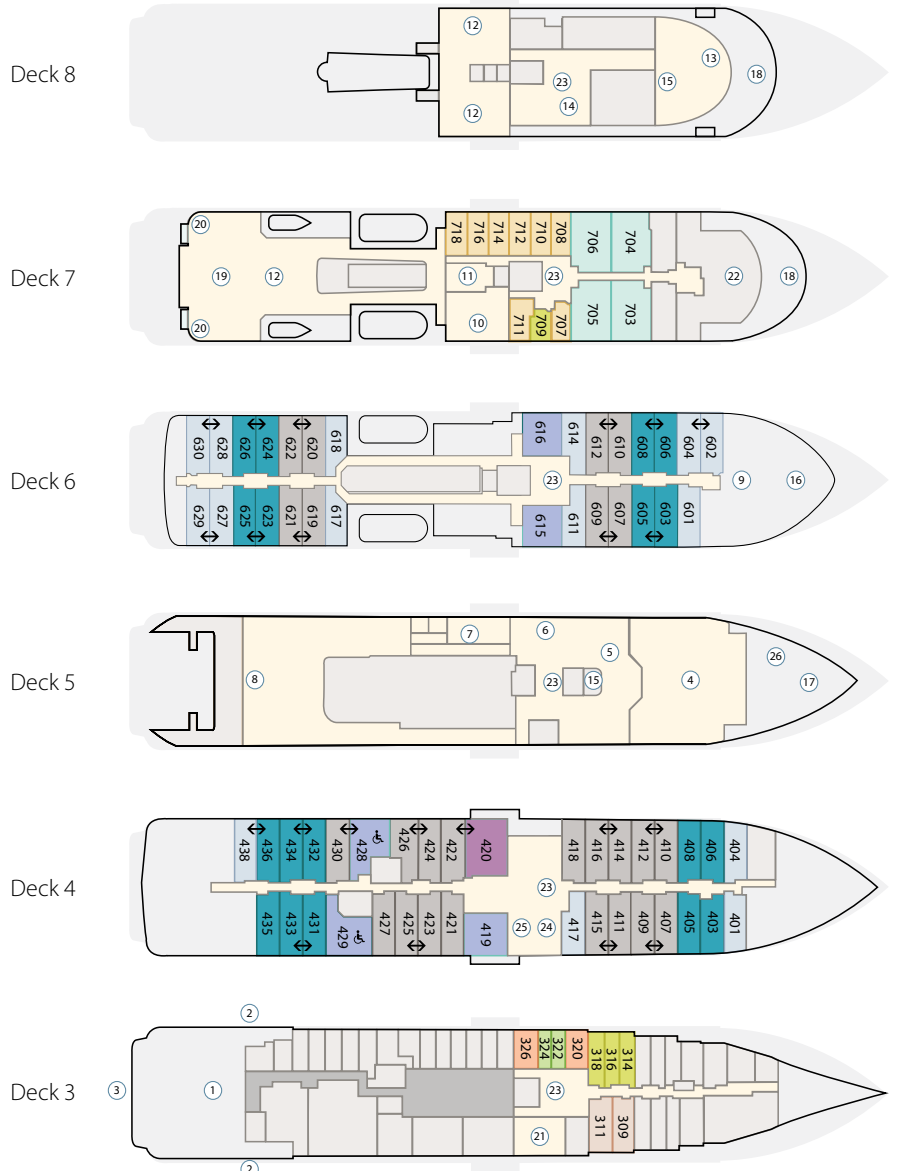

Staterooms & Suites Layout

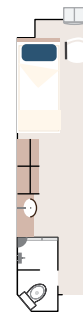

Aurora Stateroom Single

Stateroom 9.85m² (106.0ft²), porthole and bathroom.

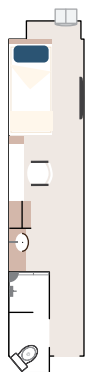

Aurora Stateroom Superior Single

Deck 3 Stateroom 15.18m² (163.4ft²), Porthole and bathroom. Deck 7 Stateroom 10.97m² (118.1ft²), French Balcony and bathroom.

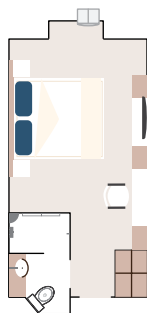

Aurora Stateroom Twin

Stateroom 15.37m²–15.97m² (165.4ft²–171.91ft²), porthole and bathroom.



Aurora Stateroom Triple

Stateroom 22.57m² (242.9ft²), porthole and bathroom.

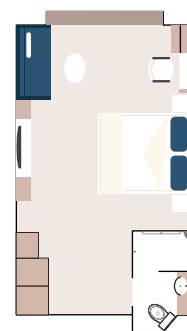

Aurora Stateroom Superior

Stateroom up to 13.97m² – 16.17m² (150.4ft² – 174.1ft²), French balcony and bathroom.

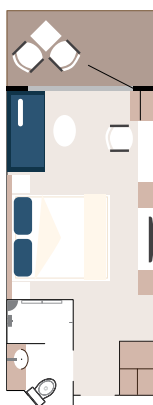

Balcony Stateroom

Stateroom and private balcony combined size 21.07m² – 26.77m² (226.8ft² – 288.2ft²), balcony and bathroom.

For stateroom sizes in categories A, B and C please contact us.

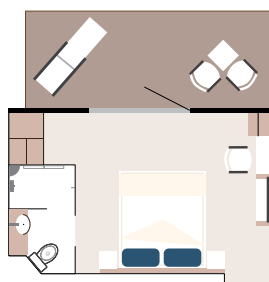

Balcony Stateroom Superior

Stateroom and private balcony combined size 27.77m² – 36.27m² (298.9ft² – 390.4ft²), balcony and bathroom.

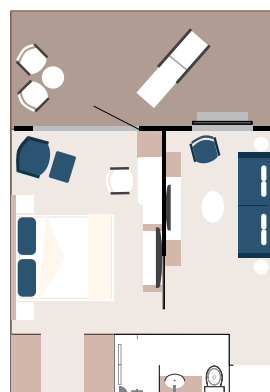

Junior Suite

Stateroom and private balcony combined size up to 41.47m²– 41.87m² (446.4ft² – 450.7ft²), balcony, bathroom and lounge.

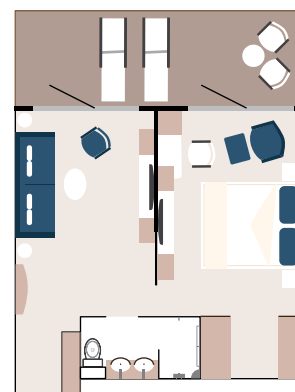

Captain's Suite

Stateroom and private balcony combined size 45.22m² (486.71ft²), balcony, bathroom and lounge.

*Layouts are a guide only, the cabin configuration may vary dependent on the location of the cabin on the ship.

Sylvia Earle

Deck Plan

Ship Features

- ① Change room/mudroom
- ② Zodiac access points
- ③ Activity launching platform
- ④ Lecture room & lounge
- ⑤ Assembly station
- ⑥ Reception
- ⑦ Ship shop
- ⑧ Dining room
- ⑨ Library
- ⑩ Gym
- ⑪ Wellness centre/sauna
- ⑫ Seating area
- ⑬ Observation lounge
- ⑭ Top-deck restaurant
- ⑮ Bar
- ⑯ Upper glass atrium lounge
- ⑰ Lower glass atrium lounge
- ⑱ Observation decks
- ⑲ Swimming pool* and sun deck
- ⑳ Jacuzzis
- ㉑ Medical clinic
- ㉒ Bridge
- ㉓ Elevator
- ㉔ Main entrance
- ㉕ Expedition desk
- ㉖ Citizen Science centre
- ♿ Disability accessible staterooms

↔ Connecting staterooms and suites

*Swimming pool not operational when sailing in open waters. Hours of operation subject to weather conditions.

Deck plan is subject to change.

Stateroom Category

- Aurora Stateroom Triple
- Balcony Stateroom – A
- Aurora Stateroom Superior
- Balcony Stateroom Superior
- Balcony Stateroom – C
- Junior Suite
- Balcony Stateroom – B
- Captain's Suite

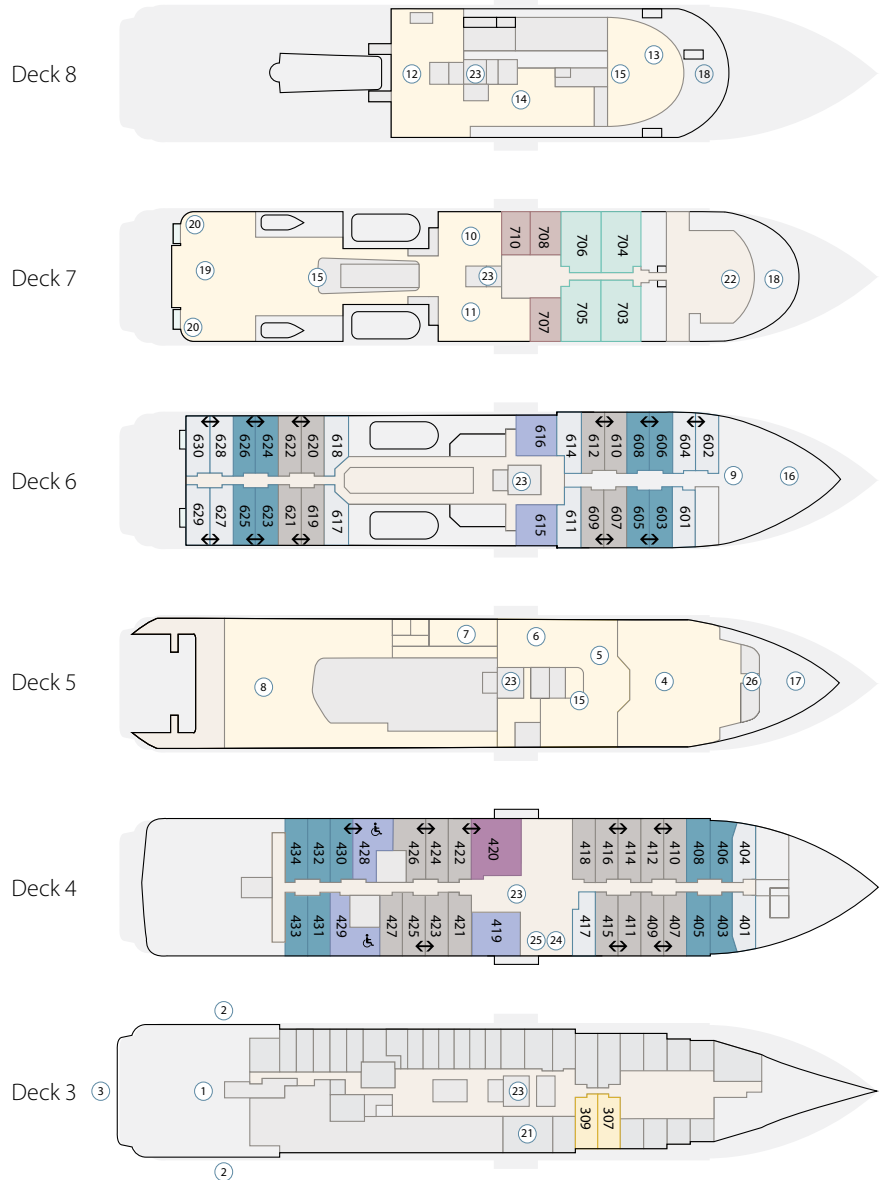

Staterooms & Suites Layout

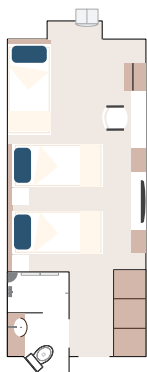

Aurora Stateroom Triple

Stateroom 22.67m² (244ft²), porthole and bathroom.

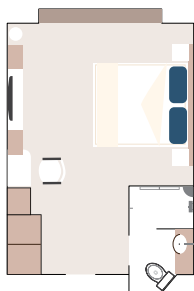

Aurora Stateroom Superior

Stateroom up to 19.9m² – 20.8m² (214.2ft² – 223.9ft²), French balcony and bathroom.

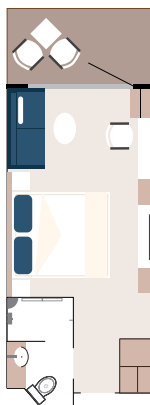

Balcony Stateroom

Stateroom and private balcony combined size 16.8m² – 28m² (209.9ft² – 308.9ft²), balcony and bathroom. For stateroom sizes in categories A, B and C please contact us.

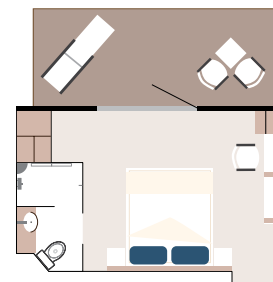

Balcony Stateroom Superior

Stateroom and private balcony combined size 29.2m² – 35.2m² (314.3ft² – 378.9ft²), balcony and bathroom.

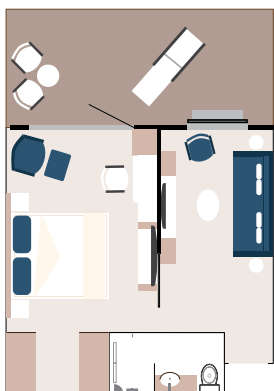

Junior Suite

Stateroom and private balcony combined size up to 41.6m² (447.8ft²), balcony, bathroom and lounge.

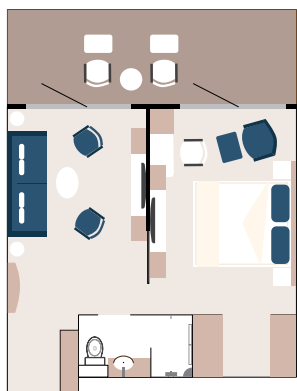

Captain's Suite

Stateroom and private balcony combined size 43.8m² (471.5ft²), balcony, bathroom and lounge.



*Layouts are a guide only, the cabin configuration may vary dependent on the location of the cabin on the ship.

Greg Mortimer

Deck Plan

Ship Features

- ① Change room/mudroom
- ② Zodiac access points
- ③ Activity launching platform
- ④ Lecture room & lounge
- ⑤ Assembly station
- ⑥ Reception
- ⑦ Ship shop
- ⑧ Dining room
- ⑨ Tuscan Grill dining room
- ⑩ Library
- ⑪ Gym
- ⑫ Wellness centre/sauna
- ⑬ Sun deck
- ⑭ Observation lounge
- ⑮ Top deck
- ⑯ Bars
- ⑰ Viewing platforms
- ⑱ Hydraulic viewing platforms
- ⑲ Observation decks
- ⑳ Jacuzzis
- ㉑ Medical clinic
- ㉒ Elevator
- ㉓ Bridge
- ㉔ Main entrance
- ㉕ Expedition desk
-  Disability accessible staterooms

Stateroom Category

- Aurora Stateroom Triple
- Balcony Stateroom – A
- Aurora Stateroom Twin
- Balcony Stateroom Superior
- Balcony Stateroom – C
- Junior Suite
- Balcony Stateroom – B
- Captain's Suite

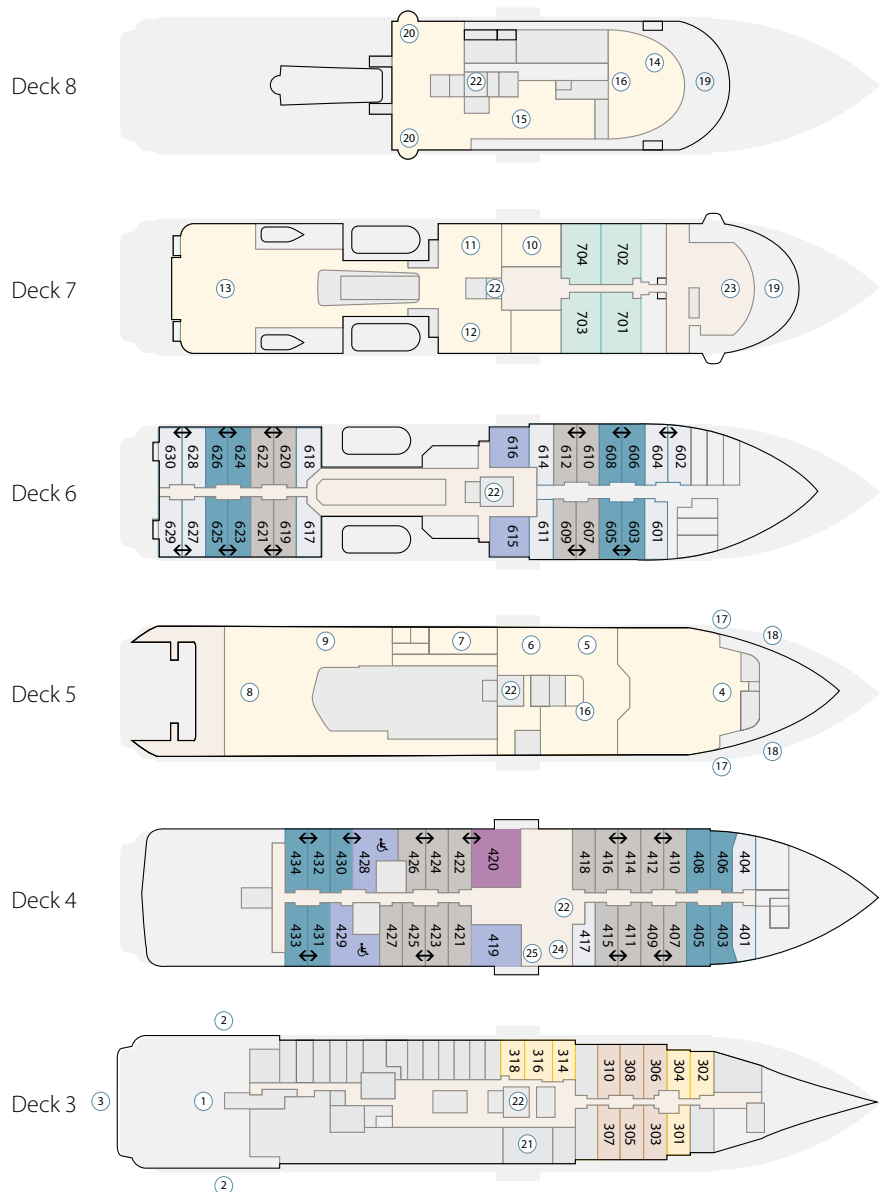

↔ Connecting staterooms and suites
 Deck plan is subject to change.

Staterooms & Suites Layout

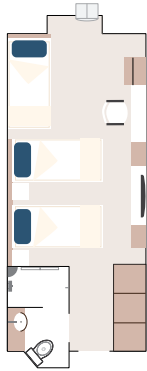

Aurora Stateroom Triple

Stateroom 21.4m²–22.8m² (230.34ft²–245.41ft²), porthole and bathroom.

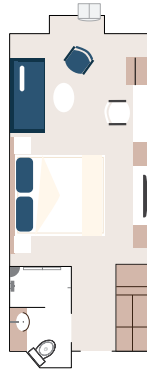

Aurora Stateroom Twin

Stateroom 15.8m²–22.8m² (170ft²–245.41ft²), porthole and bathroom.

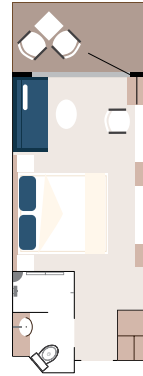

Balcony Stateroom

Stateroom and private balcony combined size 20.9m²–31.3m² (224.96ft²–301.39ft²), balcony and bathroom. For stateroom sizes in categories A, B and C, please contact us.

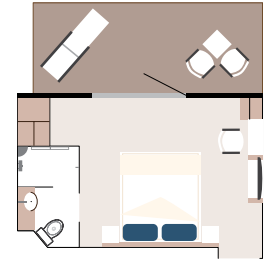

Balcony Stateroom Superior

Stateroom and private balcony combined size 30.5m²–40.2m² (303.54ft²–432.70ft²) balcony and bathroom.

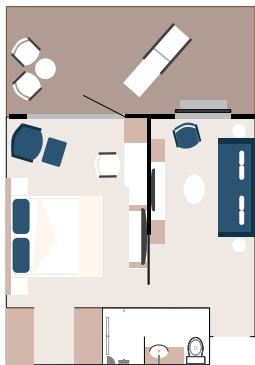

Junior Suite

Stateroom and private balcony combined size 38.9m² (418.71ft²), balcony, bathroom and lounge.

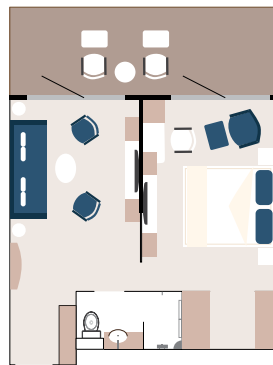

Captain's Suite

Stateroom and private balcony combined size 44.5m² (478.99ft²), balcony, bathroom and lounge.



*Layouts are a guide only, the cabin configuration may vary dependent on the location of the cabin on the ship.

What's Included

Whether it is an expedition jacket to keep, charter flights or pre-/post-voyage accommodation, our inclusions are what most others would consider extras. For a full list of inclusions on each voyage, please view the itinerary page on our website.

Pre-/Post-Voyage

- Pre-voyage accommodation
- Airport transfers
- Pre-voyage sightseeing*
- Charter flights*

On Board

- Shore excursions
- Free Starlink Wi-Fi
- Professional photographer on every voyage
- Use of Muck Boots during voyage
- House drinks with dinner
- 3-in-1 waterproof expedition jacket
- Port charges, permits and landing fees

*Available on selected voyages as specified in the itinerary.





Paradise Bay, Antarctica © A Włodarczyk

Ross Sea & East Antarctica (USD)

— Ross Sea, Commonwealth Bay, New Zealand's Subantarctic Islands

YEAR	VOYAGES	SHIP	CODE	DAYS	DATES	START-FINISH	AURORA STATEROOM SINGLE	AURORA STATEROOM SUPERIOR SINGLE	AURORA STATEROOM TRIPLE	AURORA STATEROOM TWIN
25/26	Mawson's Antarctica - NEW (Christmas & New Year)	Douglas Mawson	MAW009D	24	11 Dec–03 Jan	HBA–DUD	US\$36,895	US\$40,495	US\$30,595	US\$31,495
2026	Subantarctic Discovery - NEW	Douglas Mawson	SUB001D	15	02 Jan–16 Jan	DUD–DUD	US\$18,395	US\$20,195	US\$15,295	US\$15,695
2026	Ross Sea Odyssey - NEW	Douglas Mawson	ROS001D	25	16 Jan–09 Feb	DUD–DUD	US\$37,895	US\$41,595	US\$31,495	US\$32,395
2026	Epic Antarctica: Crossing the 7th Continent - NEW	Douglas Mawson	ASC001D	34	08 Feb–12 Mar	DUD–USH	US\$51,295	US\$56,295	US\$42,495	US\$43,795

KEY: HBA - Hobart, Australia, DUD - Dunedin, New Zealand, USH - Ushuaia, Argentina

Antarctica (USD)

— Antarctic Peninsula, South Georgia & Falklands~Malvinas

YEAR	VOYAGES	SHIP	CODE	DAYS	DATES	START-FINISH	AURORA STATEROOM SINGLE	AURORA STATEROOM SUPERIOR SINGLE	AURORA STATEROOM TRIPLE	AURORA STATEROOM TWIN
2024	Falklands, South Georgia & Antarctic Peninsula	Sylvia Earle	FSP005S	21	24 Oct–13 Nov	USH–USH	N/A	N/A	US\$24,295	N/A
2024	Spirit of Antarctica	Greg Mortimer	ANP168G	12	27 Oct–07 Nov	USH–USH	N/A	N/A	US\$12,795	US\$13,195
2024	Antarctic Peninsula in Depth	Greg Mortimer	APD003G	15	06 Nov–20 Nov	USH–USH	N/A	N/A	US\$16,595	US\$17,095
2024	Spirit of Antarctica	Sylvia Earle	ANP169S	12	12 Nov–23 Nov	USH–USH	N/A	N/A	US\$13,695	N/A
2024	South Georgia, Falklands & Antarctic Odyssey	Greg Mortimer	ASG092G	21	19 Nov–09 Dec	USH–USH	N/A	N/A	US\$26,095	US\$26,895
2024	Spirit of Antarctica	Sylvia Earle	ANP170S	12	22 Nov–03 Dec	USH–USH	N/A	N/A	US\$14,395	N/A
2024	South Georgia, Falklands & Antarctic Odyssey	Sylvia Earle	ASG093S	21	02 Dec–22 Dec	USH–USH	N/A	N/A	US\$26,795	N/A
2024	Spirit of Antarctica	Greg Mortimer	ANP171G	12	08 Dec–19 Dec	USH–USH	N/A	N/A	US\$14,995	US\$15,395
24/25	Falklands, South Georgia & Antarctic Peninsula (Christmas & New Year)	Greg Mortimer	FSP006G	21	18 Dec–07 Jan	USH–USH	N/A	N/A	US\$28,595	US\$29,395
24/25	Across the Antarctic Circle (Christmas & New Year)	Sylvia Earle	ANC010S	14	21 Dec–03 Jan	USH–USH	N/A	N/A	US\$17,995	N/A
2025	South Georgia, Falklands & Antarctic Odyssey	Sylvia Earle	ASG094S	20	02 Jan–21 Jan	USH–PUQ	N/A	N/A	US\$28,895	N/A
2025	Spirit of Antarctica	Greg Mortimer	ANP172G	12	06 Jan–17 Jan	USH–USH	N/A	N/A	US\$15,595	US\$15,995
2025	Across the Antarctic Circle	Greg Mortimer	ANC011G	13	16 Jan–28 Jan	USH–PUQ	N/A	N/A	US\$17,595	US\$18,095
2025	Antarctic Explorer	Sylvia Earle	AEP046S	13	19 Jan–31 Jan	PUQ–USH	N/A	N/A	US\$19,895	N/A
2025	Antarctic Explorer	Greg Mortimer	AEP047G	13	26 Jan–07 Feb	PUQ–USH	N/A	N/A	US\$19,895	US\$20,495
2025	Antarctica Complete	Sylvia Earle	ACO005S	23	30 Jan–21 Feb	USH–USH	N/A	N/A	US\$31,495	N/A
2025	Antarctic Explorer	Greg Mortimer	AEP048G	13	12 Feb–24 Feb	PUQ–USH	N/A	N/A	US\$19,295	US\$19,795
2025	Antarctic Explorer	Sylvia Earle	AEP049S	12	20 Feb–03 Mar	USH–PUQ	N/A	N/A	US\$17,195	N/A
2025	Across the Antarctic Circle	Greg Mortimer	ANC012G	13	23 Feb–07 Mar	USH–USH	N/A	N/A	US\$16,195	US\$16,695

KEY: USH - Ushuaia, Argentina, PUQ - Punta Arenas, Chile

AURORA STATEROOM SUPERIOR	BALCONY STATEROOM C	BALCONY STATEROOM B	BALCONY STATEROOM A	BALCONY STATEROOM SUPERIOR	JUNIOR SUITE	CAPTAIN'S SUITE	OPTIONAL ACTIVITIES
US\$33,295	US\$34,195	US\$35,995	US\$38,695	US\$42,295	US\$53,095	US\$62,995	Sea Kayaking - US\$1,330
US\$16,595	US\$17,095	US\$17,995	US\$19,295	US\$21,095	US\$26,495	US\$31,395	N/A
US\$34,195	US\$35,195	US\$36,995	US\$39,795	US\$43,495	US\$54,595	US\$64,695	Sea Kayaking - US\$1,330
US\$46,295	US\$47,495	US\$49,995	US\$53,795	US\$58,795	US\$73,795	US\$87,495	Sea Kayaking - US\$1,745

AURORA STATEROOM SUPERIOR	BALCONY STATEROOM C	BALCONY STATEROOM B	BALCONY STATEROOM A	BALCONY STATEROOM SUPERIOR	JUNIOR SUITE	CAPTAIN'S SUITE	OPTIONAL ACTIVITIES
US\$26,495	US\$27,195	US\$28,595	US\$30,795	US\$33,595	US\$42,195	US\$49,995	Sea Kayaking - US\$1,745, Snowshoeing - US\$440, Camping - US\$165 Shackleton's Crossing on Skis - US\$2,220
N/A	US\$14,295	US\$15,095	US\$16,195	US\$17,695	US\$22,195	US\$26,295	Sea Kayaking - US\$1,330, Camping - US\$165, Snowshoeing - US\$370, Ski/Snowboard Touring - US\$1,395
N/A	US\$18,595	US\$19,495	US\$20,995	US\$22,995	US\$28,795	US\$34,195	Sea Kayaking - US\$1,330, Camping - US\$165, Snowshoeing - US\$370, Ski/Snowboard Touring - US\$1,395
US\$14,895	US\$15,295	US\$16,095	US\$17,295	US\$18,895	US\$23,795	US\$28,195	Sea Kayaking - US\$1,330, Scuba Diving - US\$1,295, Camping - US\$165, Snowshoeing - US\$370
N/A	US\$29,195	US\$30,695	US\$32,995	US\$36,095	US\$45,295	US\$53,695	Sea Kayaking - US\$1,745, Snowshoeing - US\$440, Camping - US\$165, Shackleton's Crossing on Foot - US\$2,220
US\$15,595	US\$16,095	US\$16,895	US\$18,195	US\$19,895	US\$24,895	US\$29,595	Sea Kayaking - US\$1,330, Snorkelling - US\$675, Scuba Diving - US\$1,295, Camping - US\$165
US\$29,195	US\$29,995	US\$31,495	US\$33,895	US\$37,095	US\$46,495	US\$55,195	Sea Kayaking - US\$1,745, Snorkelling - US\$835, Camping - US\$165, Snowshoeing - US\$440
N/A	US\$16,795	US\$17,595	US\$18,895	US\$20,695	US\$25,995	US\$30,795	Sea Kayaking - US\$1,330, Camping - US\$165, Snowshoeing - US\$370, Alpine Trekking - US\$1,260
N/A	US\$31,995	US\$33,595	US\$36,195	US\$39,495	US\$49,595	US\$58,795	Sea Kayaking - US\$1,745, Snorkelling - US\$835, Camping - US\$165, Snowshoeing - US\$440
US\$19,595	US\$20,095	US\$21,195	US\$22,795	US\$24,895	US\$31,195	US\$36,995	Sea Kayaking - US\$1,330, Snorkelling - US\$675, Snowshoeing - US\$370
US\$31,495	US\$32,295	US\$33,995	US\$36,595	US\$39,995	US\$50,195	US\$59,495	Sea Kayaking - US\$1,745, Snorkelling - US\$835, Paddling - US\$640
N/A	US\$17,395	US\$18,295	US\$19,695	US\$21,495	US\$26,995	US\$31,995	Sea Kayaking - US\$1,330, Snorkelling - US\$675, Paddling - US\$640
N/A	US\$19,695	US\$20,695	US\$22,295	US\$24,295	US\$30,495	US\$36,195	Sea Kayaking - US\$1,330, Snorkelling - US\$675, Paddling - US\$640
US\$21,695	US\$22,295	US\$23,495	US\$25,195	US\$27,495	US\$34,595	US\$40,995	Sea Kayaking - US\$1,330, Snorkelling - US\$675, Paddling - US\$640
N/A	US\$22,295	US\$23,495	US\$25,195	US\$27,495	US\$34,595	US\$40,995	Sea Kayaking - US\$1,330, Snorkelling - US\$675, Paddling - US\$640
US\$34,295	US\$35,195	US\$37,095	US\$39,895	US\$43,595	US\$54,695	US\$64,895	Sea Kayaking - US\$1,745, Snorkelling - US\$835, Paddling - US\$640
N/A	US\$21,495	US\$22,695	US\$24,395	US\$26,595	US\$33,395	US\$39,595	Sea Kayaking - US\$1,330, Snorkelling - US\$675, Paddling - US\$640
US\$18,695	US\$19,195	US\$20,195	US\$21,695	US\$23,695	US\$29,795	US\$35,295	Sea Kayaking - US\$1,330, Snorkelling - US\$675, Paddling - US\$640
N/A	US\$18,095	US\$18,995	US\$20,495	US\$22,395	US\$27,995	US\$33,295	Sea Kayaking - US\$1,330, Snorkelling - US\$675, Paddling - US\$640

Antarctica (USD)

— Antarctic Peninsula, South Georgia & Falklands~Malvinas

YEAR	VOYAGES	SHIP	CODE	DAYS	DATES	START-FINISH	AURORA STATEROOM SINGLE	AURORA STATEROOM SUPERIOR SINGLE	AURORA STATEROOM TRIPLE	AURORA STATEROOM TWIN
2025	Antarctic Explorer <i>featuring</i> the Chilean Fjords	<i>Sylvia Earle</i>	AEP050S	14	01 Mar–14 Mar	PUQ–PUQ	N/A	N/A	US\$18,795	US\$20,395
2025	Wild Antarctica <i>featuring</i> the Weddell Sea	<i>Greg Mortimer</i>	ANW008G	12	06 Mar–17 Mar	USH–USH	N/A	N/A	US\$14,295	N/A
2025	Spirit of Antarctica <i>featuring</i> the Chilean Fjords	<i>Sylvia Earle</i>	ANP173S	13	13 Mar–25 Mar	PUQ–USH	N/A	N/A	US\$14,695	US\$15,995
2025	In Shackleton's Footsteps	<i>Greg Mortimer</i>	ASH001G	20	16 Mar–04 Apr	USH–USH	N/A	N/A	US\$22,595	N/A
2025	Wild Antarctica <i>featuring</i> the Weddell Sea	<i>Sylvia Earle</i>	ANW009S	12	24 Mar–04 Apr	USH–USH	N/A	N/A	US\$13,395	US\$14,595
2025	South Georgia, Falklands & Antarctic Odyssey	<i>Greg Mortimer</i>	ASG095G	21	22 Oct–11 Nov	USH–USH	N/A	N/A	US\$25,495	US\$26,195
2025	In Shackleton's Footsteps	<i>Sylvia Earle</i>	ASH002S	20	01 Nov–20 Nov	USH–USH	N/A	N/A	US\$24,695	N/A
2025	Spirit of Antarctica	<i>Greg Mortimer</i>	ANP174G	12	10 Nov–21 Nov	USH–USH	N/A	N/A	US\$14,895	US\$15,395
2025	Spirit of Antarctica	<i>Sylvia Earle</i>	ANP175S	12	19 Nov–30 Nov	USH–USH	N/A	N/A	US\$14,895	N/A
2025	Antarctica Active - NEW	<i>Greg Mortimer</i>	APD004G	15	20 Nov–04 Dec	USH–USH	N/A	N/A	US\$16,995	US\$17,495
2025	Across the Antarctic Circle	<i>Sylvia Earle</i>	ANC013S	13	29 Nov–11 Dec	USH–USH	N/A	N/A	US\$16,695	N/A
2025	Antarctica Active - NEW	<i>Greg Mortimer</i>	APD005G	15	03 Dec–17 Dec	USH–USH	N/A	N/A	US\$16,995	US\$17,495
2025	Spirit of Antarctica	<i>Sylvia Earle</i>	ANP176S	12	10 Dec–21 Dec	USH–USH	N/A	N/A	US\$16,195	N/A
2025	Across the Antarctic Circle (Christmas)	<i>Greg Mortimer</i>	ANC014G	13	16 Dec–28 Dec	USH–USH	N/A	N/A	US\$17,995	US\$18,595
25/26	Antarctica Complete (Christmas & New Year)	<i>Sylvia Earle</i>	ACO006S	23	20 Dec–11 Jan	USH–USH	N/A	N/A	US\$32,295	N/A
25/26	Falklands, South Georgia & Antarctic Peninsula (New Year)	<i>Greg Mortimer</i>	FSP007G	23	27 Dec–18 Jan	USH–USH	N/A	N/A	US\$32,295	US\$33,195
2026	South Georgia, Falklands & Antarctic Odyssey	<i>Sylvia Earle</i>	ASG096S	21	10 Jan–30 Jan	USH–USH	N/A	N/A	US\$29,795	N/A
2026	Antarctic Explorer Express	<i>Greg Mortimer</i>	ANE003G	9	17 Jan–25 Jan	USH–PUQ	N/A	N/A	US\$14,395	US\$14,795
2026	Antarctic Peninsula: Fly the Drake	<i>Greg Mortimer</i>	APF010G	12	23 Jan–03 Feb	PUQ–PUQ	N/A	N/A	US\$23,795	US\$24,495
2026	Across the Antarctic Circle	<i>Sylvia Earle</i>	ANC015S	13	29 Jan–10 Feb	USH–PUQ	N/A	N/A	US\$19,195	N/A
2026	Antarctic Explorer	<i>Greg Mortimer</i>	AEP051G	12	01 Feb–12 Feb	PUQ–USH	N/A	N/A	US\$18,695	US\$19,295
2026	Antarctic Peninsula: Fly the Drake	<i>Sylvia Earle</i>	APF011S	12	08 Feb–19 Feb	PUQ–PUQ	N/A	N/A	US\$23,795	N/A
2026	Wild Antarctica <i>featuring</i> the Weddell Sea	<i>Sylvia Earle</i>	ANW010S	13	17 Feb–01 Mar	PUQ–USH	N/A	N/A	US\$20,095	N/A
2026	Across the Antarctic Circle	<i>Greg Mortimer</i>	ANC016G	13	21 Feb–05 Mar	USH–USH	N/A	N/A	US\$17,795	US\$18,295
2026	South Georgia, Falklands & Antarctic Odyssey	<i>Sylvia Earle</i>	ASG097S	20	28 Feb–19 Mar	USH–PUQ	N/A	N/A	US\$29,395	N/A
2026	South Georgia & Antarctic Odyssey <i>featuring</i> the South Sandwich Islands	<i>Greg Mortimer</i>	SSI003G	24	04 Mar–27 Mar	USH–USH	N/A	N/A	US\$28,895	US\$29,795
2026	Falklands, South Georgia & Antarctic Peninsula	<i>Douglas Mawson</i>	FSP008D	22	11 Mar–01 Apr	USH–USH	US\$32,795	US\$35,995	US\$27,195	US\$27,995
2026	Antarctic Explorer	<i>Sylvia Earle</i>	AEP052S	12	17 Mar–28 Mar	PUQ - USH	N/A	N/A	US\$17,895	N/A

KEY: USH - Ushuaia, Argentina, PUQ - Punta Arenas, Chile

AURORA STATEROOM SUPERIOR	BALCONY STATEROOM C	BALCONY STATEROOM B	BALCONY STATEROOM A	BALCONY STATEROOM SUPERIOR	JUNIOR SUITE	CAPTAIN'S SUITE	OPTIONAL ACTIVITIES
N/A	US\$20,395	US\$20,995	US\$22,095	US\$23,795	US\$25,995	US\$32,595	Sea Kayaking - US\$1,330, Snorkelling - US\$675, Scuba Diving - US\$1,295, Paddling - US\$640
US\$14,695	N/A	US\$15,995	US\$16,795	US\$18,095	US\$19,795	US\$24,795	Sea Kayaking - US\$1,330, Snorkelling - US\$675, Paddling - US\$640
N/A	US\$15,995	US\$16,395	US\$17,295	US\$18,595	US\$20,295	US\$25,495	Sea Kayaking - US\$1,330, Snorkelling - US\$675, Scuba Diving - US\$1,295, Paddling - US\$640
US\$23,195	N/A	US\$25,195	US\$26,495	US\$28,495	US\$31,195	US\$39,095	Sea Kayaking - US\$1,745, Snorkelling - US\$835, Paddling - US\$640
N/A	US\$14,595	US\$14,995	US\$15,795	US\$16,895	US\$18,495	US\$23,195	Sea Kayaking - US\$1,330, Snorkelling - US\$675, Scuba Diving - US\$1,295, Paddling - US\$640
N/A	US\$28,495	US\$29,895	US\$32,195	US\$35,195	US\$44,195	US\$52,395	Sea Kayaking - US\$1,745, Ski/Snowboard Touring - US\$1,395, Snowshoeing - US\$440
US\$26,795	US\$27,595	US\$28,995	US\$31,195	US\$34,095	US\$42,795	US\$50,695	Sea Kayaking - US\$1,745, Shackleton's Crossing on Foot - US\$2,220
N/A	US\$16,695	US\$17,595	US\$18,895	US\$20,595	US\$25,895	US\$30,695	Sea Kayaking - US\$1,330, Snowshoeing - US\$370, Snorkelling - US\$675, Camping - US\$165
US\$16,295	US\$16,695	US\$17,595	US\$18,895	US\$20,595	US\$25,895	US\$30,695	Sea Kayaking - US\$1,330, Camping - US\$165, Snowshoeing - US\$370
N/A	US\$18,995	US\$19,995	US\$21,495	US\$23,495	US\$29,495	US\$34,895	Included - Snorkelling, Paddling, Snowshoeing, Camping
US\$18,095	US\$18,595	US\$19,595	US\$21,095	US\$22,995	US\$28,895	US\$34,295	Sea Kayaking - US\$1,330, Snowshoeing - US\$370
N/A	US\$18,995	US\$19,995	US\$21,495	US\$23,495	US\$29,495	US\$34,895	Included - Snorkelling, Paddling, Snowshoeing, Camping
US\$17,595	US\$18,095	US\$18,995	US\$20,395	US\$22,295	US\$27,995	US\$33,195	Sea Kayaking - US\$1,330, Camping - US\$165, Snowshoeing - US\$370, Alpine Trekking - US\$1,260
N/A	US\$20,195	US\$21,195	US\$22,795	US\$24,895	US\$31,295	US\$37,095	Sea Kayaking - US\$1,330, Snowshoeing - US\$370, Snorkelling - US\$675, Paddling - US\$640
US\$35,195	US\$36,095	US\$37,995	US\$40,795	US\$44,595	US\$55,995	US\$66,495	Sea Kayaking - US\$1,745, Snowshoeing - US\$440, Snorkelling - US\$835, Paddling - US\$640
N/A	US\$36,095	US\$37,995	US\$40,795	US\$44,595	US\$55,995	US\$66,395	Sea Kayaking - US\$1,745, Snowshoeing - US\$440, Snorkelling - US\$835, Paddling - US\$640
US\$32,395	US\$33,295	US\$34,995	US\$37,595	US\$41,095	US\$51,595	US\$61,195	Sea Kayaking - US\$1,745, Snorkelling - US\$835, Paddling - US\$640
N/A	US\$16,095	US\$16,995	US\$18,195	US\$19,895	US\$24,995	US\$29,595	Sea Kayaking - US\$1,030, Snorkelling - US\$515, Paddling - US\$480
N/A	US\$26,595	US\$27,995	US\$30,095	US\$32,895	US\$41,295	US\$48,895	Sea Kayaking - US\$1,330, Snorkelling - US\$675, Paddling - US\$640
US\$20,895	US\$21,395	US\$22,495	US\$24,195	US\$26,495	US\$33,195	US\$39,395	Sea Kayaking - US\$1,330, Snorkelling - US\$675, Paddling - US\$640
N/A	US\$20,895	US\$21,995	US\$23,595	US\$25,795	US\$32,395	US\$38,495	Sea Kayaking - US\$1,330, Snorkelling - US\$675, Paddling - US\$640
US\$25,895	US\$26,595	US\$27,995	US\$30,095	US\$32,895	US\$41,295	US\$48,995	Sea Kayaking - US\$1,330, Snorkelling - US\$675, Paddling - US\$640
US\$21,895	US\$22,495	US\$23,595	US\$25,395	US\$27,795	US\$34,895	US\$41,295	Sea Kayaking - US\$1,330, Snorkelling - US\$675, Paddling - US\$640
N/A	US\$19,895	US\$20,995	US\$22,495	US\$24,595	US\$30,895	US\$36,595	Sea Kayaking - US\$1,330, Snorkelling - US\$675, Scuba Diving - US\$1,295 Paddling - US\$640
US\$31,995	US\$32,795	US\$34,495	US\$37,095	US\$40,595	US\$50,895	US\$60,395	Sea Kayaking - US\$1,745, Snorkelling - US\$835, Scuba Diving - US\$1,295 Paddling - US\$640
N/A	US\$32,295	US\$33,995	US\$36,595	US\$39,995	US\$50,095	US\$59,495	Sea Kayaking - US\$1,745, Snorkelling - US\$835, Scuba Diving - US\$1,295 Paddling - US\$640
US\$29,595	US\$30,395	US\$31,995	US\$34,395	US\$37,595	US\$47,195	US\$55,995	Sea Kayaking - US\$1,745
US\$19,495	US\$19,995	US\$20,995	US\$22,595	US\$24,695	US\$30,995	US\$36,795	Sea Kayaking - US\$1,330, Snorkelling - US\$675, Scuba Diving - US\$1,295 Paddling - US\$640

Patagonia (USD)

— Patagonia, Southern Chile, Antarctic Peninsula

YEAR	VOYAGES	SHIP	CODE	DAYS	DATES	START-FINISH	AURORA STATEROOM SINGLE	AURORA STATEROOM SUPERIOR SINGLE	AURORA STATEROOM TRIPLE	AURORA STATEROOM TWIN
2025	Trails of Antarctica & Patagonia	<i>Greg Mortimer</i>	VTC094G	25	20 Nov–14 Dec	USH–PUQ	N/A	N/A	US\$21,895	US\$22,395
2026	Trails of Antarctica & Patagonia	<i>Sylvia Earle</i>	VTC095S	23	17 Feb–11 Mar	PUQ–PUQ	N/A	N/A	US\$24,795	N/A
2026	Antarctica & Patagonia Explorer	<i>Sylvia Earle</i>	APC001S	25	17 Mar–10 Apr	PUQ–PMC	N/A	N/A	US\$29,795	N/A
2026	Patagonia & Chilean Fjords	<i>Sylvia Earle</i>	PCF003S	15	27 Mar–10 Apr	USH–PMC	N/A	N/A	US\$13,595	N/A

KEY: USH - Ushuaia, Argentina, PUQ - Punta Arenas, Chile, PMC - Puerto Montt, Chile

Tasmania (GBP/EUR)

— Tasmania

YEAR	VOYAGES	SHIP	CODE	DAYS	DATES	START-FINISH	AURORA STATEROOM SINGLE	AURORA STATEROOM SUPERIOR SINGLE	AURORA STATEROOM TRIPLE	AURORA STATEROOM TWIN
2025	Coastal Tasmania: Untamed Wilderness	<i>Douglas Mawson</i>	TAS001D	11	01 Dec–11 Dec	HBA–HBA	£9,195/ €11,295	£9,995/ €12,395	£7,595/ €9,295	£7,795/ €9,595

KEY: HBA - Hobart, Australia

Patagonia Treks (USD)

YEAR	EXPEDITIONS	CODE	DAYS	DATES	START-FINISH	PRICE	CONNECTING VOYAGE
2024	Patagonia Discovery Trek	PTG81	10	17 Oct–26 Oct	PUQ–FTE	US\$5,545	ANP168G*
2024	Patagonia Discovery Trek	PTG82	10	27 Oct–05 Nov	FTE–FTE	US\$5,545	APD003G*
2024	Patagonia Discovery Trek	PTG83	10	14 Nov–23 Nov	FTE–FTE	US\$5,545	FSP005S^
2024	Patagonia Discovery Trek	PTG84	10	24 Nov–03 Dec	FTE–FTE	US\$5,545	ANP169S^
2024	Patagonia Discovery Trek	PTG85	10	10 Dec–19 Dec	FTE–FTE	US\$5,545	ASG092G^ / ANC010S*
2024	Patagonia Discovery Trek	PTG86	10	20 Dec–29 Dec	FTE–PUQ	US\$5,545	ANP171G^
2025	Patagonia Discovery Trek	PTG87	10	18 Jan–27 Jan	FTE–PUQ	US\$5,545	ANP172G^
2025	Torres del Paine Explorer	TOR21	10	28 Jan–06 Feb	PUQ–PUQ	US\$5,545	ANC011G^
2025	Patagonia Discovery Trek	PTG88	10	01 Feb–10 Feb	FTE–PUQ	US\$5,545	AEP046S^

AURORA STATEROOM SUPERIOR	BALCONY STATEROOM C	BALCONY STATEROOM B	BALCONY STATEROOM A	BALCONY STATEROOM SUPERIOR	JUNIOR SUITE	CAPTAIN'S SUITE	OPTIONAL ACTIVITIES
N/A	US\$23,795	US\$24,695	US\$26,195	US\$28,095	US\$33,795	US\$38,895	Included - Snorkelling, Paddling, Snowshoeing, Camping
US\$26,495	US\$27,095	US\$28,195	US\$29,895	US\$32,195	US\$38,895	US\$44,995	Sea Kayaking - US\$1,330, Snorkelling - US\$675, Paddling - US\$640
US\$32,395	US\$33,295	US\$34,995	US\$37,595	US\$41,195	US\$51,695	US\$61,395	Sea Kayaking - US\$1,745, Snorkelling - US\$675, Scuba Diving - US\$1,295, Paddling - US\$640
US\$14,795	US\$15,195	US\$15,995	US\$17,195	US\$18,795	US\$23,595	US\$27,995	Sea Kayaking - US\$980

AURORA STATEROOM SUPERIOR	BALCONY STATEROOM C	BALCONY STATEROOM B	BALCONY STATEROOM A	BALCONY STATEROOM SUPERIOR	JUNIOR SUITE	CAPTAIN'S SUITE	OPTIONAL ACTIVITIES
£8,295/ €10,195	£8,495/ €10,395	£8,895/ €10,995	£9,595/ €11,795	£10,495/ €12,895	£13,195/ €16,195	£15,595/ €19,195	N/A

Patagonia Treks (USD)

YEAR	EXPEDITIONS	CODE	DAYS	DATES	START-FINISH	PRICE	CONNECTING VOYAGE
2025	Torres del Paine Explorer	TOR22	10	03 Feb-12 Feb	PUQ-PUQ	US\$5,545	AEP048G*
2025	Patagonia Discovery Trek	PTG89	10	10 Feb-19 Feb	PUQ-FTE	US\$5,545	AEP049S*
2025	Patagonia Discovery Trek	PTG90	10	13 Feb-22 Feb	PUQ-FTE	US\$5,545	ANC012G*
2025	Patagonia Discovery Trek	PTG91	10	20 Feb-01 Mar	FTE-PUQ	US\$5,545	AEP050S*
2025	Torres del Paine Explorer	TOR23	10	03 Mar-12 Mar	PUQ-PUQ	US\$5,545	AEP049S^ / ANP173S*
2025	Patagonia Discovery Trek	PTG92	10	14 Mar-23 Mar	PUQ-FTE	US\$5,545	AEP050S^ / ANW009S*
2025	Patagonia Discovery Trek	PTG93	10	23 Nov - 02 Dec	FTE - FTE	US\$5,795	APD005G*
2025	Patagonia Discovery Trek	PTG94	10	05 Dec - 14 Dec	FTE - PUQ	US\$5,795	APD004G^
2026	Patagonia Discovery Trek	PTG95	10	02 Mar - 11 Mar	FTE - PUQ	US\$5,795	ANW010S^

KEY: FTE - El Calafate, Argentina; PUQ - Punta Arenas, Chile ^ Indicates voyage is before the trek. * Indicates voyage is after the trek. All trek departures are subject to minimum capacity.

Introduction

- (a) Aurora Travel Pty Ltd (ACN 139 766 911) ("AE Expeditions").
- (b) For the purpose of these Terms & Conditions, each passenger who agrees to be bound by the Terms & Conditions will be referred to as "you" or "your".
- (c) AE Expeditions offers an adventurous style of travel that can be complex and costly to arrange. This includes travelling to remote places that can be subject to unpredictable, volatile conditions and other factors (often outside of our control), which require flexibility and can involve adjustments to schedules and itineraries at short notice. AE Expeditions will always use reasonable endeavours to operate in accordance with an expedition's published itinerary, but we cannot guarantee them and they do not form part of your contract with us.
- (d) Please carefully read and ensure you understand the following Terms & Conditions as they set out the basis upon which we accept all bookings. The following are important terms that you should be particularly aware of:
- (i) Clause 1.1 (Price amendments)
 - (ii) Clauses 2.2 – 2.5 (Responsibility and Assumption of Risk)
 - (iii) Clause 5 (Booking Transfer or Cancellation by you)
 - (iv) Clauses 7 – 9 (Cancellations or variations by AE Expeditions)
 - (v) Clause 11 (Health Requirements)
 - (vi) Clause 12 (Mandatory Travel Insurance)
 - (vii) Clause 14 (Airlines, Ticketing and Ancillary Services)
- (e) If you decide to travel with AE Expeditions and make payment for an expedition, you do so on the understanding that you have accepted these Terms & Conditions, including amendments to the Terms & Conditions that may be made by AE Expeditions from time to time and shared with you. You should check AE Expeditions' website for the most updated terms and conditions.
- (f) In respect of any goods or services we may provide, certain statutory guarantees or warranties may apply for the benefit of consumers. The nature and application of these guarantees or warranties will depend on the relevant jurisdiction. Nothing in these Terms & Conditions affects your rights under the consumer law of the jurisdiction in which you reside, which for Australia, would be the Australian Consumer Law (ACL). Under the ACL, where we fail to provide services to you in accordance with these consumer guarantees, you may have a right to seek a remedy, including a refund.

1 Price and Validity

1.1 Expedition costs are based on ground costs, fuel prices, ship charter rates and airfares (as applicable) at time of printing. While we try our utmost not to increase our prices, this is sometimes outside our control. On that basis, we reserve the right to amend our prices in the instance of increases in our costs to deliver the expedition such as but not limited to airfares, fuel costs, government taxes and charges, exchange rate fluctuations, ground costs and ship charter rates. Any increase in price must be paid by you before your departure.

However, if this means that you have to pay an increase of more than 15% of the total price of your expedition, you will have the option of accepting the price increase and paying the requested amount, or cancelling and receiving a full refund of monies paid to us. Should you decide to cancel for this reason, you must exercise your right to do so within 14 days from the issue date on your new invoice.

1.2 In circumstances where these Term & Conditions stipulate that you may credit monies paid by you to AE Expeditions toward a future voyage:

- (a) the credit may only be used toward the cost of your ticket and not toward any other goods or services offered by AE Expeditions; and
- (b) the expedition the subject of the credit must depart within 24 months of the date of departure of the original expedition booked by you.

2 Responsibility and Assumption of Risk

2.1 Upon receipt by us of your booking form and once your Deposit (see clause 3.1) has been received, a binding contract between you and AE Expeditions is in place ("Contract"). These Terms & Conditions are an integral part of the Contract. If you list one or more other persons on the booking form, you agree that you will be personally responsible for all obligations ensuing from the Contract which concern you and the other persons booked.

2.2 Except to the extent that this waiver may be prohibited or restricted by the Competition & Consumer Act, Australian Consumer Law or other legislation that may exist from time to time in Australia, or in the event that AE Expeditions, its related bodies corporate, contractors, employees and agents, or any licensor or licensee, breached the law (including fraud), breached the contract, infringed third party rights (including property rights), was negligent or engaged in wilful misconduct, you hereby release AE Expeditions, its related bodies corporate, contractors, employees and agents, and any licensor or licensee from all claims and actions that you have, or may have at any time in the future, against them or any of them for personal injury, death, property damage or any other loss, damage or expense that you may suffer as a result of your participation in any trip organised with or in conjunction with AE Expeditions.

2.3 You are aware that your adventure trip, in addition to the dangers and inherent risks that may arise in the normal course with any adventure trip, has certain additional dangers and risks, some of which may include: the consequences flowing directly and indirectly from an epidemic, physical exertion for which you may not be prepared, extreme weather conditions that are subject to sudden and unexpected changes, remoteness from normal medical services, and evacuation difficulties if you are

disabled. By entering into the Contract, you agree:

- (a) to accept all the inherent risks of the proposed adventure trip and the possibility of personal injury, death, property damage, or loss;
- (b) to acknowledge that the enjoyment and excitement of adventure travel is derived in part from the inherent risks incurred by travel and activity beyond the accepted safety of life at home or work, and that these inherent risks contribute to such enjoyment and excitement, being a reason for your participation;
- (c) that if you suffer injury or illness, AE Expeditions can, at your cost, arrange medical treatment and emergency evacuation service, as AE Expeditions deems appropriate for your well-being; and
- (d) the acceptance of such risk extends both to on-board presence and activities as well as off-board.

2.4 Notwithstanding any other provisions of the Contract that may exist, you release AE Expeditions from any and all liability to you or anyone claiming through or under you by way of subrogation or otherwise, including by your insurer, for any loss or damage for which you are entitled to receive compensation under a travel and/or cancellations insurance policy.

2.5 Subject to clause 2.2, AE Expeditions will not be responsible or liable for loss, damage or robbery of travel documents, baggage or other possessions

2.6 In entering into the Contract, you are not relying on oral representations or statements by AE Expeditions or its staff or other agent or representative to enter into the Contract. In deciding to book an expedition with AE Expeditions, you should make your own enquiries as to the suitability of the expedition and all aspects of it and satisfy yourself, based upon those enquiries, that it is an expedition that you wish to undertake.

2.7 You confirm that you are over the age of 18 years and that you have read and understood these Terms & Conditions as they appear on AE Expeditions' website from time to time and agree that the Contract will be binding upon your heirs, next of kin, executors, administrators and successors.

3 Booking Confirmation and Payment Terms

3.1 In order to confirm your booking, you are required to complete a booking form and make a deposit payment of \$2,500 per person (in the booking currency) within 7 working days of booking ("Deposit"). For the avoidance of doubt, no booking can be confirmed until such time as the booking form and the Deposit are received by AE Expeditions.

3.2 In order to confirm your participation on an activity (for example, kayaking, diving, snowshoeing), a deposit of \$250 (in the booking currency) per person per activity is required. The activity deposit is in addition to the Deposit required to confirm your place on the expedition, and the deposit for the activity is only refundable if the activity is cancelled due to minimum numbers not being reached or the activity is cancelled by a third party.

3.3 In the event that AE Expeditions cancels an activity or trek due to minimum numbers not being met, or the activity or trek is cancelled by a third party, AE Expeditions will refund in full any payments made by you for that activity or trek unless you inform us that you wish for the amount to be credited towards the final balance of your expedition.

3.4 Final payment is due at least 90 days (or as otherwise stated by us in writing) prior to the departure date of the expedition (or the amended departure date of the expedition pursuant to clauses 8 or 9) and an invoice will be sent to you for this purpose.

3.5 Credit card payments are accepted. Merchant fees and bank surcharges may apply.

4 Child Policy

4.1 Bookings are open to people 8 years of age and over. Passengers under 18 years of age must be accompanied at all times by an adult throughout the expedition and cannot be left unsupervised at any time including during paid additional activities. A child remains the sole responsibility of the adult at all times.

4.2 Children between 8-17 years of age must pay the adult price of the expedition.

5 Booking Transfer or Cancellation by you

5.1 If you wish to cancel your expedition, we ask that you notify your Travel Agent or our expedition sales team immediately in writing. Cancellation will take effect upon receipt by AE Expeditions of your written notice.

5.2 If the cancellation is made more than 90 days prior to the expedition departure date, you will forfeit your Deposit paid by you to AE Expeditions. If cancellation is made less than 90 days prior to the expedition departure date, you will be liable to pay the full price of the expedition within 7 days of providing your notice of cancellation to AE Expeditions.

However, in either situation, AE Expeditions will consider any request by you to transfer the Deposit paid towards a deposit to a subsequent expedition. Whether or not AE Expeditions agrees to any such request will depend upon applicable circumstances, including availability and other factors. The decision as to whether or not to agree will be made by AE Expeditions at its absolute discretion. If AE Expeditions shall agree to such a request, you will be liable to pay a fee of \$500 per passenger (in the currency of your expedition) to cover administrative and associated costs and you will also be liable to pay any additional price for the subsequent expedition. The transfer of the Deposit is only valid on expeditions that depart within 24 months from the date of the original proposed departure date. Only one transfer of deposit to another expedition is permitted.

6 Special Requests or Requirements

6.1 AE Expeditions will use all reasonable endeavours to accommodate special requests from you, including special dietary requirements, but they cannot be guaranteed. You should advise AE Expeditions as soon as possible after booking of any such special requests or requirements, such that AE Expeditions can try and accommodate them. Likewise, you should notify us, as soon after booking as possible, of any special events.

6.2 AE Expeditions will use all reasonable endeavours to ensure that any cabin and cabin number selected by you will be made available to you during the course of the expedition.

However, due to a variety of circumstances, it is not always possible to achieve that. In the event that that cannot be achieved, AE Expeditions will use all reasonable endeavours to make available to you another cabin that is as similar to the cabin selected by you as circumstances permit. The exception to this applies to passengers booked in the Captain's Suites.

7 Cancellation by AE Expeditions – other than due to weather

7.1 Despite any other term in the Contract, AE Expeditions reserves the right to cancel any expedition prior to departure in which case any payment made by you will be refunded in full (subject to the express provisions below in relation to "Fly & Sail" and "Fly/Fly" voyages) and you will not be entitled to make any further claims related to such a cancellation, including but not limited to compensation or damages, for any loss, consequential or indirect damage, expenses, loss of time or inconvenience, loss of opportunity or loss of enjoyment which may result from such cancellation

7.2 AE Expeditions reserves the right to cancel an expedition, trek, or activity if the minimum number of participants is not reached. We will endeavour to make, as soon as practically possible, any decision to cancel an expedition, trek or activity, and we will notify you of that decision, as soon as we practically can. We will endeavour to identify for you another expedition, trek or activity similar to the one that is cancelled. If one is not available, you will be refunded in full any payment already received from you.

7.3 AE Expeditions reserves the right to not operate or cancel an activity or trek in the event of a cancellation by a third party. In accordance with clause 3.3, you will be refunded in full any payment already received from you.

8 Cancellation or variation due to weather

8.1 It may be necessary for AE Expeditions to cancel or vary an expedition as a result of adverse weather or ocean conditions. AE Expeditions will endeavour to ensure that any expedition takes place as close as reasonably practicable to the published expedition's schedules and itineraries but, at times, this may not be possible due to weather events beyond its control.

8.2 If AE Expeditions forms the reasonable view that weather or ocean conditions may render an expedition unsafe, unable to be completed or provided substantially as planned or would pose a material risk to passengers, staff, crew, vessels or equipment, AE Expeditions may cancel any expedition.

8.3 Subject to clauses 8.6 – 8.16, if AE Expeditions cancels an expedition under clause 8.2, you will be entitled to a credit to the value of the full price you have paid AE Expeditions for your voyage (including any Deposit), which can be used towards a future expedition in accordance with clause 1.2. AE Expeditions will not otherwise be liable for any compensation or damages, for any loss, consequential or indirect damages, expenses (including but not limited to international airfares, domestic airfares, accommodation, any additional services purchased, or change fees impacted by or as a result of the delay or cancellation), loss of time or inconvenience, loss of opportunity, loss of enjoyment or distress and disappointment, except as required by applicable laws.

8.4 If AE Expeditions forms the reasonable view that weather or ocean conditions may render the expedition unsafe, unable to be completed or provided substantially as planned, would pose a material risk to passengers, staff, crew, vessels or equipment, or that it is possible to make changes to avoid bad conditions or experience more favourable conditions, AE Expeditions may vary any aspect of the expedition itinerary with little or no advance notice. This may include changing any planned 'fly' leg of a voyage to a 'sail' leg (including during the 96 hour period specified in clauses 8.12, 8.13 and 8.16 below), cancelling landings, changing voyages paths to attempt to take advantage of good conditions or avoid bad conditions or not visiting some planned destinations, delaying the commencement of expeditions for limited periods or ending expeditions earlier or later than planned.

8.5 In the event of a variation under clause 8.4, AE Expeditions will not be liable for any compensation or damages, for any loss, consequential or indirect damages, expenses (including but not limited to international airfares, domestic airfares, accommodation, any additional services purchased, or change fees impacted by or as a result of the delay or cancellation), loss of time or inconvenience, loss of itinerary days, loss of opportunity, loss of enjoyment or distress and disappointment, except as required by applicable laws.

"Fly/Sail", "Fly/Fly" and "Sail/Fly" voyages

8.6 Any booking for a "Fly/Sail", "Fly/Fly" or "Sail/Fly" voyage is subject to the following specific Terms & Conditions.

8.7 A "Fly/Sail" voyage involves flying from Punta Arenas, Chile to King George Island, and then a voyage by ship from King George Island to specified destinations within Antarctica and from Antarctica, by ship to Ushuaia, Argentina.

8.8 A "Fly/Fly" voyage involves flying from Punta Arenas, Chile to King George Island, and then a voyage by ship from King George Island to specified destinations within Antarctica and then back by ship to King George Island and then flying from King George Island back to Punta Arenas, Chile.

8.9 A "Sail/Fly" voyage involves a voyage by ship from Ushuaia, Argentina to specified destinations within Antarctica and then by ship from Antarctica to King George Island

and then flying from King George Island to Punta Arenas, Chile.

8.10 Any "Fly/Sail", "Fly/Fly" or "Sail/Fly" voyage is deemed to commence at the starting point of the expedition as booked.

8.11 You acknowledge that the charter flights involved in "Fly/Sail", "Fly/Fly" or "Sail/Fly" voyages are inherently sensitive to weather conditions and that such conditions, and the ability of charter flights to fly as scheduled, is beyond AE Expeditions' control. Subject to clauses 8.12 – 8.16, clauses 8.1 – 8.5 apply in respect of charter flights.

8.12 If a charter flight from any starting point to the point of embarkation for a ship voyage is delayed due to adverse weather conditions, AE Expeditions will attempt, for a period of up to 96 hours from the proposed departure time of the charter flight, to arrange a later charter flight. We will attempt to do so at no extra charge to you, but if an additional charge does apply, you will be liable to pay that additional charge. At any stage in this 96 hour period AE Expeditions may vary the voyage in accordance with clause 8.4.

8.13 If it is not reasonably practicable for a later charter flight to be arranged for you, within 96 hours from the proposed departure time of the charter flight, your expedition will be deemed cancelled.

8.14 If your expedition is deemed cancelled under clause 8.13 or otherwise cancelled due to weather conditions affecting your charter flight, AE Expeditions will provide you with a credit, to the value of the full price you have paid AE Expeditions for your voyage (including the Deposit), which can be used towards a future voyage in accordance with clause 1.2. This clause 8 will otherwise apply. You will not be entitled to any refund of any amounts paid by you.

8.15 In the event that a charter flight is delayed, the Expedition Leader or another representative of AE Expeditions will provide updates to you, as they may be known, and will endeavour to provide information to make your stay as enjoyable as possible pending the ability of a charter flight to fly.

8.16 If a charter flight from King George Island to Punta Arenas, Chile is delayed, passengers already in Antarctica will remain on board the ship until the flight to Punta Arenas is authorised to depart. If it is not possible, due to weather conditions, for the flight to depart within 96 hours from intended departure time, the ship will transport you from King George Island to Puerto Williams or Ushuaia for disembarkation. Full board on the ship is included. This clause 8 will otherwise apply.

9 Variation of Itinerary

9.1 AE Expeditions will endeavour to ensure that any expedition takes place as close as reasonably practicable to the published expedition's schedules and itineraries. However, due to circumstances outside of our control, other than weather or ocean conditions (clause 8), including (non exhaustive) the direct or indirect consequence of a force majeure event (clause 10), safety, maritime law, compliance with government or official orders, guest emergencies, providing assistance to other vessels or unexpected mechanical or technical problems, AE Expeditions may need to vary any aspect of the expedition itinerary, including omitting any port(s), calling at additional port(s) or substituting another ship or port, with little or no advance notice. Normally, changes in the itinerary are to protect your interest and safety.

9.2 AE Expeditions does not guarantee its expedition itineraries and they do not form part of your contract with AE Expeditions.

9.3 Where it is necessary to vary an itinerary due to circumstances outside of our control other than under clause 8, AE Expeditions will attempt to offer a revised itinerary as close as reasonably practicable to the published itinerary. Subject to clauses 9.4 – 9.6 with respect to revised dates of departure, you will have no right to a refund in connection with the revised itinerary and AE Expeditions will have no obligation to you or be liable for any compensation or damages, for any loss, consequential or indirect damages, expenses, loss of time or inconvenience, loss of opportunity or loss of enjoyment in respect of such changes, except as required by applicable laws.

9.4 In circumstances where AE Expeditions varies the date of departure of the expedition due to circumstances outside of our control, other than under clause 8, the amended date of departure will be advised to you in writing by AE Expeditions and may be at any time within 18 months of the original departure date.

9.5 Where an expedition departure date is varied by AE Expeditions pursuant to clause 9.4, you may:

- (a) accept the terms of the amended departure date advised to you pursuant to clause 9.4;
- (b) elect by written notice to AE Expeditions to assign the benefit of the amended expedition itinerary advised to you pursuant to clause 9.4 to any of your family members; or
- (c) credit the value of all payments made by you to AE Expeditions toward the value of a future expedition in accordance with clause 1.2; or

9.6 Should:

- (a) you or a family member not wish to participate in the expedition on the revised date as advised to you by AE Expeditions pursuant to clause 9.4; or
- (b) you not wish to assume the benefit of a credit for a future voyage pursuant to clause 9.5
- (c), you may cancel your expedition in accordance with clause 5.

AE Expeditions will not otherwise be liable for compensation or damages, for any loss, consequential or indirect damage, expenses, loss of time or inconvenience, loss of opportunity or loss of enjoyment which may result from such variation, unless otherwise required by applicable laws.

9.7 To minimise the effects of tourism on the pristine environments in Antarctica and

the Arctic, IAATO & AECO restrict shore landings to a maximum of 100 people at any given time. In the event that more than 100 expeditioners wish to go ashore at any given time, AE Expeditions reserves the right to manage landings in accordance with regulations established by governing authorities.

10 Force Majeure

10.1 AE Expeditions will not be responsible for the performance of the Contract if prevented or delayed by acts of God, epidemic (together with events naturally arising from an epidemic), government action, strikes, or other industrial relations matters, accidents, weather, traffic, airport conditions, lack of performance by third party suppliers, or other causes beyond their control (Force Majeure event).

10.2 In circumstances of a Force Majeure event as defined in clause 10.1, AE Expeditions may, at its absolute discretion:

- (a) cancel the expedition in accordance with clauses 7 or 8;
- (b) vary the expedition itinerary in accordance with clauses 8 or 9; or
- (c) take any other action that AE Expeditions deems reasonably necessary to minimise the risk to passengers, staff, crew, vessels and equipment, and provide the expedition in the manner AE Expeditions deems appropriate in the circumstances.

11 Health, Required Fitness Levels, Trip Grades, Age Limits + Compulsory Medical Assessments

11.1 It is your responsibility to advise AE Expeditions of any pre-existing medical conditions and/or disability that might reasonably be expected to:

- (a) increase your risk of requiring medical attention during the voyage,
- (b) increase your risk of suffering medical or health complications or symptoms during the voyage, or increase the seriousness of such medical or health complications or symptoms; or
- (c) affect your safety, or
- (d) affect the normal conduct of an expedition of the type that you will be booking or negatively impact other expedition members, staff or crew.

11.2 If you are not sure whether a medical condition of disability is relevant under clause

11.1, it is your responsibility to consult with a legally qualified medical practitioner ("Doctor") and obtain medical advice on this. In providing its services, AE Expeditions is relying upon you having provided the information in clause 11.1 above as well as you consulting with your Doctor to confirm your suitability to travel at all relevant times. For the avoidance of doubt, your obligation under clause 11.1 is a continuing one and is in place at all relevant times, not just at the time you complete relevant medical forms or make your booking.

11.3 In addition to the continuing disclosure in 11.1, you will be required to provide to AE Expeditions medical assessment information under the following process:

- (a) AE Expeditions will provide a medical self-assessment form to you between 4 and 6 months prior to the departure date of the expedition. You must complete and return this medical self-assessment form by at least 3 months prior to departure. If you book within 3 months prior to the departure date of the expedition, you must complete and return this assessment as soon as practically possible and a maximum 20 days prior to departure.
- (b) After receiving your medical self-assessment form, AE Expeditions may require you to obtain a medical certificate from a Doctor certifying that you are fit to undertake the voyage.
- (c) You must return any medical certificate within 2 months prior to the departure date of the expedition, or if you are requested to provide the form within 2 months prior to departure, as soon as practically possible and a maximum of 10 days from booking.
- (d) If you fail to return the completed medical self-assessment form or the medical certificate within the timeframes specified above AE Expeditions will be entitled to cancel your booking in which case you will be entitled to a refund of all amounts paid to AE Expeditions, less your Deposit and you will not be entitled to any further compensation (including for costs or expenses).

11.4 It is your responsibility to provide full and accurate information in your medical self-assessment form. AE Expeditions will rely upon this information. AE Expeditions will not be liable to you for any losses to the extent that they are caused by your failure to provide full and accurate information in your medical self-assessment form, or if you were otherwise not appropriately self or medically assessed as to your ability to travel, and would otherwise have been avoided.

11.5 It is your responsibility to provide full and accurate information to your Doctor when obtaining the medical certificate under this clause 11. AE Expeditions will rely upon the medical certificate under clause 11.3 and your self assessment and disclosure under clauses 11.1 and 11.2. AE Expeditions will not be liable to you for any losses to the extent they are caused by your failure to provide full and accurate information to your Doctor or in your medical assessment form, and would otherwise have been avoided.

11.6 Should your medical condition change after submitting the medical self-assessment form or the medical certificate referred to in this clause 11, it is your responsibility to advise AE Expeditions within 48 hours after you become aware of such a change.

11.7 If AE Expeditions becomes aware or forms the view on a reasonable basis at any stage that you have not provided full and accurate information in your medical self-assessment form or to your Doctor when obtaining your medical certificate, then AE Expeditions is entitled to cancel your booking in which case you will be entitled to a refund of all amounts paid to AE Expeditions less any Deposit paid and you will not be entitled to any further compensation (including for costs or expenses).

11.8 If AE Expeditions forms the view on a reasonable basis at any stage that your

medical condition or disability might reasonably be expected to:

- (a) increase your risk of requiring medical attention during the voyage,
- (b) increase your risk of suffering medical or health complications or symptoms during the voyage, or increase the seriousness of such medical or health complications or symptoms; or
- (c) affect your safety; or
- (d) materially affect the conduct of an expedition of the type that you will be booking and negatively impact other expedition members, staff or crew,

then AE Expeditions is entitled to:

- (e) inform you of the reasonable steps it considers are required to eliminate the factors above, and require you to pay for any associated costs; or
- (f) if it forms the view that reasonable steps are not available to eliminate the factors above, or you do not agree to put such steps into place, cancel your booking in which case you will be entitled to a refund of all amounts paid to AE Expeditions less any Deposit paid and you will not be entitled to any further compensation (including for costs or expenses).

11.9 Should you be pregnant, for your safety and the safety of your unborn child, AE Expeditions does not recommend that you join an expedition. However, if you discover that you are pregnant prior to the commencement of an expedition and wish to participate irrespective of our advice against travelling, you must be 16 weeks or less into your pregnancy at the completion of the voyage and you must have clearance from a registered Obstetrician prior to departing your country of residence. Your travel insurance must cover pregnancy-related complications arising from adventure-based activities. In any event, AE Expeditions reserves the right cancel your booking under clause 11.7.

12 Mandatory Travel Insurance

12.1 Due to the adventurous style of travel offered by AE Expeditions and the remoteness of the areas in which we travel, it is a condition of travel with AE Expeditions that all passengers are covered by comprehensive travel insurance prior to departure, and that they maintain such insurance for the duration of the expedition.

12.2 Passengers travelling with AE Expeditions are required to be covered by a reputable travel insurance policy that includes baggage loss, cancellation & curtailment of holiday, medical, accident and repatriation/emergency evacuation coverage worth at least \$250,000 USD and otherwise on terms that are sufficient to indemnify you. We travel to remote regions of the world and we recommend that the insurance policy's repatriation/emergency evacuation benefit be higher than minimum and cover you for remote or Polar Evacuation should it be required. In the case of a medical issue arising during the expedition, either on board or on shore, which results in costs for medical treatment, repatriation, evacuation, use of aircraft, etc, the responsibility for payment of these costs and expenses belongs solely to the passenger. Please ensure that such eventualities are covered by your travel insurance policy. In any case, if you are not covered by a travel insurance policy, the responsibility remains with the passenger and AE Expeditions specifically declines any responsibility whatsoever, including in circumstances where AE Expeditions or a related body corporate of AE Expeditions arranges a travel insurance policy on your behalf.

12.3 Your insurance details must be supplied to us prior to final payment and if you fail to provide the requested insurance information at the time requested, we reserve the right to cancel your booking.

12.4 In that event that you do not produce confirmation of travel insurance to AE Expeditions pursuant to clause 12.3 and your booking is subsequently cancelled by AE Expeditions, you will remain liable to pay any amounts that are due and payable in accordance with these Terms & Conditions.

13 Personal Data, Visas, Health Requirements

13.1 You are responsible for ensuring that all personal information provided by you to make a booking is correct. AE Expeditions will not be liable for any incorrectly issued vouchers or tickets as a result of incorrect or incomplete information provided by you. Any name or spelling changes made after booking confirmation may result in supplier-imposed fees which will be at your sole cost and expense. Please provide us with a scanned copy of your passport at the time of reservation.

13.2 You are responsible for all immigration, passport, visa, health, quarantine and customs laws, regulations, orders, demands or other requirements of countries proposed to be visited or transited. You should check the requirements of those countries with their embassies or consulates or other authorities.

13.3 Visas (including transit visas) and Reciprocity fees (paid prior to departure) are the passengers' responsibility. For more information, please refer to www.dfat.gov.au or www.smarttraveller.gov.au (for Australian passport holders). Passengers from countries other than Australia should refer to their local government websites. You need to ensure that you have at least 6 months validity on your passport from the date of your return to your home country.

13.4 It is your responsibility to ensure that you are aware of any health requirements for your travel destinations as vaccinations may be required for the countries you visit. You need to contact your local Doctor or a travel Doctor who will advise you of these requirements. Please note that vaccinations may be recommended some period in advance of travelling.

14 Airfares, Ticketing and Ancillary Services

14.1 All flight bookings are subject to the relevant carrier's conditions of carriage. Cancellation and refund policies associated with airfares vary according to airfare Terms & Conditions and the relevant carrier's conditions of carriage. AE Expeditions sells airfares that have strict conditions when it comes to amendments, changes, and

cancellations – many of which are non-changeable and non-refundable after the ticket has been issued. Please ask your travel agent about the fare conditions at the time of booking. Once you have departed your home country, we recommend you contact your travel agent or airline directly to make any changes to your ticketed flight bookings.

14.2 Any bookings for extension packages and additional services ("Ancillary Services") are subject to the relevant third party supplier or operators' conditions of booking, which do not form part of your Contract with AE Expeditions. Cancellation, amendment and refund policies associated with these services vary. Please ask your travel agent about the conditions of booking for any applicable Ancillary Services, including any amendment or cancellation policy, at the time of booking.

14.3 We may receive fees, commissions, gifts or financial incentives from third parties under this contract.

15 Authority of the Expedition Leader

15.1 At all times, the decision of the AE Expeditions' Leader or representative will be final on all matters likely to affect the safety and well-being of expedition members, the well-being of communities and wildlife we visit, and the conduct of the expedition. This includes any decision that the AE Expeditions' Leader may make about the passengers' ongoing participation in the expedition or certain activities that comprise part of the expedition. If the passenger fails to comply with a decision made by the AE Expeditions' Leader, or interferes with the well-being of the group, the AE Expeditions' Leader reserves the right to terminate your participation in the expedition and to require you to leave the expedition immediately, with no right of refund and AE Expeditions will not be liable for any compensation, costs, damages or losses arising from such termination.

16 Photographic & Filming Consent and Release, Privacy and Data Protection

16.1 As a passenger travelling with AE Expeditions, you extend permission to AE Expeditions to take your photograph or film you during the expedition, and you release all rights over those images or footage without consideration. You understand and consent that AE Expeditions may use any likeness taken of you, any video footage and/or your comments for future publicity in any media and promotional material. You waive any right to privacy or copyright in respect thereof.

16.2 Any passenger who does not wish to be photographed or filmed must advise AE Expeditions in writing prior to expedition commencement.

16.3 In order for us to process your booking and provide a service to you, you are required to provide us with your personal information, which we may need to provide to service providers, as well as to customs and immigration authorities. Some of the persons to whom we provide your personal information are located overseas, including in countries that may not provide the same level of protection of personal information as required by Australian law. By making a booking, you give us your consent to use and disclose your personal information in the manner described in this clause.

16.4 We may also use your first name for marketing purposes, unless you tell us in writing prior to expedition commencement that you do not want us to do so. To the extent applicable, the provisions referred to in clause 21 of these Terms & Conditions shall apply.

16.5 Any photographs or video footage provided by any passenger to AE Expeditions for use in the voyage log/photo slideshow may be used by AE Expeditions for marketing purposes and showcased on the website in the voyage log/video section, unless advised otherwise by the passenger.

17 Feedback

17.1 If you have any complaints about your trip, you should make them known at the earliest opportunity to the AE Expeditions Leader or an AE Expeditions representative, who will take such action as he or she considers to be appropriate in the circumstances. If at the end of the expedition you feel that your complaint has not been properly dealt with, please notify us in writing either directly or through your travel agent within 30 days of the end of your trip. AE Expeditions reserves its rights to address any such complaints in such manner as it thinks fit.

18 Travel Agent Bookings

18.1 AE Expeditions acknowledges that you (the passenger) may utilise a travel agent to book your arrangements with AE Expeditions and we shall not be liable for any representations made by the travel agent. You (the passenger) understand and acknowledge that it is your responsibility to read, understand, and accept our Terms & Conditions at the time of providing your booking form and Deposit. Any reservation made with AE Expeditions either directly or through a travel agent constitutes a binding agreement signifying your acceptance of, and your agreement to, follow and be bound by these Terms & Conditions. It is the responsibility of the passenger to complete the booking form and personal information form accurately. Any flights or pre/post land arrangements not booked through AE Expeditions or any of its authorised agents do not form a part of this agreement and are subject to their own Terms & Conditions to which AE Expeditions are not party. Your travel agent will have their own booking conditions (in addition to ours) which do not form a part of your Contract with AE Expeditions.

19 Ship Images, Map, Voyage Itineraries

19.1 Images and videos including those in our brochures and on our website may be artists' impressions and the final interior design of cabins, suites, and public areas of any ships are subject to change.

19.2 The deck plan, suite sizes, images, and layout, and inclusions in our brochures and on our website may vary and be subject to change. They may not be drawn to scale and are indicative representations only. Suite and balcony sizes within each category may vary slightly depending on their location on each deck.

19.3 Maps and/or voyage itineraries contained in our brochures and on our website are a guide. Whilst every effort will be made to follow the itinerary described, in the event of political problems or natural disturbances or other unforeseen circumstances, we may act in accordance with clauses 8 or 9 as applicable and substitute an alternative itinerary for that section of the expedition. Whilst unlikely, it is an inherent consequence of expeditionary travel in remote and lesser-visited areas.

20 Jurisdiction and Law

20.1 All disputes and claims arising out of or in connection with this Agreement are governed by the laws applicable in the State of New South Wales, Australia. By acquiring products and services from AE Expeditions, you consent and submit to the exclusive jurisdiction to the Courts of New South Wales and the Commonwealth of Australia, as may be appropriate.

21 Data Protection

21.1 Definitions

"Data Protection Law": means all applicable data protection and privacy laws and regulations including, but not limited to, the Regulation (EU) 2016/679 of the European Parliament and of the Council of 27 April 2016 on the protection of natural persons with regard to the processing of personal data and the transfer of such data ("GDPR").

"Data": means all personal data collected, generated, used, stored, transferred or otherwise processed by AE Expeditions in connection with the Contract.

"Losses": means all losses, costs, charges, expenses, liabilities, claims, actions, proceedings, fines, penalties, damages and adverse judgments, including attorneys' fees.

21.2 Each party shall:

21.2.1 comply fully with its obligations under Data Protection Law;

21.2.2 appoint a point of contact for data protection matters and provide the other party with contact details for the same upon request;

21.2.3 ensure that its privacy notices are clear and provide sufficient information to customers for them to understand which of their Data shall be processed and/or shared with the other party and/or other party's authorised sub-contractors in connection with their booking and the purposes for the Data sharing;

21.2.4 ensure that all Data that is shared with the other party is collected, processed and transferred in accordance with Data Protection Law; and

21.2.5 implement, maintain and, at all times operate adequate and appropriate technical and organisational measures to (i) protect the security, confidentiality, integrity and availability of the Data, and (ii) protect against unauthorised or unlawful processing of the Data and accidental loss, destruction or the making vulnerable of, or damage to, the Data.

21.3 Sub-processors. In the event that a party appoints a sub-processor in respect of any of its Data processing activities then such party shall ensure that, prior to any processing of Data by the sub-processor, it enters into an agreement with the sub-processor on terms that comply with the requirements of Data Protection Law. Each party shall remain fully responsible for the acts, omissions and defaults of its sub-processor as if those were the acts, omissions and defaults of such party.

21.4 Notification of a Data Incident.

21.4.1 If a party receives any complaint, notice, request or communication which relates directly or indirectly to its processing of Data it shall immediately notify the other party in writing and shall provide full cooperation and assistance in relation to the same.

21.4.2 If a party discovers or suspects:

21.4.2.1 any unauthorised or unlawful access, processing, use or destruction of any Data;

21.4.2.2 any Data is disclosed or accessed in breach of Data Protection Law; or

21.4.2.3 any loss, theft, damage, corruption or misappropriation by any means of any Data or media, materials, records, or information containing any Data; and/or

21.4.2.4 any other security incident affecting the Data;

(each "Data Incident" described above), then it must notify the other party in writing no later than 48 hours after discovery of the Data Incident and provide written details of the nature of the Data Incident including, the categories and approximate numbers of data subjects concerned and the categories and approximate number of personal data records concerned, the likely consequences of the Data Incident, and the measures taken or proposed to be taken to address the Data Incident including measures to mitigate possible adverse effects for data subjects.

21.4.3 Each party shall, where relevant, provide full cooperation, information and assistance to other party in relation to any Data Incident in accordance with Data Protection Law and the other party's reasonable instructions.

21.5 Change in Law. In the event of any change in Data Protection Law, each party shall take such steps (including agreeing to additional obligations or executing additional documents) as may be required by the other party in order to ensure continued compliance with Data Protection Law.

21.6 Indemnity. The Passenger shall indemnify and hold AE Expeditions, including its associated companies or businesses, its servants and agents, harmless against all losses that AE Expeditions may suffer, sustain or incur as a result of any breach by the Passenger or by its sub-processor of the provisions of this clause or its obligations hereunder.





For more information and to book, contact your preferred travel advisor or AE Expeditions:



Trogerstr. 40
81675 München
Tel.089/472820
www.ssstravel.de